

# INSTRUCTIONS

## GM Metric Calipers/ Mustang II 5 Lug Rotors to Early '49-'54 Chevy Spindles

**910-31955**

Complete kit 5 on 4.5 BC

**910-31956**

Complete kit 5 on 4.75 BC

**916-31950**

Bracket kit only

©Speedway Motors, Inc. May 2011

### ***THESE KITS REQUIRE SPINDLE MODIFICATION!***

### **PLEASE READ INSTRUCTIONS COMPLETELY BEFORE STARTING YOUR INSTALLATION!**

This kit installs '74-'78 Mustang II or '74-'80 Pinto/Bobcat rotors and '78-88 GM metric calipers on modified '49-'54 Chevy passenger car spindles. You can purchase spindles already modified from Speedway and eliminate having to find spindles and having them machined or you can send your OEM spindles to Speedway and we will do all the machine work for you.

**916-32100 NEW '49-'54 Chevy modified forged steel spindles**

**916-32101 machining of your '49-'54 Chevy spindles**

**NOTE:** This brake kit is designed to be used on street rod tube or I-beam front axles only, like those commonly used on Model T and Model A to 1936 Ford front ends. This kit will not work with stock steering arms and is not designed to be installed on stock 1949-54 Chevy vehicle front ends.

### Parts List

Index No.	Description	Part Number	Quantity
*	Hardware kit	916-31950-2	1
1	Bearing adapter	910-09300	2
2 *	Caliper brackets	916-31950-1	2
3	7/16"-20 x 1 3/4" GR 8 hex bolt	in hardware kit	2
4	7/16"-20 x 2" GR 8 hex bolt	in hardware kit	2
5	7/16"-20 locking nuts	in hardware kit	4
6 & 7	Inner bearing cup/cone	912-TS6	2
8	Seal	912-S18565	2
9	Mustang II rotor 4 1/2" BP	910-31001	2
9	Mustang II rotor 4 3/4" BP	910-31002	2
10	Outer bearing cup	912-TLM19910	2
11	Outer bearing cone	912-TLM11949	2
**	Spindle nut kit	910-616005	1
12	Spindle washer	in hardware kit	2
13	Spindle nut	in spindle nut kit	2
14	Cotter pin	in spindle nut kit	2
15 **	Dust caps (pr)	910-31071	1
16	Brake pads (set)	919-3381	1
17	G.M. metric caliper (left)	910-31045-L	1
17	G.M. metric caliper (right)	910-31045-R	1
18	Caliper bolts	835-2300542	4
19**	'49-'54 Chevy spindle (pr)	910-32100	1
<b>Other parts needed:</b>			
	16" Stainless steel brake line kit (7/16"-20 thread for Speedway calipers)	617-8562	1
	16" Stainless steel brake line kit (10mm-1.5 thread for OEM calipers)	617-8561	1

\* Bracket kit parts only

\*\* Not included in kit

**BRAKE INSTALLATION ALERT:** The selection and installation of brake components should only be done by personnel experienced in the proper installation and operation of braking systems. The installer must use his/her own discretion to determine the suitability of the brake components and brake kits for every particular application.

Speedway Motors, Inc. makes no warranties, either expressed or implied, including any warranty of merchantability or fitness for a particular purpose, other than those contained in its current catalog or website with respect to the goods identified on the face of the invoice. There is no warranty expressed or implied as to whether the goods sold hereby will protect the purchaser or ultimate user of such goods from injury or death.

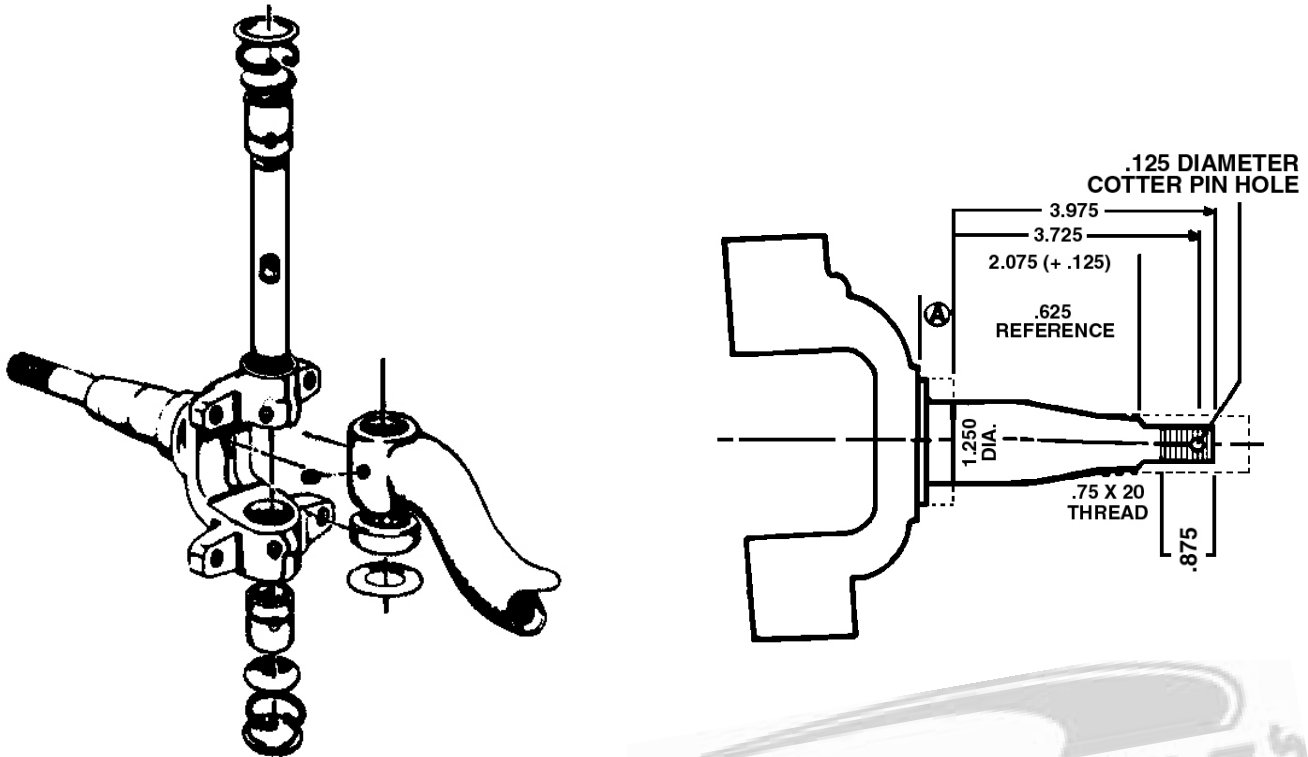

#### INSTRUCTIONS FOR MACHINING YOUR OEM SPINDLES - SPINDLES PURCHASED FROM SPEEDWAY MOTORS, INC. COME ALREADY MODIFIED AND DO NOT REQUIRE ANY MACHINING.

1. Using the parts list supplied, double check that you have received all the parts in the kit. If there are any missing parts, please contact our customer service department.
2. Acquire necessary '49-'54 Chevy passenger spindles. Check to make sure that they are not cracked or damaged and that the spindle snout is not bent.
3. Take the Chevy spindle and slide the spacer/seal race on the spindle. Check that the spindle face is even and free from excessive wear and damage.
4. Weld the spacer seal race in place at location "A". Eliminate all excess weld. Use tig welding to ensure a clean, precision weld if possible. Make sure the seal/race remains smooth and clean.
5. Place the spindle in the lathe and mount between centers.
6. Turn the spindle inner bearing race to 1.250" diameter as shown in drawing.
7. Turn the spindle outer bearing race down to .750" as shown in the drawing.
8. Remove the spindle and check bearing fit. Thread with a 3/4"-20 die per drawing. Cut key way to accommodate washer
9. Cut spindle length down to 3.975" as shown in drawing.

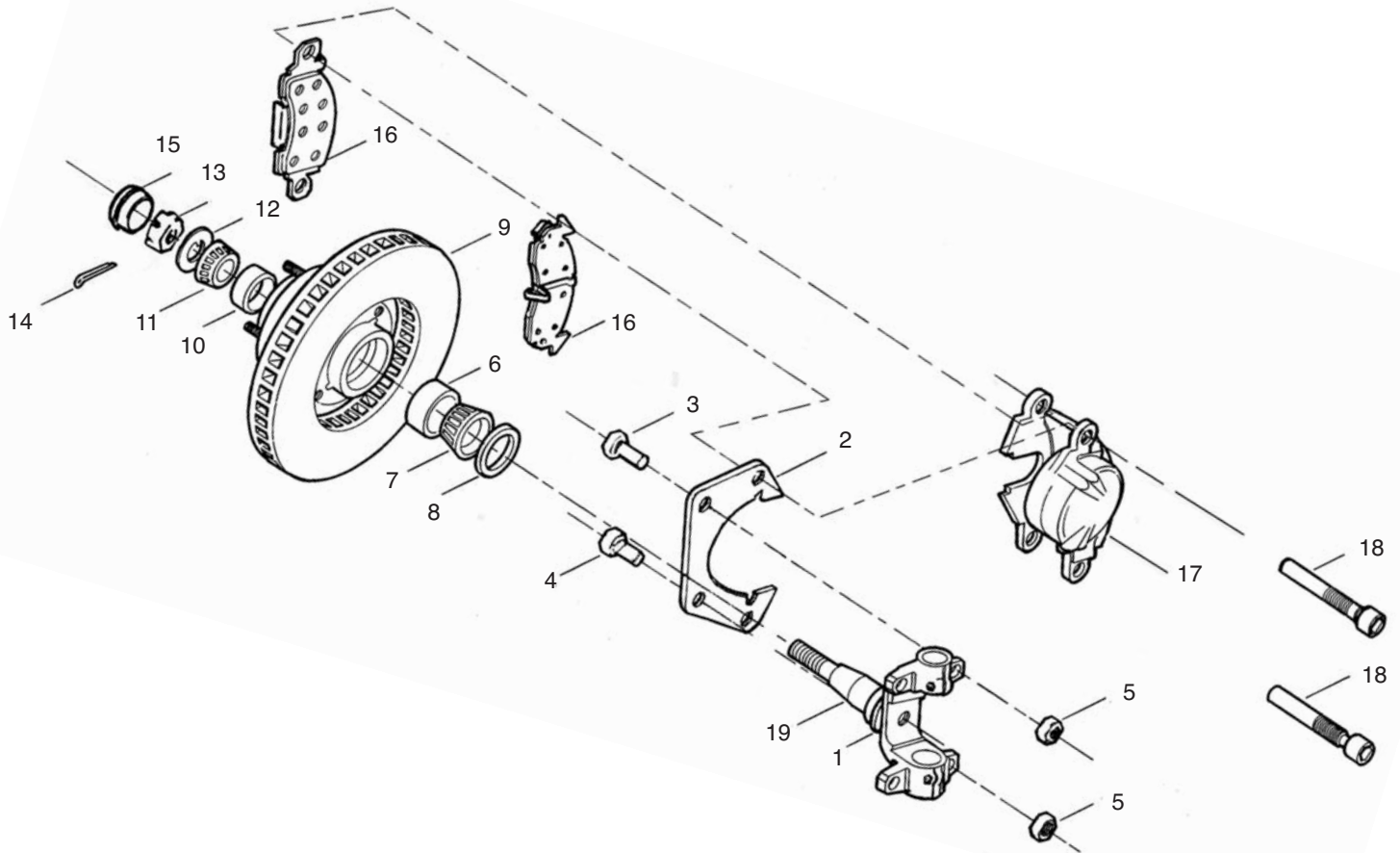

## **BRAKE KIT INSTALLATION:**

10. Remove the stock Mustang II inner and outer bearing races from the rotors and replace them with the inner bearing races (#6) and outer race (#10) supplied. **NOTE:** the stock bearing races that came in the rotor will not work in this kit. They must be replaced with the bearing races supplied. Make sure they are fully seated.
11. Install the inner bearing (#7), rotor (#9), outer bearing (#11), spindle washer (#12), and spindle nut (#13). Do not pack the bearings at this time.
12. Adjust the bearing preload as normal. If cotter pin does not line up, mark spindle for location of cotter pin. Disassemble and drill a 5/32" hole in the spindle for cotter pin. Thoroughly clean pieces to remove any metal shavings.
13. Assemble the spindles onto the axle.
14. The caliper brackets can be installed behind or in front of the axle depending on your steering arm location. The left and right caliper brackets are identical. The end of the bracket that has two mounting holes right next to each other goes down. Double check the caliper bracket orientation. If the brackets are installed upside down, the brake line boss on the caliper hits the spindle. Install the caliper brackets (#2) on to the spindle (#19) on the wheel side of the spindle using the 7/16"-20x1 3/4" bolts (#3) and 7/16"-20 locking nuts (#5) supplied. Install the bolts from the bracket side. The longer 7/16"-20x2" bolts (#4) are used where the steering arms mount. Torque the bolts to 25-37 ft. lbs. making sure you use loctite on the threads. **NOTE:** The caliper brackets may need some grinding to clear the axle bosses. Do not grind any more than required for clearance. Some applications may require longer bolts for the steering/tie rod arms since they now have to bolt through the caliper brackets too.

15. Pack and install the inner bearings (#7) with fresh disc brake bearing grease and install the grease seals (#8). Seals must be installed straight. A seal installation tool works well for this.
16. Install the rotor (#9) onto the spindle (#19), pack and install the outer bearing (#11). Install the spindle washer (#12) onto the spindle followed by the spindle nut (#13). Adjust the bearing preload as normal. Install the cotter pin (#14) and dust cap (#15).
17. Install the brake pads (#17) into the calipers (#18) and install the calipers on to the mounting brackets (#2) with the bleeders pointing up. Only use the correct GM mounting bolts (#19). **NOTE:** Some GM metric calipers have a small tab cast into the body that will interfere with the caliper brackets. This can be easily ground for clearance.
18. Install new brake lines making sure you check that the lines have clearance through the entire suspension travel and turning radius. Bleed the system as normal.
19. Before operating the vehicle, test the brakes under controlled conditions. Make several stops in a safe area from low speeds and gradually work up to operating speeds.

## SPEEDWAY'S BOLT ON STEERING ARMS WORK WELL ON THIS BRAKE KIT

916-32031 '49-'54 Chevy, plain steering arms

916-32030 '49'54 Chevy, chrome steering arms

# IMPORTANT

**DISCLAIMER** In an effort to offer our customers the low prices, quick service and great value, Speedway Motors reserves the right to change suppliers, specifications, colors, prices, materials. Each of the previous items is subject to change without notice. Speedway is not responsible for any typographical errors or misinterpretations. Quantities are limited on some items.

**WARRANTY DISCLAIMER** The purchaser understands and recognizes that racing parts, specialized street rod equipment, and all parts and services sold by Speedway Motors, Inc. are exposed to many and varied conditions due to the manner in which they are installed and used. Speedway Motors, Inc. makes no warranties, either express or implied, including any warranty of merchantability or fitness for a particular purpose other than those contained in its current catalog with respect to the goods identified on the face of the invoice. There is no warranty expressed or implied as to whether the goods sold hereby will protect purchaser or ultimate user of such goods from injury or death. Speedway Motors assumes no liability after this period.

**DAMAGE CLAIMS** Always inspect your package upon delivery. Inspect all packages in the presence of the delivery driver. The driver must note any damage. Ask the driver the Carrier's procedures for handling damage claims. You must hold the original box, packing material and damaged merchandise for inspection or the carrier will not honor the claim. Notify Speedway Motors customer service department for instructions on returning damaged goods. Speedway is not responsible if no notification is given within 5 days of receipt.

**SHORTAGES** Always check the contents of your delivery to insure all the parts that you ordered were received. Please read the invoice. Double check all packing materials, small items may be wrapped inside with these products. Shortages may occur from damage to the box, so save all packing materials. Inspect the box for holes that would allow parts to fall out. If you are missing any item(s) be sure to check your invoice for back orders or canceled items before calling the customer service department. If Speedway has to split a shipment into multiple boxes, packages may be delivered on different days. You need to contact the customer service department within 5 days of delivery to assure the prompt replacement. Speedway Motors assumes no liability after this period.

**REFUSALS** All refused COD customers will be billed a 15% restocking charge plus freight to and from the destination! If you have questions please contact Speedway's customer service department.

**WARRANTY CLAIMS** If an item has a manufacturer's warranty as being free from defects we will exchange only. If the item has been used and you are requesting warranty work, this may take up to 30 days as warranty work is done by the manufacturer NOT Speedway Motors. If you have any questions please contact customer service.

**RETURNS** Speedway wants you to be satisfied with your purchase. If within 30 days after you receive your shipment you are not satisfied, you may return the item for refund or exchange. All exchanged or returned merchandise must be in original factory condition with no modifications or alterations. Returned merchandise must include all packaging materials, warranty cards, manuals, and accessories. If the items being returned need to be repackaged there will be a re-packing charge. Repack the item in a sturdy box and include a copy of your invoice and complete the form on the back of the invoice. You must ship orders back **PRE-PAID. WE DO NOT ACCEPT COD SHIPMENTS.** All exchanges need to have reshipping charges included. Items that are returned after 30 days are subject to 15% restocking charges. All fiberglass returned will have 15% restocking charge. No returns on electrical parts, video tapes, and books. Absolutely no returns on special order or close out merchandise.

**FREE CATALOGS** Speedway Motors offers FREE catalogs for Race, Street, Sprint and Midget, and T-bucket.

\*\*Some items are not legal for sale or use in California on pollution controlled motor vehicles. These items are legal in California for racing vehicles only which may never be used upon a highway.



Speedway Motors Inc., P.O. Box 81906 Lincoln, NE 68501  
402-323-3200 [SpeedwayMotors.com](http://SpeedwayMotors.com)

© 2011, Speedway Motors, Inc.