

913-39002  
913-39020

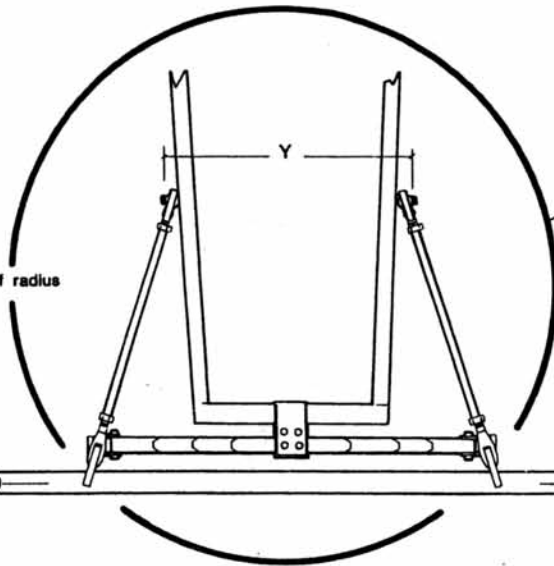

**Detail 1** Grind or file a 1/8" chamfer on both sides of each axle bracket where it meets the axle.

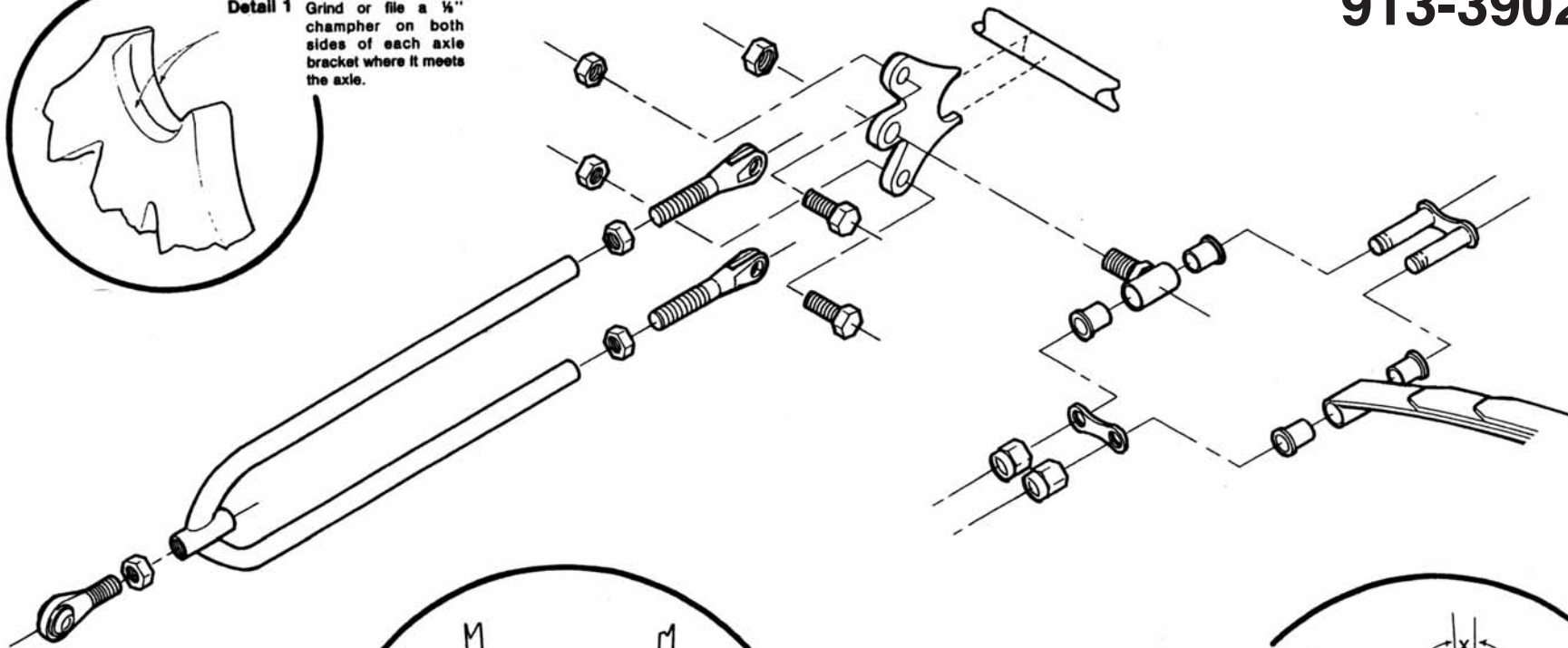

**Detail 2** "Y" = mounting width of radius rods on frame.

**Detail 3** The length of the radius rods and the rear mount location will determine the angle, "X", that you weld the brackets to your axle.

\*Mock up your set before you weld brackets permanently.

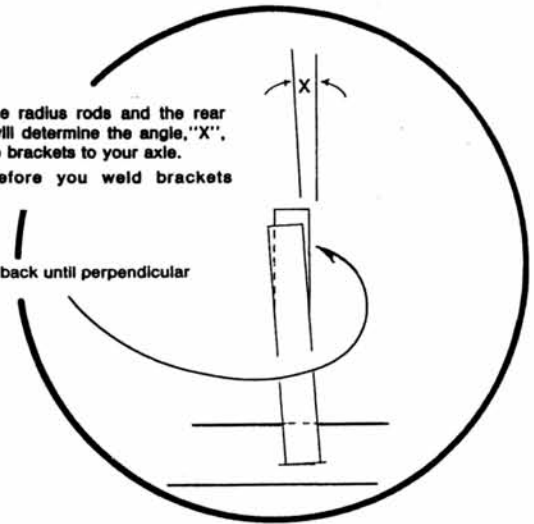

Bend spring pivot ear back until perpendicular to axle centerline.



Speedway Motors Inc., P.O. Box 81906  
Lincoln, NE 68501 (402) 323-3200  
www.speedwaymotors.com