

INSTRUCTIONS

910-32123

'49 to '54 CHEVY PASSENGER CAR KINGPIN KIT

WARNING: Support the vehicle securely with frame on jackstands. Never work under a car supported only by a jack. Failure to provide proper support may result in serious injury or possible death.

1. Remove wheels, tires, steering arm and brake components from spindle.
2. Remove upper and lower retaining rings and dust caps from spindle. **NOTE:** It may be necessary to drill a small hole in the center of the dust cap and use a self-tapping screw as a jack screw to free the dust cap.
3. Remove nut from kingpin lock bolt and drive out lock bolt with a brass hammer or drift. Remove grease zerks.
4. Support the suspension with a jack or stand as close to kingpin as possible and drive out kingpin. Remove spindle noting the location of the thrust washer and/or any shims (if used) to ensure proper reassembly. **NOTE:** If kingpin is seized and cannot be driven out, remove the upright/spindle assembly from vehicle and have kingpin pressed out.
5. Remove old bushings from spindle using a brass punch.
6. Thoroughly clean and inspect spindle and upright for signs of damage, scoring, or cracks. The new kingpin should be a snug fit in the upright bore and not have any play. If it is tight, the bore can be cleaned up lightly with a brake hone. If there is excessive play the upright will have to be removed and reamed for oversized kingpin and bushings. **NOTE:** These spindles are designed to use "floating" kingpin bushings that do not require reaming at installation. They are manufactured to final size for pin clearance and should be a hand press fit into the spindle.
7. Apply a light coat of grease to the new bushings and insert into the spindle, aligning the grease channel on the O.D. of the bushing with the grease zerk hole in the spindle. **IMPORTANT!** Installing bushings incorrectly will cause premature wear of kingpin and bushings. Install new grease zerk fittings.
8. Install the kingpin up through lower arm of spindle approximately 1". Install the thrust bearing on the kingpin with sheet metal dust shield facing up toward the upright boss. Position spindle on upright, sliding kingpin up into boss. Measure clearance between the top of upright boss to under side of upper spindle arm. If clearance is greater than .006" add shim(s) as necessary to obtain the proper clearance.
9. Orient notch of kingpin toward center of upright and push kingpin up through shims and through top arm of spindle, aligning the notch in the kingpin with the lock pin hole.
10. Install lock pin and nut. Install dust caps and retaining rings on spindle.
11. Repeat for other side of vehicle.
12. Install steering arms, brake components, wheels and tires.
13. Grease spindle bushings and perform front end alignment.

Speedway Motors Inc., P.O. Box 81906
Lincoln, NE 68501 (402) 323-3200
www.speedwaymotors.com



'49 to '54 CHEVY PASSENGER CAR COMPONENT IDENTIFICATION

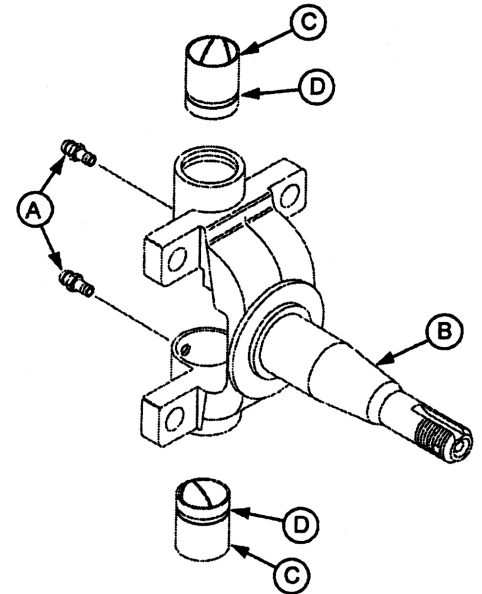
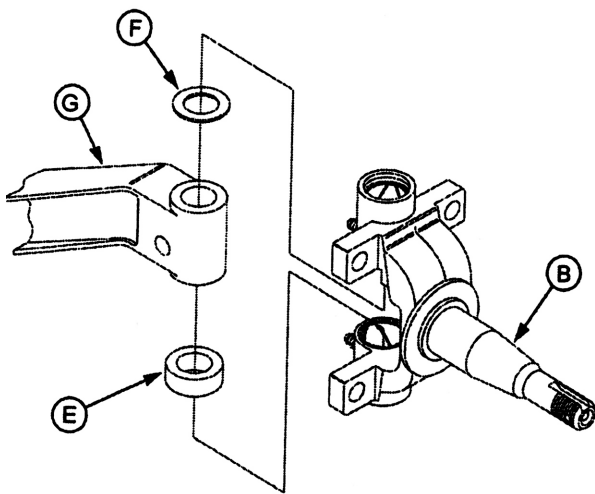
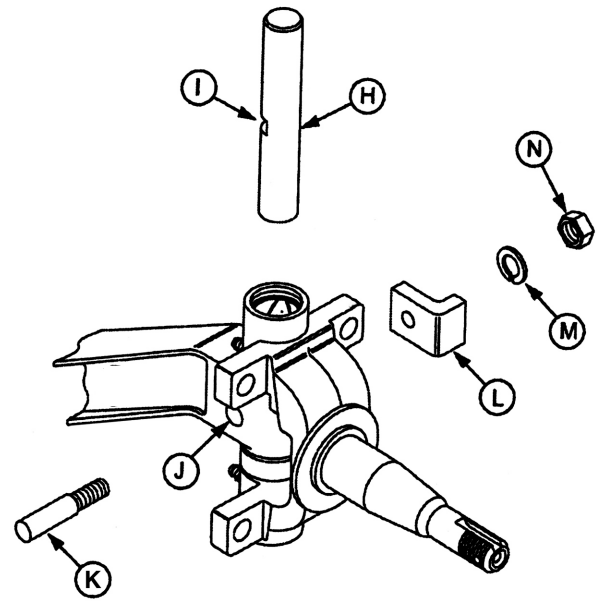
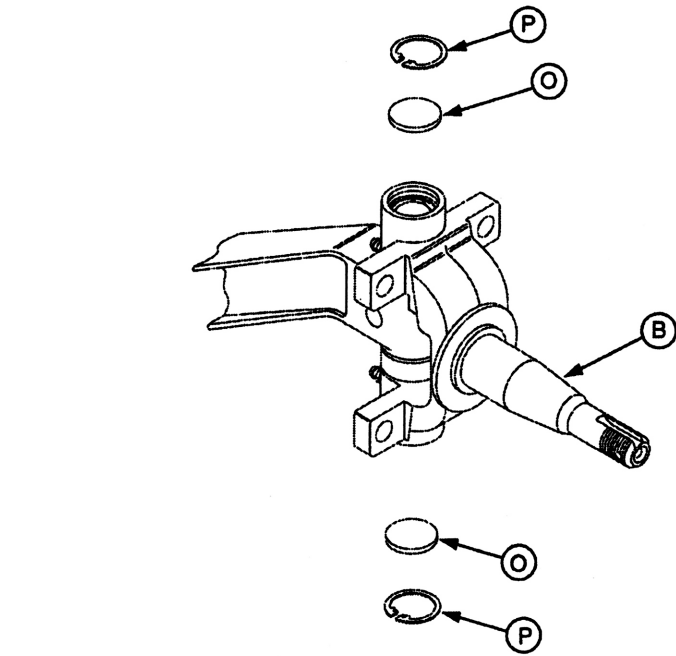

- A- grease zerker fittings
- B- spindle
- C- kingpin bushing
- D- grease channel
- E- thrust washer assembly/spacer
- F- shim(s)
- G- axle boss
- H- kingpin

- I- lock bolt notch
- J- lock bolt hole
- K- lock bolt
- L- steering stop (some applications)
- M- lock washer
- N- lock bolt nut
- O- dust cap (or Welch plug)
- P- retaining ring (if used)

IMPORTANT

DISCLAIMER In an effort to offer our customers the low prices, quick service and great value, Speedway Motors reserves the right to change suppliers, specifications, colors, prices, materials. Each of the previous items is subject to change without notice. Speedway is not responsible for any typographical errors or misinterpretations. Quantities are limited on some items.

WARRANTY DISCLAIMER The purchaser understands and recognizes that racing parts, specialized street rod equipment, and all parts and services sold by Speedway Motors, Inc. are exposed to many and varied conditions due to the manner in which they are installed and used. Speedway Motors, Inc. makes no warranties, either express or implied, including any warranty of merchantability or fitness for a particular purpose other than those contained in its current catalog with respect to the goods identified on the face of the invoice. There is no warranty expressed or implied as to whether the goods sold hereby will protect purchaser or ultimate user of such goods from injury or death. Speedway Motors assumes no liability after this period.

DAMAGE CLAIMS Always inspect your package upon delivery. Inspect all packages in the presence of the delivery driver. The driver must note any damage. Ask the driver the Carrier's procedures for handling damage claims. You must hold the original box, packing material and damaged merchandise for inspection or the carrier will not honor the claim. Notify Speedway Motors customer service department for instructions on returning damaged goods. Speedway is not responsible if no notification is given within 5 days of receipt.

SHORTAGES Always check the contents of your delivery to insure all the parts that you ordered were received. Please read the invoice. Double check all packing materials, small items may be wrapped inside with these products. Shortages may occur from damage to the box, so save all packing materials. Inspect the box for holes that would allow parts to fall out. If you are missing any item(s) be sure to check your invoice for back orders or canceled items before calling the customer service department. If Speedway has to split a shipment into multiple boxes, packages may be delivered on different days. You need to contact the customer service department within 5 days of delivery to assure the prompt replacement. Speedway Motors assumes no liability after this period.

REFUSALS All refused COD customers will be billed a 15% restocking charge plus freight to and from the destination! If you have questions please contact Speedway's customer service department.

WARRANTY CLAIMS If an item has a manufacturer's warranty as being free from defects we will exchange only. If the item has been used and you are requesting warranty work, this may take up to 30 days as warranty work is done by the manufacturer NOT Speedway Motors. If you have any questions please contact customer service.

RETURNS Speedway wants you to be satisfied with your purchase. If within 30 days after you receive your shipment you are not satisfied, you may return the item for refund or exchange. All exchanged or returned merchandise must be in original factory condition with no modifications or alterations. Returned merchandise must include all packaging materials, warranty cards, manuals, and accessories. If the items being returned need to be repackaged there will be a re-packing charge. Re-pack the item in a sturdy box and include a copy of your invoice and complete the form on the back of the invoice. You must ship orders back **PRE-PAID. WE DO NOT ACCEPT COD SHIPMENTS.** All exchanges need to have reshipping charges included. Items that are returned after 30 days are subject to 15% restocking charges. All fiberglass returned will have 15% restocking charge. No returns on electrical parts, video tapes, and books. Absolutely no returns on special order or close out merchandise.

FREE CATALOGS Speedway Motors offers FREE catalogs for Race, Street, Sprint and Midget, Sport Compact and Pedal Car restoration.

**Some items are not legal for sale or use in California on pollution controlled motor vehicles. These items are legal in California for racing vehicles only which may never be used upon a highway.

Speedway Motors Inc., P.O. Box 81906
Lincoln, NE 68501 (402) 323-3200
www.speedwaymotors.com



©Speedway Motors, Inc. 2007