

# INSTRUCTIONS

**910-31958**  
**COMPLETE KIT**

©Speedway Motors, Inc. Oct. 2008

## 11" DISC BRAKE KIT FOR '64-'72 CHEVELLE A-BODY

**PLEASE READ INSTRUCTIONS COMPLETELY  
BEFORE STARTING YOUR INSTALLATION!**

This disc brake kit allows you to use install '69-'72 11" GM midsize rotors and '69-'77 GM midsize calipers on your stock '64-'72 Chevelle disc brake spindles, or on Speedway's new stock replacement spindles (part number 910-34900).

**WARNING:** This kit will **NOT** fit drum brake spindles without spindle modifications. The upper boss on the drum brake spindle sticks out farther than the disc brake spindle. Approximately .610 will have to be machined off the boss on the drum brake spindles to work with this brake kit.

If you are going to use this kit on an A body Olds, Pontiac and Buick, it will not directly bolt on to the original spindles even with grinding the .610 off the stud at the top. The lower bolt holes in the original spindles are 7/16" and the bracket and bolts 1/2". The upper bolt holes on the original spindles are 1/2" with the brackets and bolts being 5/8". You will need to replace or modify the spindles.

### Parts List

Index No.	Description	Part Number	Quantity
1	64-72 GM Caliper brackets (pr)	910-34902	1
	Hardware kit	910-31958-2	1
2	5/8"-18 x 1" GR 8 hex cap screw (with head cut down)	in hardware kit	2
3	1/2"-20 x 3" GR 8 hex cap screw	in hardware kit	4
4	1/2"-20 SAE fine GR 8 crush lock nut	in hardware kit	4
5	64-72 GM Dust shields (pr)	910-34904	1
6	Inner bearing cup	installed in rotor	2
7	Inner bearing cone	912TLM67048	2
8	Grease seal	912S17187	2
9	69-72 GM 11" Rotor	910-65390	2
10	Outer bearing cup	installed in rotor	2
11	Outer bearing cone	912TLM11949	2
	Spindle nut kit	910-616005	1
12	Spindle washer	in spindle nut kit	2
13	Spindle nut	in spindle nut kit	2
14	Cotter pin	in spindle nut kit	2
15	Dust cap (pr)	910-31071	1
16	69-77 GM midsize caliper (left)	910-31035-L	1
16	69-77 GM midsize caliper (right)	910-31035-R	1
17	Brake pads (set)	919-3382	1
18	Caliper bolts	835-2300542	4
19*	64-72 Chevelle spindles (pr)	910-34900	1
Other parts needed:			
*	16" Stainless steel brake line kit	617-8562	1
* NOT INCLUDED			

**WARNING:** The selection and installation of brake components should only be done by personnel experienced in the proper installation and operation of braking systems. The installer must use his/her own discretion to determine the suitability of the brake components and brake kits for every particular application.

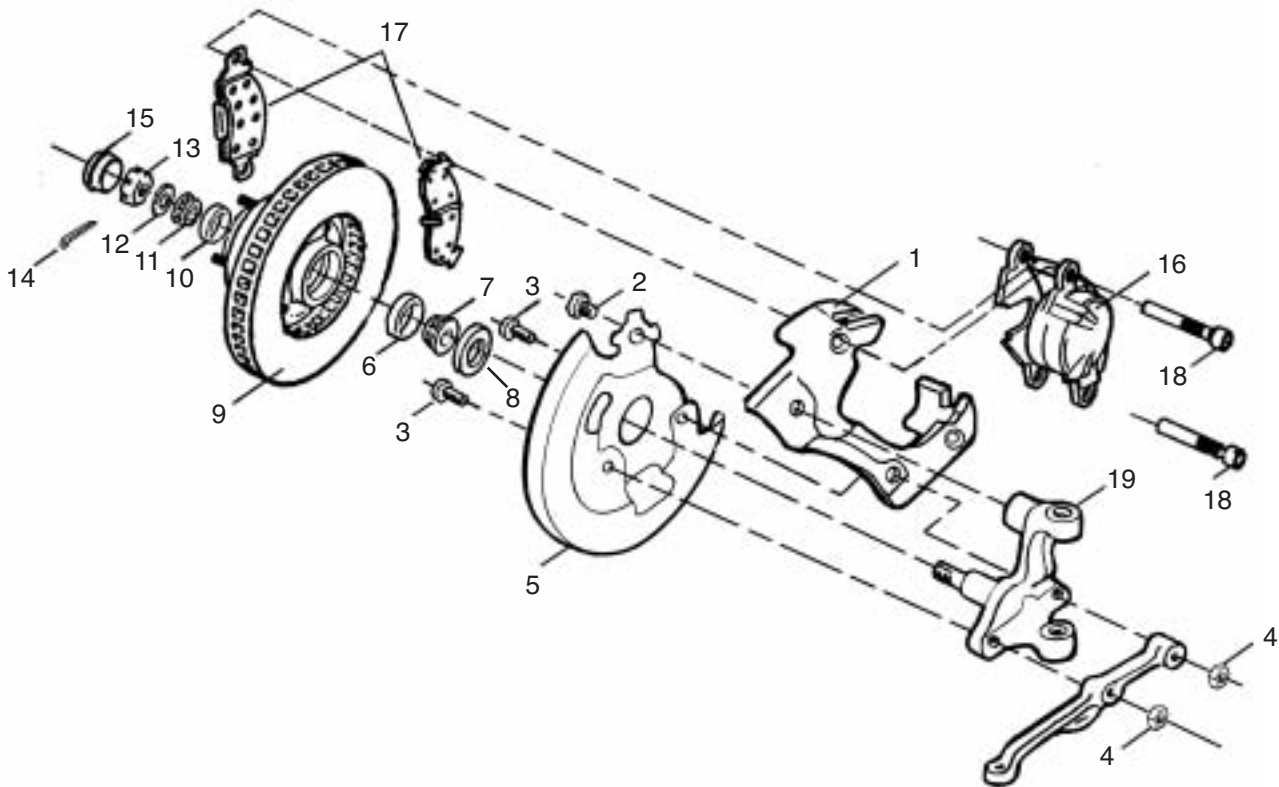

1. Using the parts list supplied double check that you have received all the parts in this kit. If there are any missing parts, please contact our customer service department.
2. Remove the complete brake assembly from your spindle. If you have drum brakes, the spindle must be modified. The upper boss where the backing plate bolts on sticks out farther than the disc brake spindle does. Approximately .610 will have to be machined off this boss to work with this brake kit. Inspect the spindles for grooves and cracks caused from excessive wear. Worn spindles should be replaced. Replacement spindles can be purchased from Speedway under p/n 910-34900.
3. Install the 5/8"-18 x 1" upper anchor bolt (#2) through the dust shield (#5), caliper bracket (#1) and into the spindle (#19), **NOTE:** make sure you use loctite on the threads of the 5/8" bolt. Install the 1/2"-20 x 3" lower caliper bolts (#3) from the wheel side of the spindle through the dust cover, caliper bracket, spindle and steering arm. Attach with the 1/2"-20 locking nuts (#4) Torque the upper 5/8" bolt to 73-110 ft. lbs. and torque the lower 1/2" bolts and lock nuts to 38-57 ft-lb. Fold over the locking tabs on the upper bolt of the dust cover.
4. Pack and install the inner bearings (#7) with fresh disc brake bearing grease, and install the grease seals (#8). Seals must be installed straight; a seal installation tool works well for this.
5. Install the rotor (#9) onto the spindle (#19), pack and install the outer bearing (#11). Install the spindle washer (#12) and spindle nut (#13). Adjust the bearing preload as normal. Install the cotter pin (#14) and dust cap (#15).
6. Install the brake pads (#17) into the calipers (#16) and install them into the caliper brackets (#1), making sure the bleeders are pointing up. Only use the correct GM mounting bolts (#16).
7. Install new brake lines making sure you check that the lines have clearance through the entire suspension travel and turning radius. Bleed the system as normal.
8. Before operating the vehicle, test the brakes under controlled conditions. Make several stops in a safe area from low speeds and gradually work up to operating speeds.

**NOTE:** Some wheels may not clear the snout on the rotors. If necessary the rotor can be machined for clearance. Some brands of wheels may interfere with the top of the caliper. If necessary you can grind a small amount of material off the top of the caliper, at the point of contact.

# IMPORTANT

**DISCLAIMER** In an effort to offer our customers the low prices, quick service and great value, Speedway Motors reserves the right to change suppliers, specifications, colors, prices, materials. Each of the previous items is subject to change without notice. Speedway is not responsible for any typographical errors or misinterpretations. Quantities are limited on some items.

**WARRANTY DISCLAIMER** The purchaser understands and recognizes that racing parts, specialized street rod equipment, and all parts and services sold by Speedway Motors, Inc. are exposed to many and varied conditions due to the manner in which they are installed and used. Speedway Motors, Inc. makes no warranties, either express or implied, including any warranty of merchantability or fitness for a particular purpose other than those contained in its current catalog with respect to the goods identified on the face of the invoice. There is no warranty expressed or implied as to whether the goods sold hereby will protect purchaser or ultimate user of such goods from injury or death. Speedway Motors assumes no liability after this period.

**DAMAGE CLAIMS** Always inspect your package upon delivery. Inspect all packages in the presence of the delivery driver. The driver must note any damage. Ask the driver the Carrier's procedures for handling damage claims. You must hold the original box, packing material and damaged merchandise for inspection or the carrier will not honor the claim. Notify Speedway Motors customer service department for instructions on returning damaged goods. Speedway is not responsible if no notification is given within 5 days of receipt.

**SHORTAGES** Always check the contents of your delivery to insure all the parts that you ordered were received. Please read the invoice. Double check all packing materials, small items may be wrapped inside with these products. Shortages may occur from damage to the box, so save all packing materials. Inspect the box for holes that would allow parts to fall out. If you are missing any item(s) be sure to check your invoice for back orders or canceled items before calling the customer service department. If Speedway has to split a shipment into multiple boxes, packages may be delivered on different days. You need to contact the customer service department within 5 days of delivery to assure the prompt replacement. Speedway Motors assumes no liability after this period.

**REFUSALS** All refused COD customers will be billed a 15% restocking charge plus freight to and from the destination! If you have questions please contact Speedway's customer service department.

**WARRANTY CLAIMS** If an item has a manufacturer's warranty as being free from defects we will exchange only. If the item has been used and you are requesting warranty work, this may take up to 30 days as warranty work is done by the manufacturer NOT Speedway Motors. If you have any questions please contact customer service.

**RETURNS** Speedway wants you to be satisfied with your purchase. If within 30 days after you receive your shipment you are not satisfied, you may return the item for refund or exchange. All exchanged or returned merchandise must be in original factory condition with no modifications or alterations. Returned merchandise must include all packaging materials, warranty cards, manuals, and accessories. If the items being returned need to be repackaged there will be a re-packing charge. Re-pack the item in a sturdy box and include a copy of your invoice and complete the form on the back of the invoice. You must ship orders back **PRE-PAID. WE DO NOT ACCEPT COD SHIPMENTS.** All exchanges need to have reshipping charges included. Items that are returned after 30 days are subject to 15% restocking charges. All fiberglass returned will have 15% restocking charge. No returns on electrical parts, video tapes, and books. Absolutely no returns on special order or close out merchandise.

**FREE CATALOGS** Speedway Motors offers FREE catalogs for Race, Street, Sprint and Midget, Sport Compact and Pedal Car restoration.

\*\*Some items are not legal for sale or use in California on pollution controlled motor vehicles. These items are legal in California for racing vehicles only which may never be used upon a highway.

Speedway Motors Inc., P.O. Box 81906  
Lincoln, NE 68501 (402) 323-3200  
[www.speedwaymotors.com](http://www.speedwaymotors.com)



©Speedway Motors, Inc. 2007