



an ISO 9001:2008 Registered Company

1970-74 Challenger/Cuda

with A/C

Control Panel Conversion Kit

471077-EDA

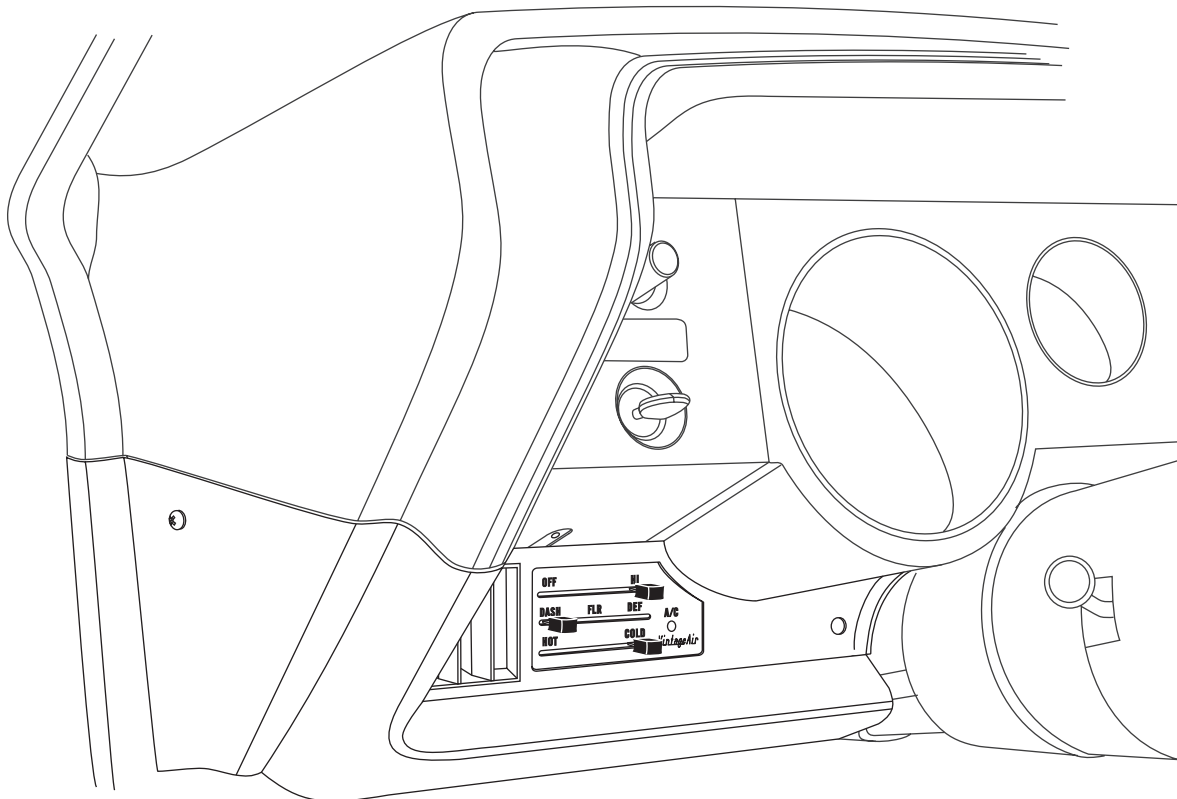

18865 Goll St. San Antonio, TX 78266 ph: 210-654-7171 fax: 210-654-3113



Table of Contents

- 1. Cover**
- 2. Table of Contents**
- 3. Packing List/Parts Disclaimer**
- 4. Removing OEM Control Panel**
Figure 1
- 5. Control Panel Installation**
Figure 2
- 6. Knob & Control Panel Harness Installation**
Figures 3 & 4
- 7. Wiring Diagram**
- 8. Operation of Controls**
- 9. Packing List**



Packing List Control Kit (471077-EDA)

No.	Qty.	Part No.	Description
1.	1	471074-EDA	70-74 Challenger/Cuda with A/C Control Panel Assembly
2.	2	18235-VUB	#8 X 1/2" PH Pan Head Screws
3.	2	186008-WSR	#8 Washer
4.	3	491006-KUR	Slide POT Knob
5.	1	232007-VUR	Gen IV Universal Control Harness (Type C)

**** Before beginning installation, open all packages and check contents of shipment. Please report any shortages directly to Vintage Air within 15 days. After 15 days, Vintage Air will not be responsible for missing or damaged items.**

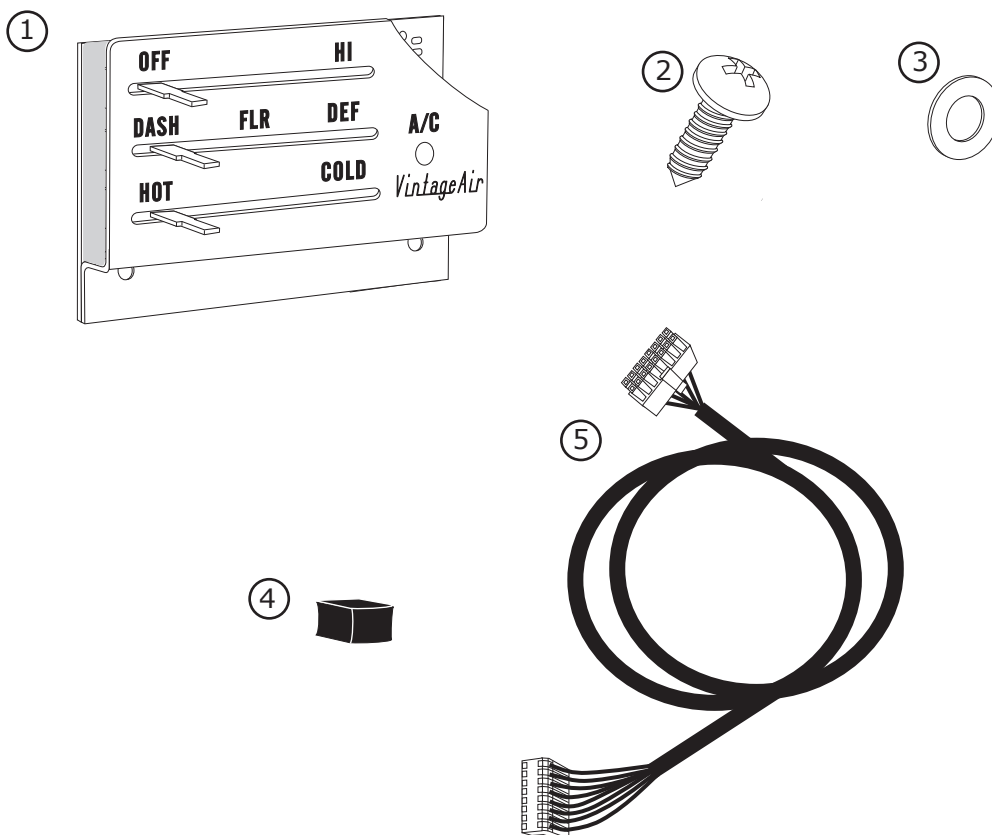



Removing OEM Control Panel

1. Disconnect wires, vacuum hoses and control lever cable from the back of the OEM control panel.
2. Remove OEM control panel (discard) (See Figure 1, below).

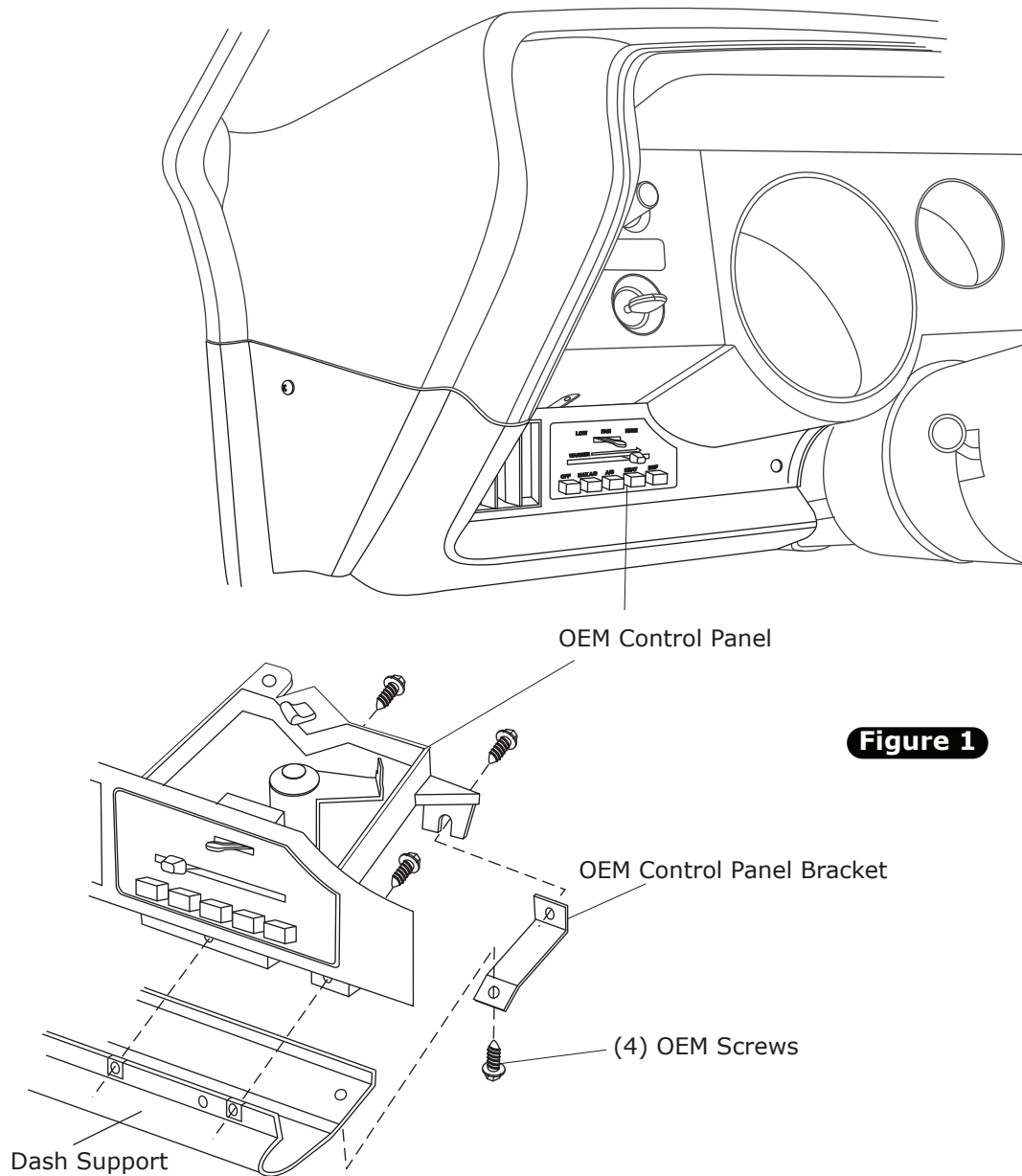
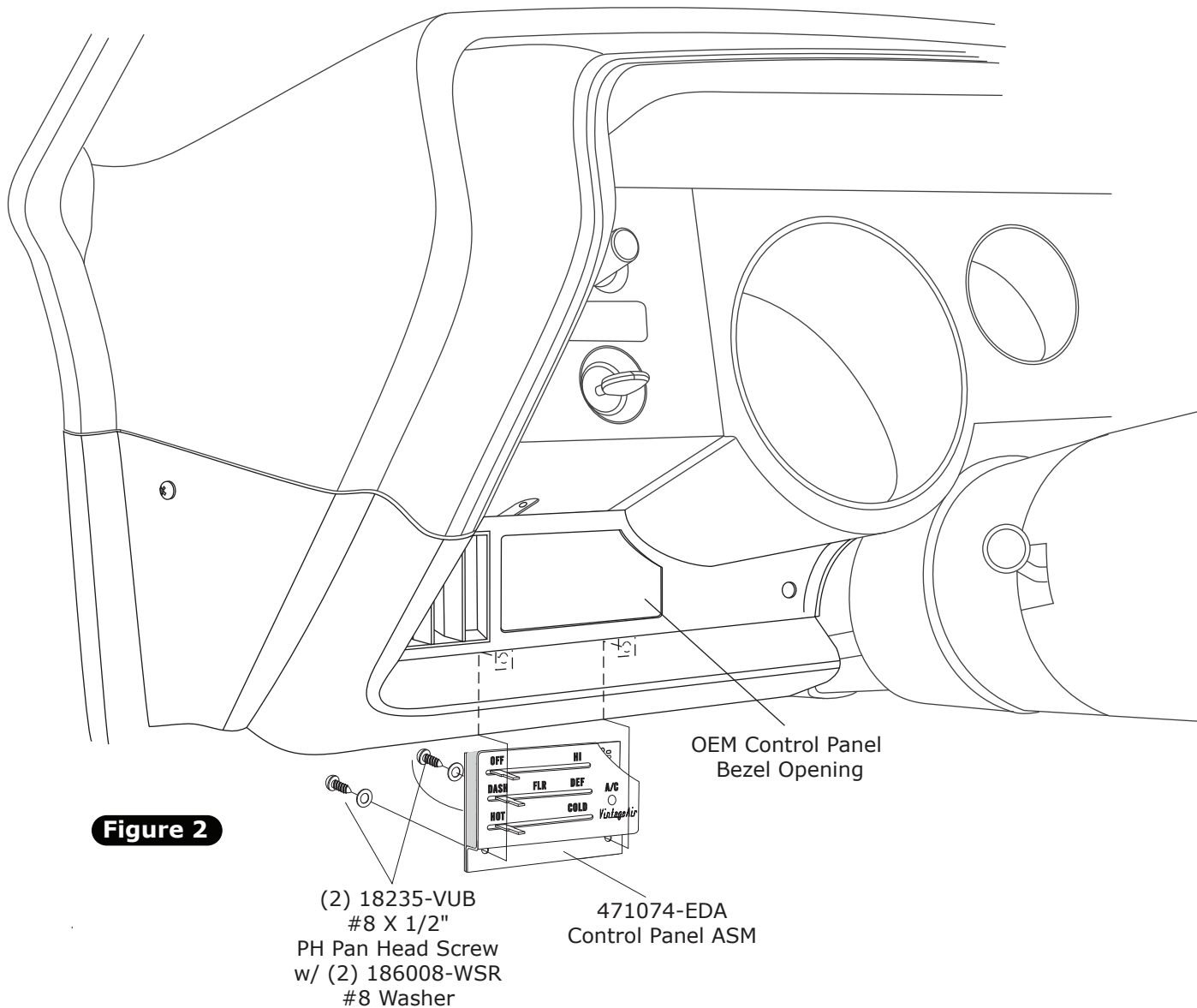

Figure 1



Control Panel Installation

1. Install control panel assembly from under the dash in the opening of the OEM control panel bezel as shown in Figure 2, below.
2. Secure the control panel assembly to the dash using (2) #8 X 1/2" PH pan head screws as shown in Figure 2, below.





Knob Installation

1. Install (3) knobs as shown in Figure 3, below.

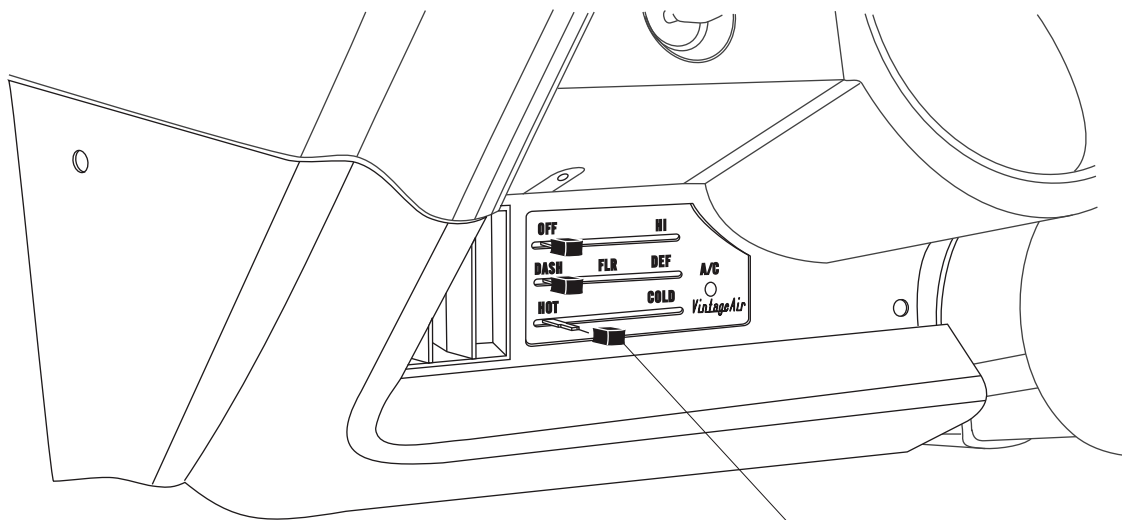

Figure 3

(3) 491006-KUR
Slide POT Knob

Control Harness

1. From under the dash, plug in the control panel wiring harness as shown in Figure 4, below.

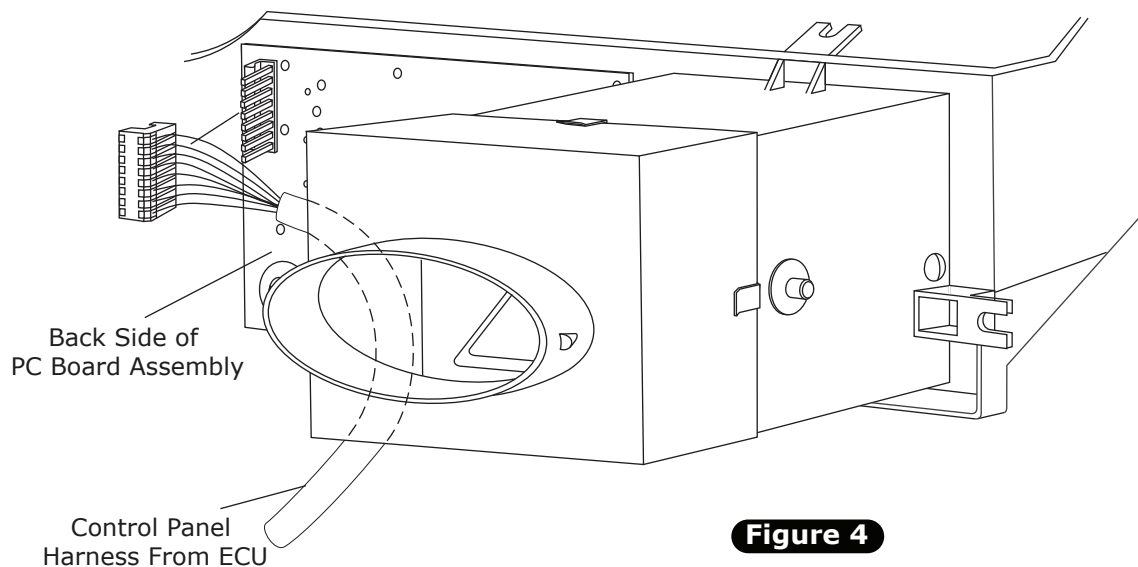

Figure 4



Z32007-VOR

JF8 Pin	Wiring	Component
1	TAN	AC ANNUNCIATOR
2	ORA	BACKLIGHT POS
3	BLK	BACKLIGHT NEG
4	WHT	GND
5	RED	5V-SW
6	WHT/RED	TEMP WIPER
7	WHT/YEL	MODE WIPER
8	WHT/GRN	FAN WIPER
9		
10		

232002-VUA

Wiring connections for the 232002-VUA unit:

- A/C (IF USED):** RED, WHT/BLU, WHT
- TEMP:** RED, WHT/RED, WHT
- MODE:** RED, WHT/YEL
- FAN:** RED, WHT/GRN, WHT

VIEWED FROM WIRE SIDE

*** WIDE OPEN
THROTTLE
SWITCH
(OPTIONAL)

IGNITION SWITCH

+ 12v

**** CIRCUIT
BREAKER
30 AMP**

COMPRESSOR RELAY

GEN IV WIRING DIAGRAM
REV D. 5/6/2014

The diagram illustrates the wiring for the control panel components. A central vertical bus is connected to various terminals on the left and right. On the left, terminals are labeled JM3, JM4, JM5, JM6, JM2, and JM1 from top to bottom. On the right, terminals are labeled RED, GRN, YEL, BLU, GRN, and BLK for each of the three stepper motors. The stepper motors are labeled STEPPER DASH/FLOOR, STEPPER DEFROST/PLENUM, and STEPPER TEMPERATURE BLEND. The evaporator temperature sensor is connected to the BLK terminal of JM1. The blower motor is connected to the BLK, YEL, and BLK terminals of JM1. The BSC (Blower Speed Control) is connected to the RED and WHT terminals of JM1. The ORA and GRY terminals of JM1 are connected to the blower motor. The diagram also shows a power source (AC) connected to the top of the bus.

BLOWER MOTOR

HEATER
CONTROL VALVE

NOTE:  = CHASSIS GROUND

- **Dash Lamp Is Used Only With Type 232007-VUR Harness.**
- **Warning: Always Mount Circuit Breaker As Close to the Battery As Possible. (NOTE: Wire Between Battery and Circuit Breaker Is Unprotected and Should Be Carefully Routed to Avoid a Short Circuit).**
- **Wide Open Throttle Switch Contacts Close Only at Full Throttle, Which Disables A/C Compressor.**



Operation of Controls

On Gen IV systems with three lever/knob controls, the temperature control toggles between heat and A/C operations. To activate A/C, move the temperature lever/knob all the way to cold and then back it off to the desired vent temperature. For heat operation, move the temperature lever/knob all the way to hot and then adjust to the desired vent temperature. The blower will momentarily change speed, each time you toggle between operations, to indicate the change. **NOTE: For proper control panel function, refer to control panel instructions for calibration procedure.**

Blower Speed

This lever/knob controls blower speed, from OFF to HI.

Mode Control

This lever/knob controls the mode positions, from DASH to FLOOR to DEFROST, with a blend in between.

Temperature Control

This lever/knob controls the temperature, from HOT to COLD.

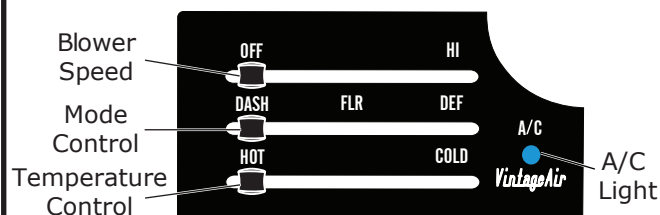

A/C Operation

Blower Speed

Adjust to desired speed.

Mode Control

Adjust to desired mode position (DASH position recommended).

Temperature Control

For A/C operation, adjust to coldest position to engage compressor (Adjust between HOT and COLD to reach desired temperature).

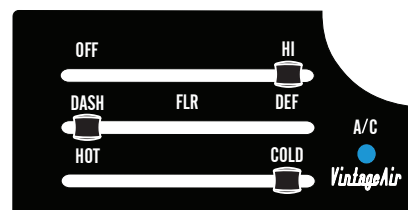

NOTE: A/C operation toggles on & off when thermostat lever is moved to the HOT or COLD ends of travel. A/C mode is indicated by the blue A/C light.

Heat Operation

Blower Speed

Adjust to desired speed.

Mode Control

Adjust to desired mode position (FLOOR position recommended).

Temperature Control

For maximum heating, adjust to hottest position (Adjust between HOT and COLD to reach desired temperature).

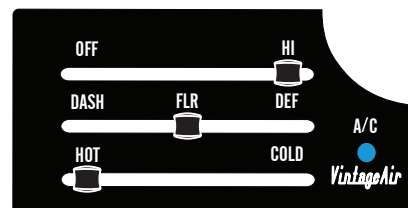

Defrost/De-fog Operation

Blower Speed

Adjust to desired speed.

Temperature Control

Adjust to desired temperature.

Mode Control

Adjust to DEFROST position for maximum defrost, or between FLOOR and DEFROST positions for a bi-level blend (Compressor is automatically engaged).





Packing List Control Kit (471077-EDA)

No.	Qty.	Part No.	Description	
1.	1	471074-EDA	70-74 Challenger/Cuda with A/C Control Panel Assembly	_____
2.	2	18235-VUB	#8 X 1/2" PH Pan Head Screws	_____
3.	2	186008-WSR	#8 Washer	_____
4.	3	491006-KUR	Slide POT Knob	_____
5.	1	232007-VUR	Gen IV Universal Control Harness (Type C)	_____

Checked By: _____
Packed By: _____
Date: _____

