



an ISO 9001:2008 Registered Company

1970-74 Challenger/Cuda

without A/C

Control Panel Conversion Kit

471075-EDA

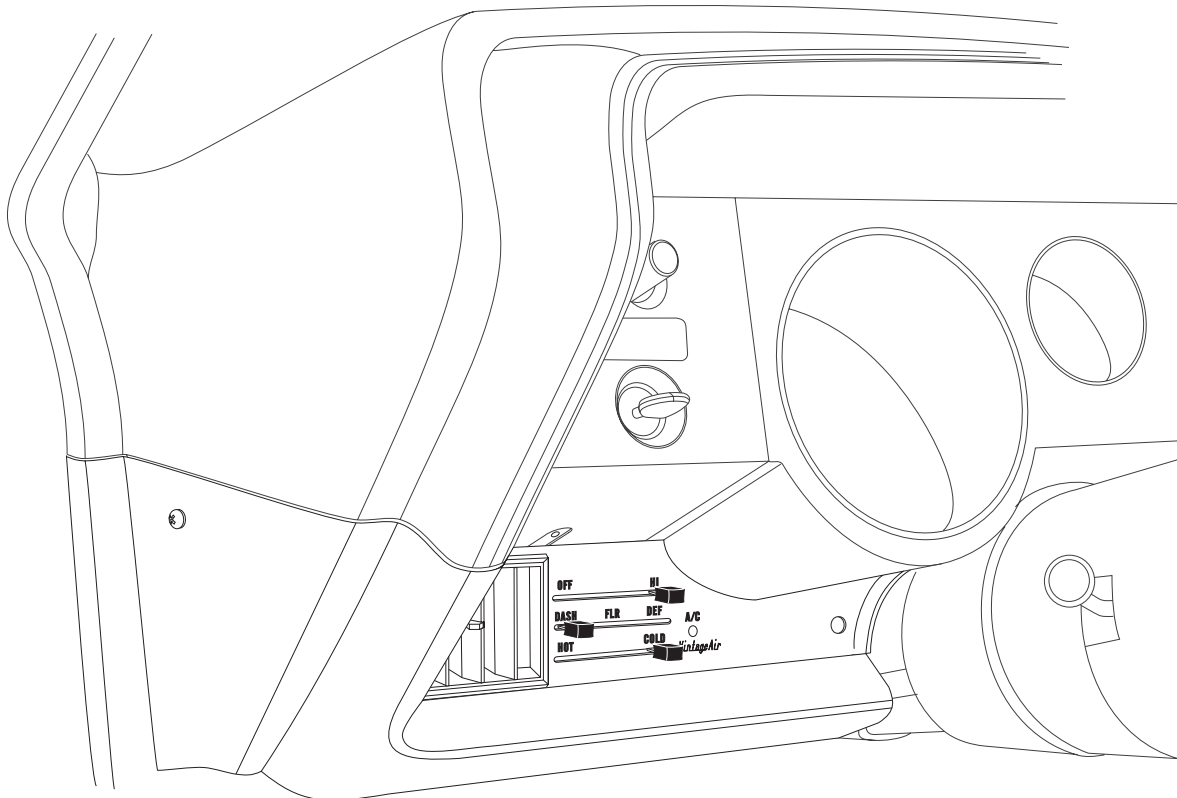

18865 Goll St. San Antonio, TX 78266 ph: 210-654-7171 fax: 210-654-3113



Table of Contents

- 1. Cover**
- 2. Table of Contents**
- 3. Packing List/Parts Disclaimer**
- 4. Removing OEM Control Panel**
Figures 1 & 2
- 5. Control Panel & Control Panel Bracket Installation**
Figures 3, 4 & 4a
- 6. Control Panel Bracket Installation (Cont.)**
Figures 5 & 6
- 7. Control Panel Harness, Louver & Dash Installation**
Figures 7, 8 & 9
- 8. Wiring Diagram**
- 9. Operation of Controls**
- 10. Packing List**



Packing List Control Kit (471075-EDA)

No.	Qty.	Part No.	Description
1.	1	471072-EDA	70-74 Challenger/Cuda without A/C Control Panel Assembly
2.	1	246112-PUA	70-74 Challenger/Cuda PC Board Assembly
3.	3	491006-KUR	Slide POT Knob
4.	1	180043-SSR	128/198 ID X 313 OD X .500" LG Nylon Spacer
5.	1	180041-SSR	128/198 ID X 313 OD X .375" LG Nylon Spacer
6.	4	18235-VUB	8 X 1/2" PH Pan Head Screws
7.	2	181075-PSR	8 X 1" PH Pan Head Screws
8.	1	497074-LMA	70-74 Mopar Louver Assembly
9.	2	18979-VUB	#8 J-nut
10.	1	232007-VUR	Gen IV Universal Control Harness (Type C)

**** Before beginning installation, open all packages and check contents of shipment. Please report any shortages directly to Vintage Air within 15 days. After 15 days, Vintage Air will not be responsible for missing or damaged items.**

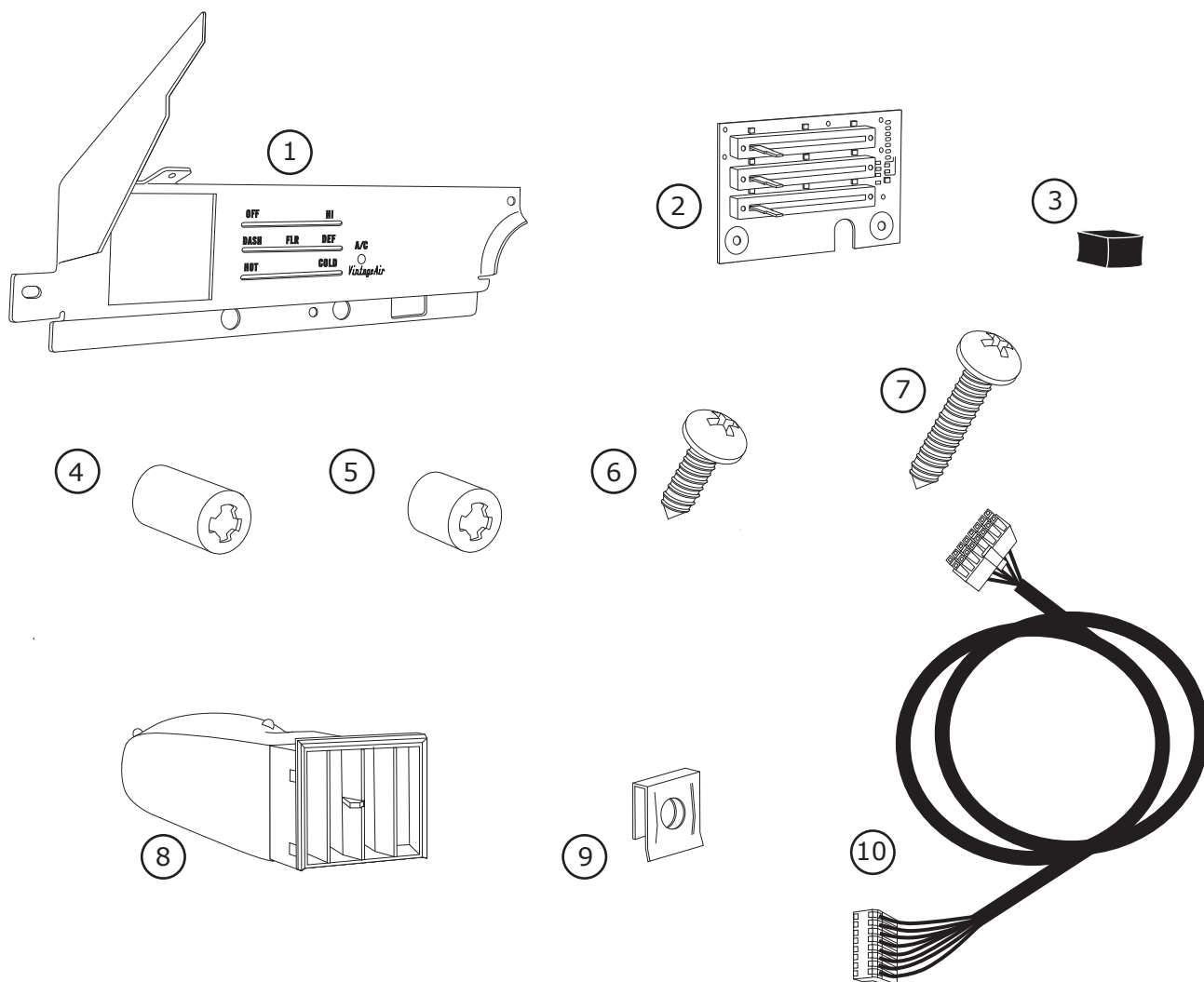



Removing OEM Control Panel

1. Drop steering column to ease installation.
2. Remove the bottom portion of the dash (retain) (See Figure 1, below).
3. Disconnect the wires from the back of the fan switch and the control lever cables.
4. Remove the OEM control panel (See Figure 2, below).

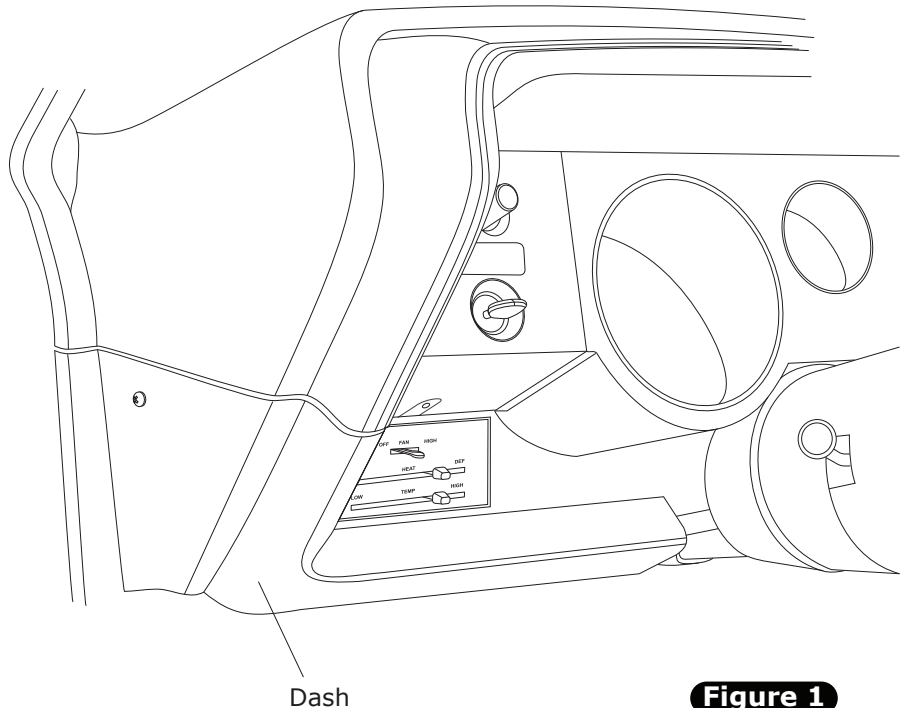

Figure 1

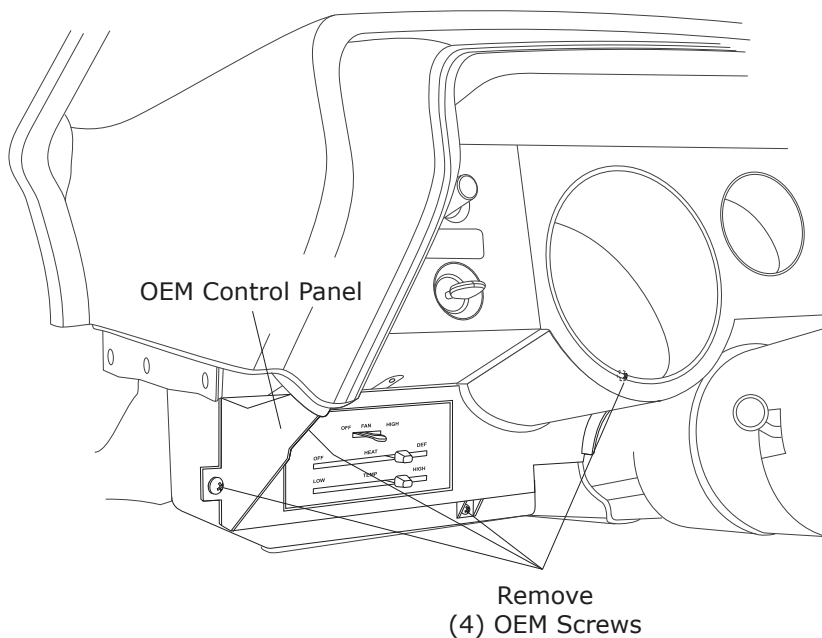

Figure 2



Control Panel Installation

1. Install (2) J-nuts on dash (See Figure 3, below).
2. Using (2) #8 X 1/2" PH pan head screws, install PC board assembly as shown in Figure 3, below.

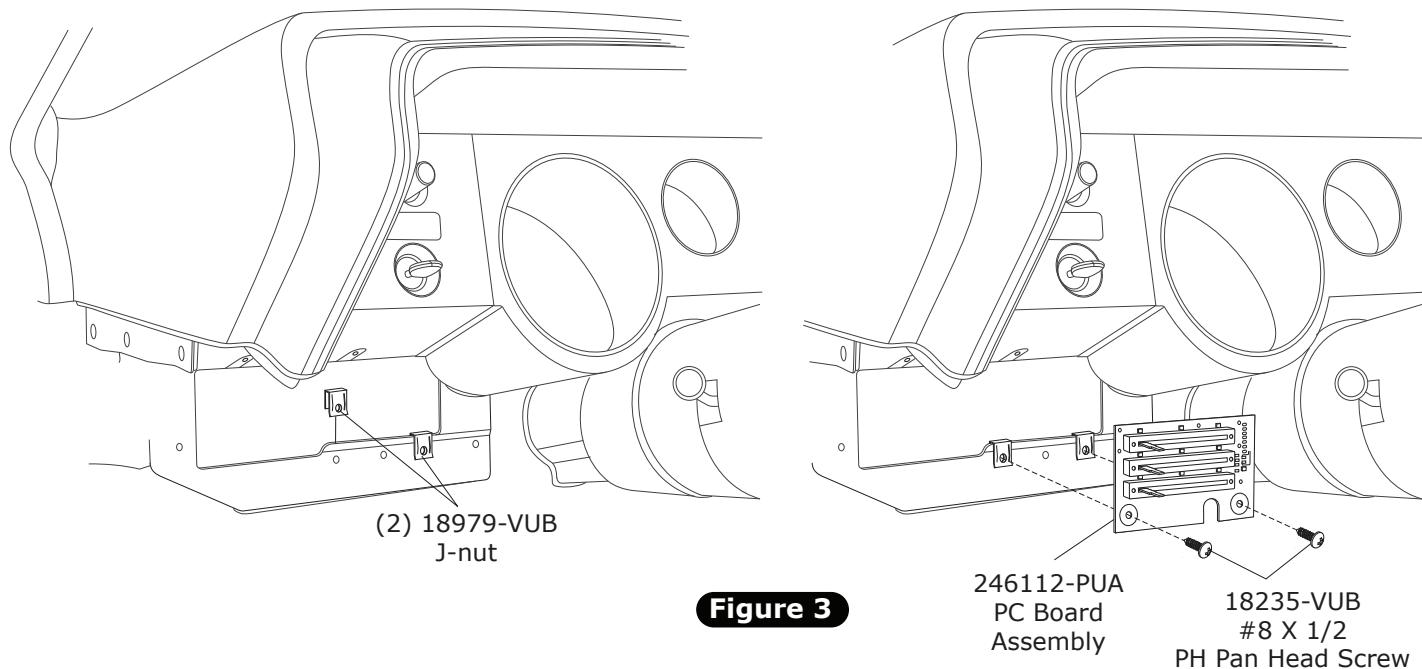

Figure 3

Control Panel Bracket Installation

1. Install control panel bracket assembly (See Figures 4 & 4a, below). **NOTE: Left side of bracket installs in the channel of the dash as in OEM panel.**

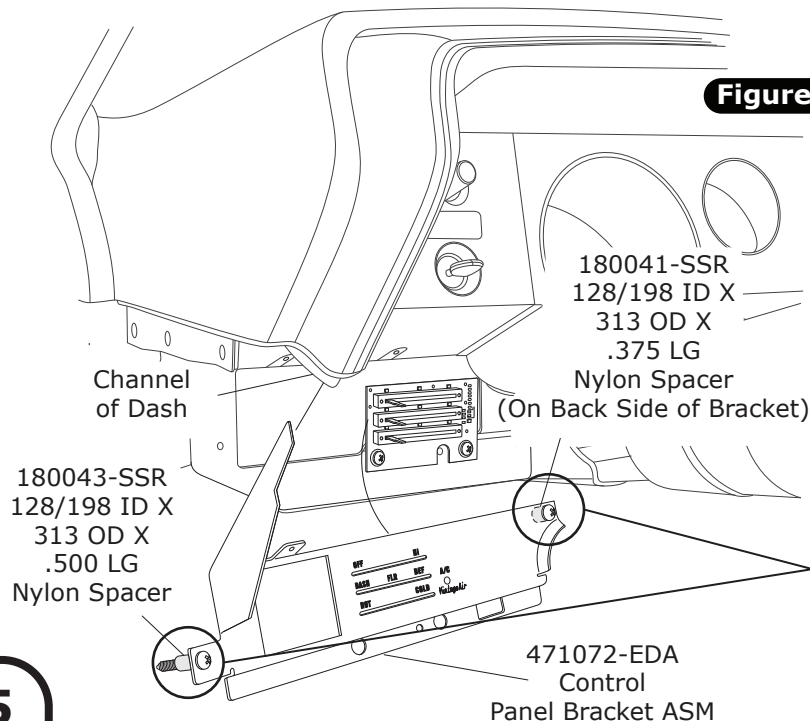

Figure 4

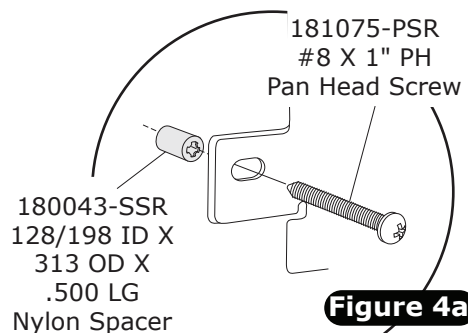

Figure 4a

NOTE: Install the spacers on the bracket as shown in Figure 4a, above, before installing the bracket. This will hold the spacers in place to ease installation.



Control Panel Bracket Installation (Cont.)

1. Secure control panel bracket as shown (See Figure 5, below). **NOTE: Install the right side of the control panel bracket located on the other side of the speedometer first.**

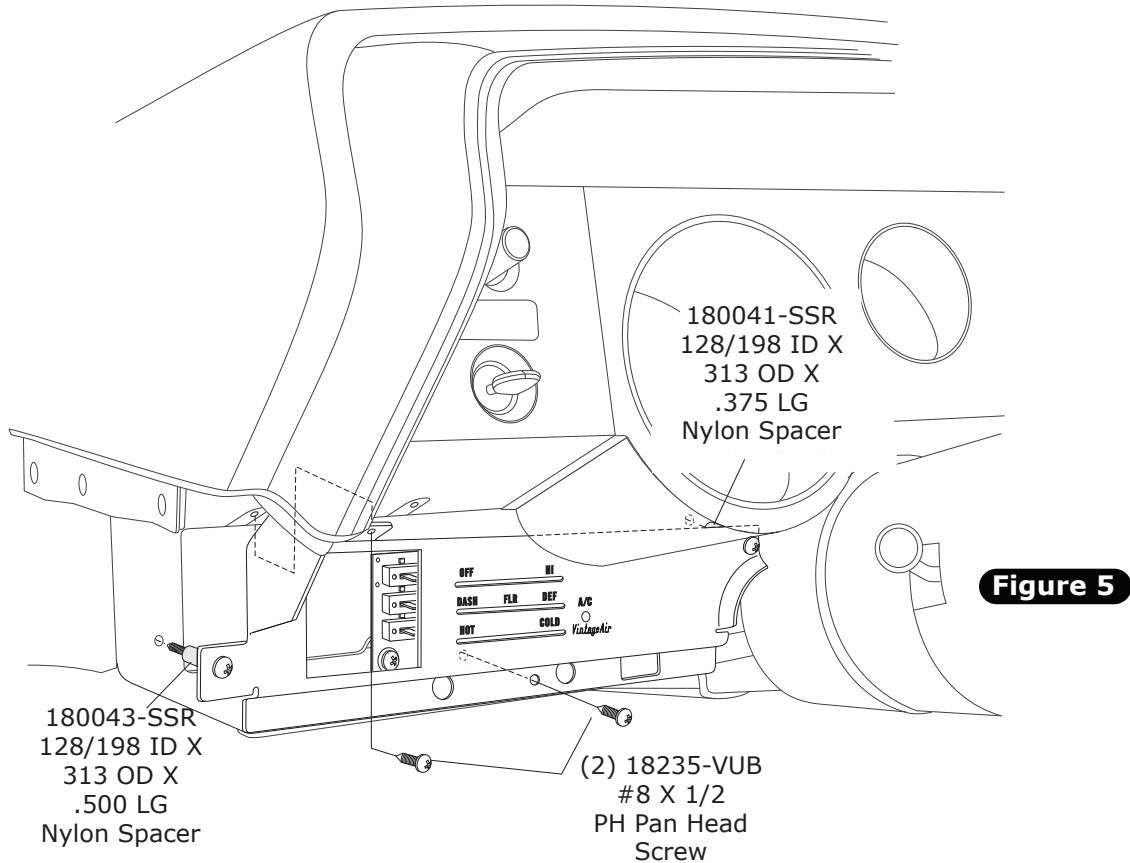

Control Panel Bracket Installation (Cont.)

1. Reaching through the duct hole opening in the bracket, support the back side of the PC board assembly. Install (3) knobs as shown in Figure 6, below.

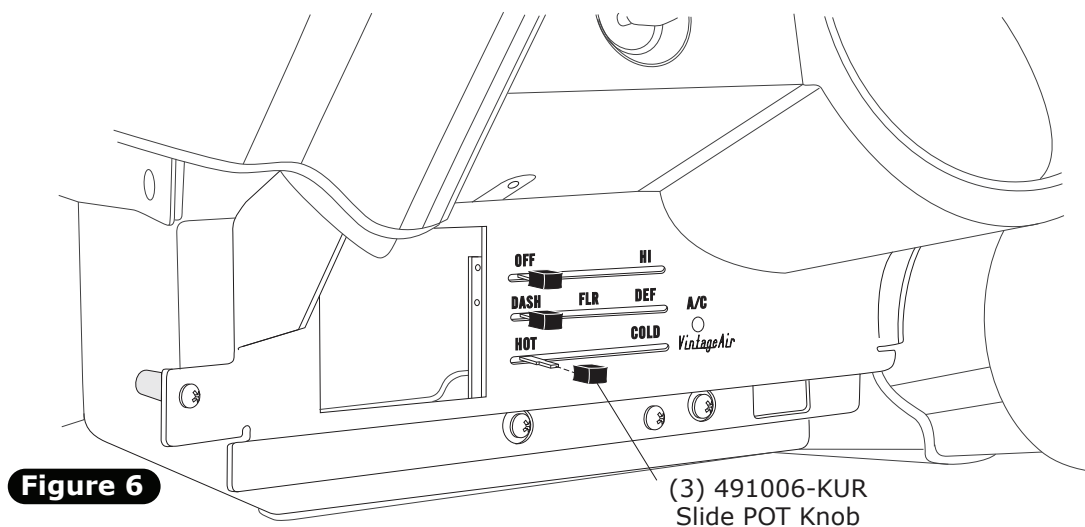



Control Harness

1. From under the dash, plug in the control panel wiring harness as shown in Figure 7, below.

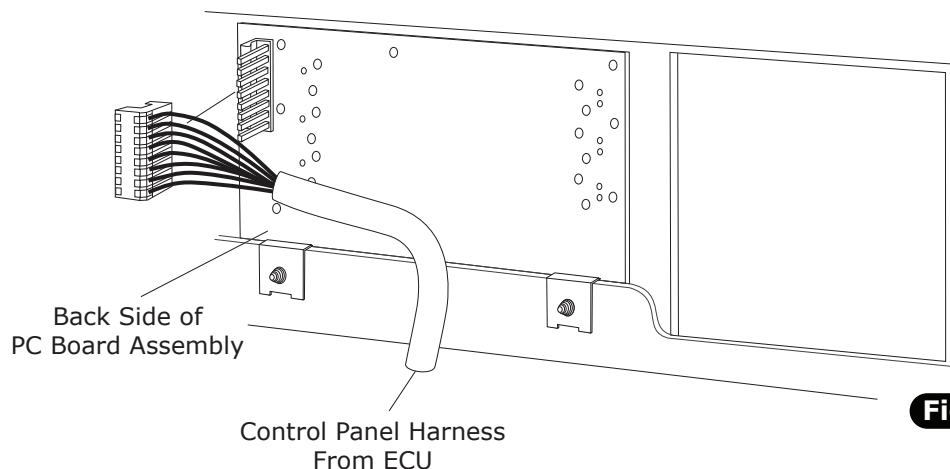

Figure 7

Louver Installation

1. Install driver side louver as shown in Figure 8, below.

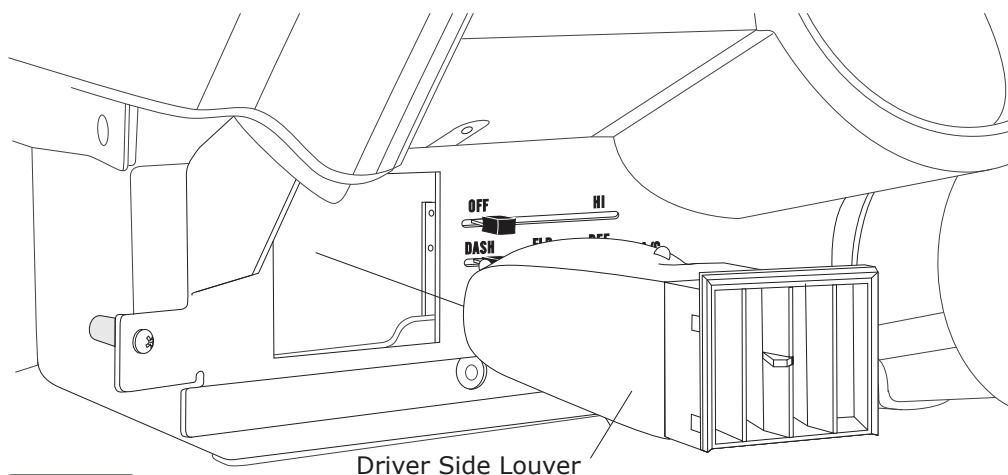

Figure 8

Dash Installation

1. Using OEM screws, reinstall the bottom portion of the dash as shown in Figure 9, below.

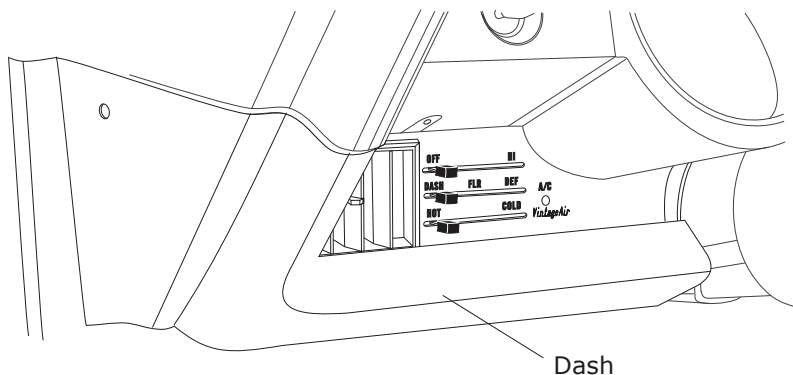

Figure 9



Operation of Controls

On Gen IV systems with three lever/knob controls, the temperature control toggles between heat and A/C operations. To activate A/C, move the temperature lever/knob all the way to cold and then back it off to the desired vent temperature. For heat operation, move the temperature lever/knob all the way to hot and then adjust to the desired vent temperature. The blower will momentarily change speed, each time you toggle between operations, to indicate the change. **NOTE: For proper control panel function, refer to control panel instructions for calibration procedure.**

Blower Speed

This lever/knob controls blower speed, from OFF to HI.

Mode Control

This lever/knob controls the mode positions, from DASH to FLOOR to DEFROST, with a blend in between.

Temperature Control

This lever/knob controls the temperature, from HOT to COLD.



A/C Operation

Blower Speed

Adjust to desired speed.

Mode Control

Adjust to desired mode position (DASH position recommended).

Temperature Control

For A/C operation, adjust to coldest position to engage compressor (Adjust between HOT and COLD to reach desired temperature).

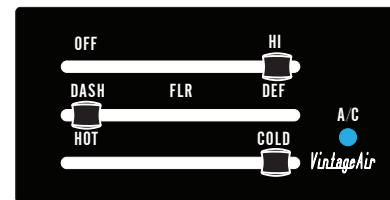

NOTE: A/C operation toggles on & off when thermostat lever is moved to the HOT or COLD ends of travel. A/C mode is indicated by the blue A/C light.

Heat Operation

Blower Speed

Adjust to desired speed.

Mode Control

Adjust to desired mode position (FLOOR position recommended).

Temperature Control

For maximum heating, adjust to hottest position (Adjust between HOT and COLD to reach desired temperature).

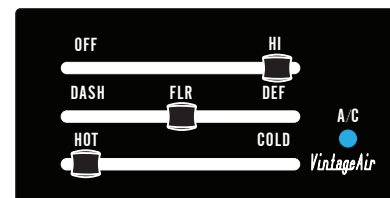

Defrost/De-fog Operation

Blower Speed

Adjust to desired speed.

Temperature Control

Adjust to desired temperature.

Mode Control

Adjust to DEFROST position for maximum defrost, or between FLOOR and DEFROST positions for a bi-level blend (Compressor is automatically engaged).





Packing List Control Kit (471075-EDA)

No.	Qty.	Part No.	Description	
1.	1	471072-EDA	70-74 Challenger/Cuda without A/C Control Panel Assembly	_____
2.	1	246112-PUA	70-74 Challenger/Cuda PC Board Assembly	_____
3.	3	491006-KUR	Slide POT Knob	_____
4.	1	180043-SSR	128/198 ID X 313 OD X .500" LG Nylon Spacer	_____
5.	1	180041-SSR	128/198 ID X 313 OD X .375" LG Nylon Spacer	_____
6.	4	18235-VUB	8 X 1/2" PH Pan Head Screws	_____
7.	2	181075-PSR	8 X 1" PH Pan Head Screws	_____
8.	1	497074-LMA	70-74 Mopar Louver Assembly	_____
9.	2	18979-VUB	#8 J-nut	_____
10.	1	232007-VUR	Gen IV Universal Control Harness (Type C)	_____

Checked By: _____
Packed By: _____
Date: _____

