



an ISO 9001:2008 Registered Company

1968-72 CHEVY NOVA

CONDENSER KIT WITHOUT DRIER

026671

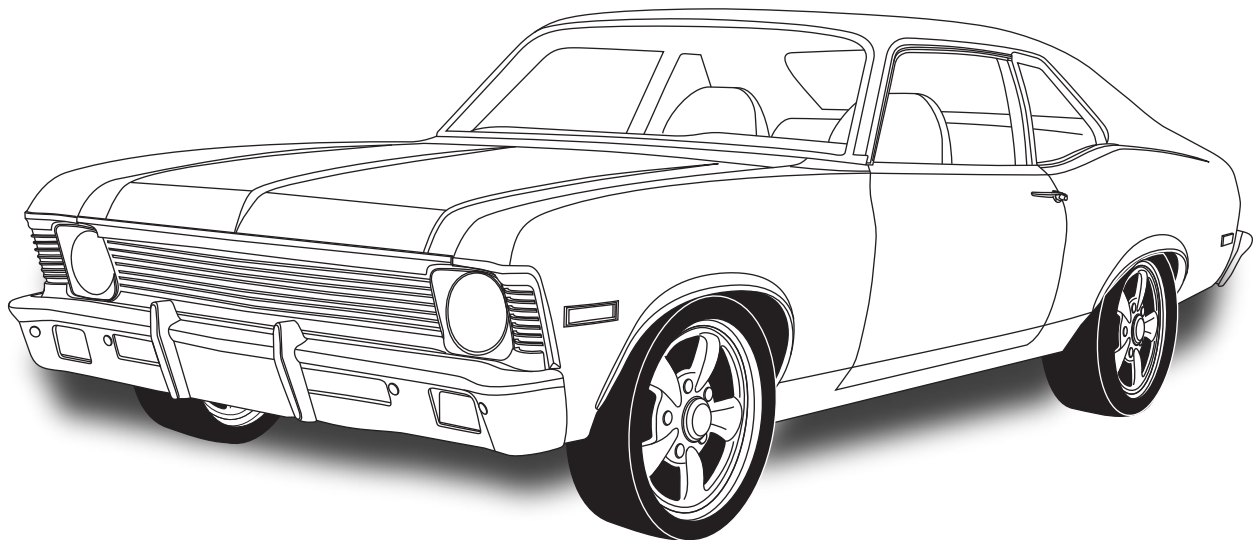



TABLE OF CONTENTS

PAGES

1. COVER
2. TABLE OF CONTENTS
3. PACKING LIST/PARTS DISCLAIMER
4. INFORMATION PAGE
5. MOUNTING BRACKET INSTALLATION
6. RADIATOR/HOOD LATCH REMOVAL & CONDENSER INSTALLATION
7. CONDENSER INSTALLATION (CONT.) & HOOD LATCH INSTALLATION
8. PACKING LIST



**CONDENSER KIT
026671**

No.	QTY.	PART No.	DESCRIPTION
1.	1	03767-VUC	14 X 24 PARALLEL FLOW COND.
2.	4	18249-VUB	10-24 X 3/8 PAN HEAD SCREW
3.	4	18260-VUB	10-24 NUT W/STAR WASHER
4.	1	18266-VUB	#14 X 3/4 SHEET METAL SCREW
5.	1	18125-VUB	1/4 FLAT WASHER
6.	1	643055	BRACKET 68-72 NOVA TOP CONDENSER
7.	1	643056	BRACKET 68-72 NOVA BOTTOM CONDENSER

****BEFORE BEGINNING INSTALLATION, OPEN ALL PACKAGES AND CHECK CONTENTS OF SHIPMENT. PLEASE REPORT ANY SHORTAGES DIRECTLY TO VINTAGE AIR WITHIN 15 DAYS. AFTER 15 DAYS, VINTAGE AIR WILL NOT BE RESPONSIBLE FOR MISSING OR DAMAGED ITEMS.**

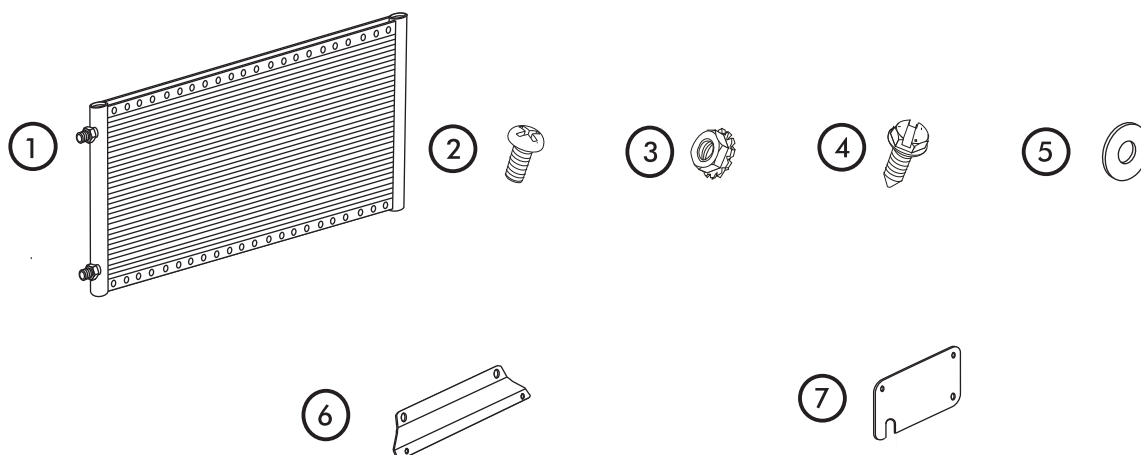

**NOTE: IMAGES MAY NOT DEPICT ACTUAL PARTS AND QUANTITIES.
REFER TO PACKING LIST FOR ACTUAL PARTS AND QUANTITIES.**



1968-72 NOVA

IMPORTANT NOTICE-PLEASE READ

THIS KIT WAS DEVELOPED BASED ON THE MEASUREMENTS BELOW, WHICH WERE TAKEN FROM A 1972 NOVA w/ FACTORY AIR CORE SUPPORT.

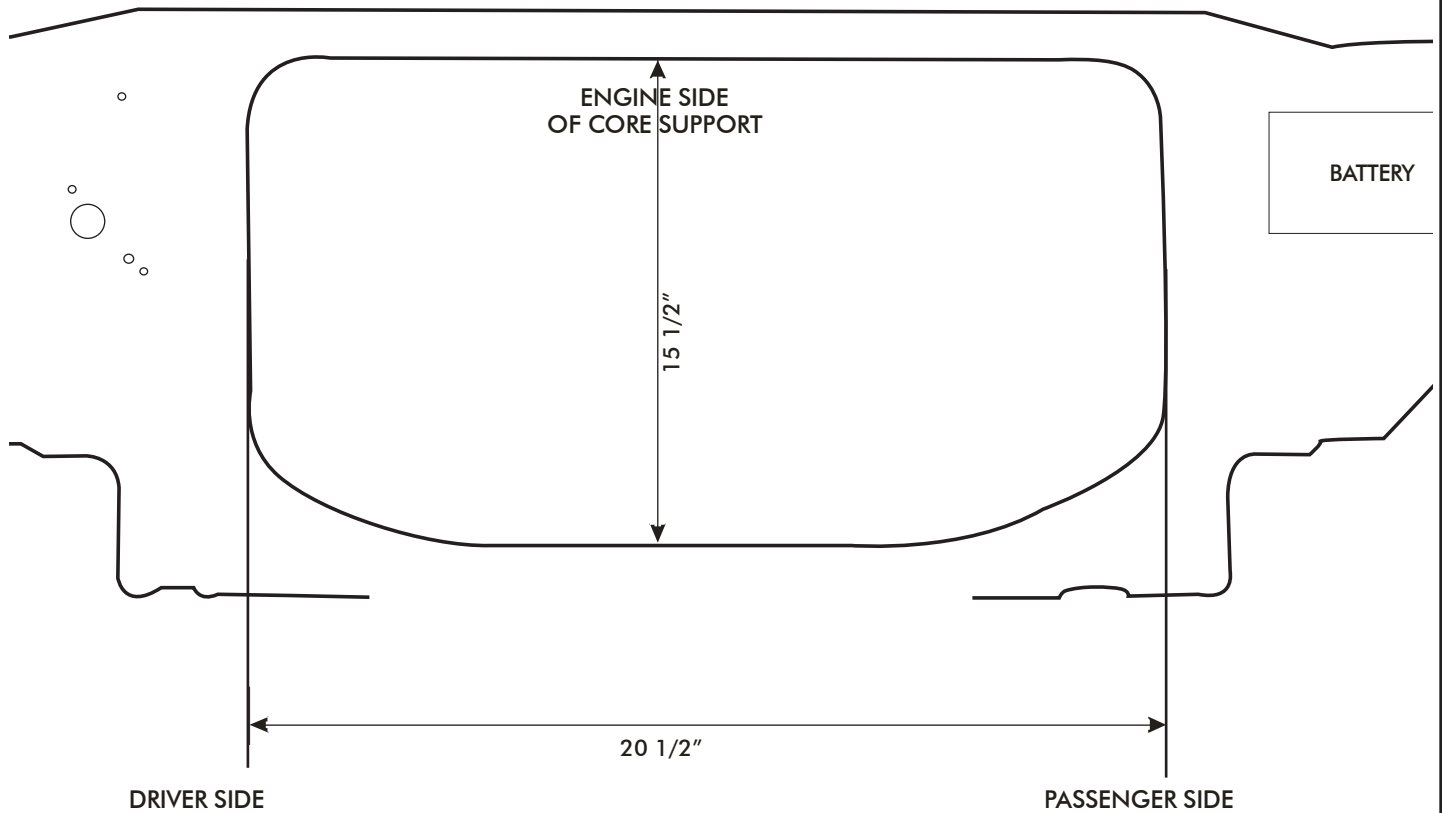



MOUNTING BRACKET INSTALLATION

- INSTALL TOP MOUNTING BRACKET ONTO CONDENSER USING (2) 10-24 X 3/8 PAN HEAD SCREWS AND (2) 10-24 NUTS WITH STAR WASHERS. **NOTE: BRACKET MOUNTS THROUGH THE 6TH & 13TH HOLES FROM THE LEFT SIDE OF THE CONDENSER (FRONT VIEW).**

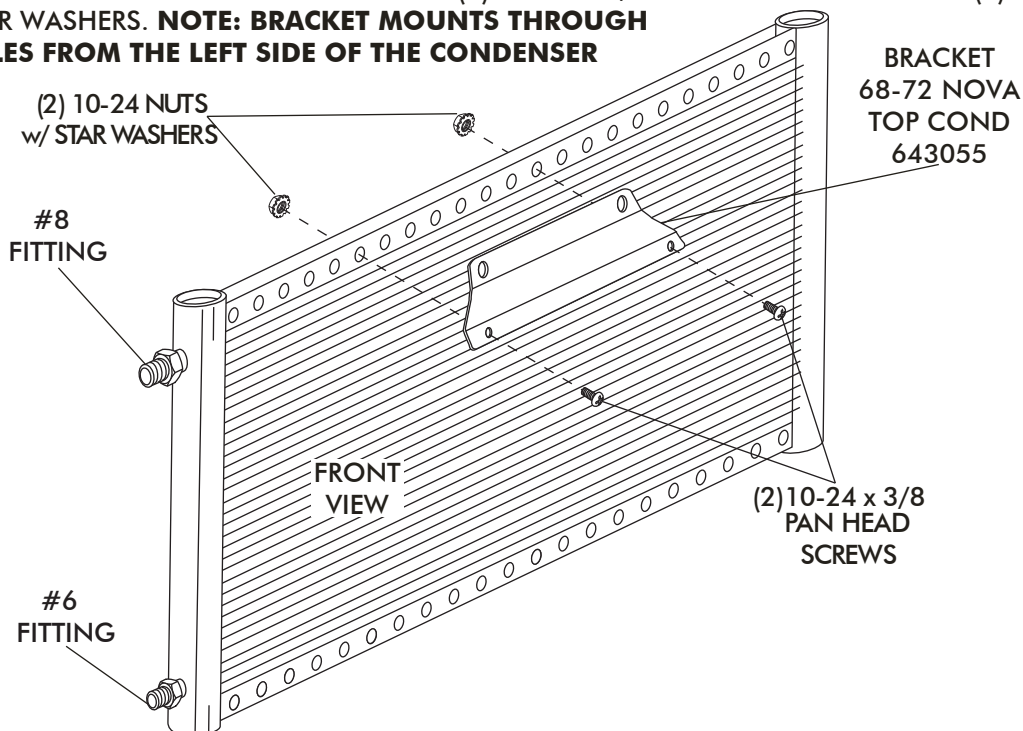

- INSTALL BOTTOM MOUNTING BRACKET ONTO CONDENSER USING (2) 10-24 X 3/8 PAN HEAD SCREWS AND (2) 10-24 NUTS WITH STAR WASHERS. **NOTE: BRACKET MOUNTS THROUGH THE 7TH & 11TH HOLES FROM THE LEFT SIDE OF THE CONDENSER (BACK VIEW).**

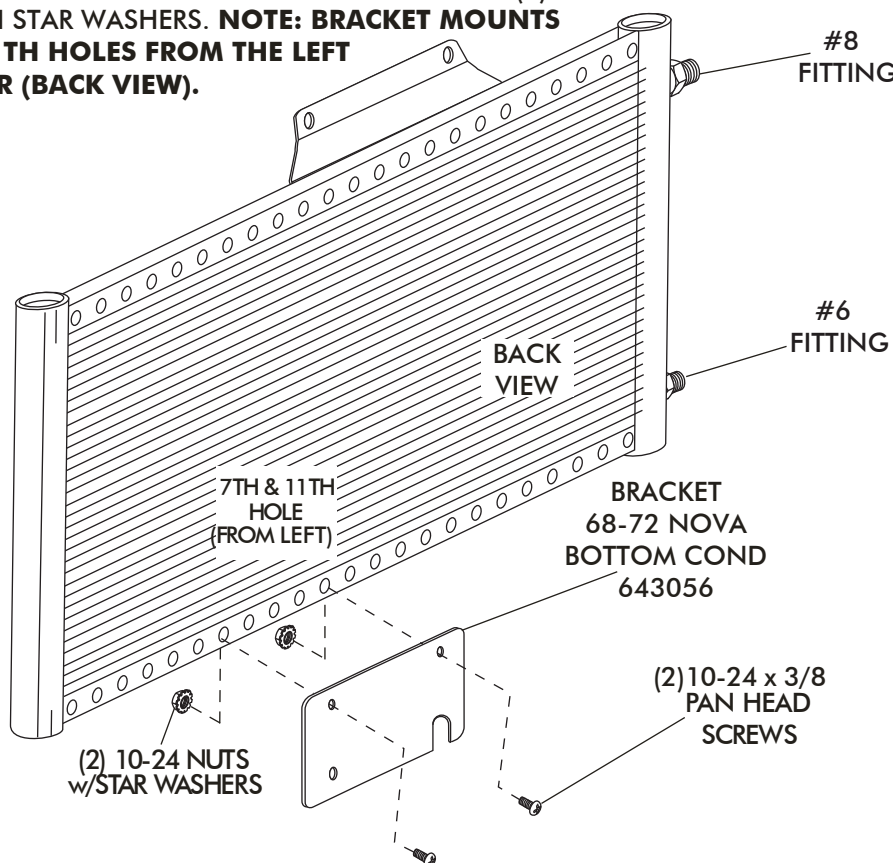



RADIATOR REMOVAL

- ☐ DRAIN RADIATOR, REMOVE UPPER AND LOWER RADIATOR HOSES AND REMOVE RADIATOR.

HOOD LATCH ASSEMBLY

- ☐ REMOVE OEM HOOD LATCH ASSEMBLY.

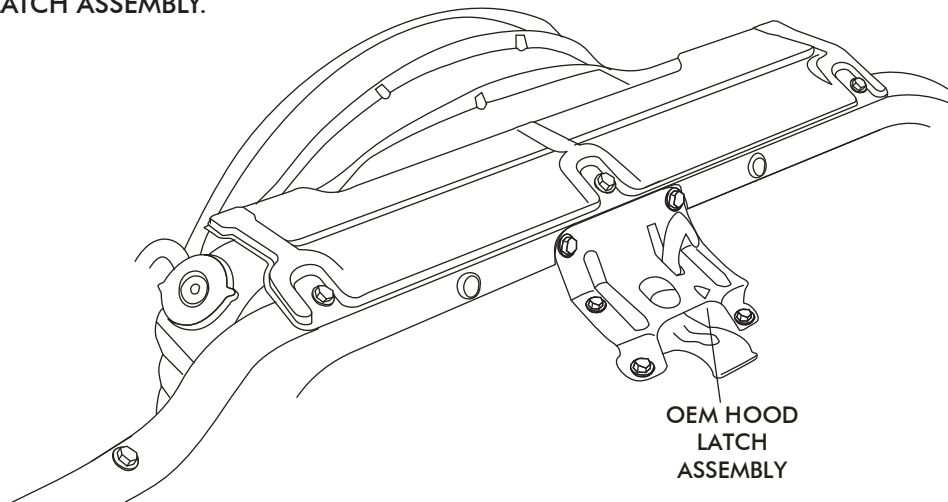

CONDENSER INSTALLATION

- ☐ INSTALL CONDENSER AS SHOWN BELOW.

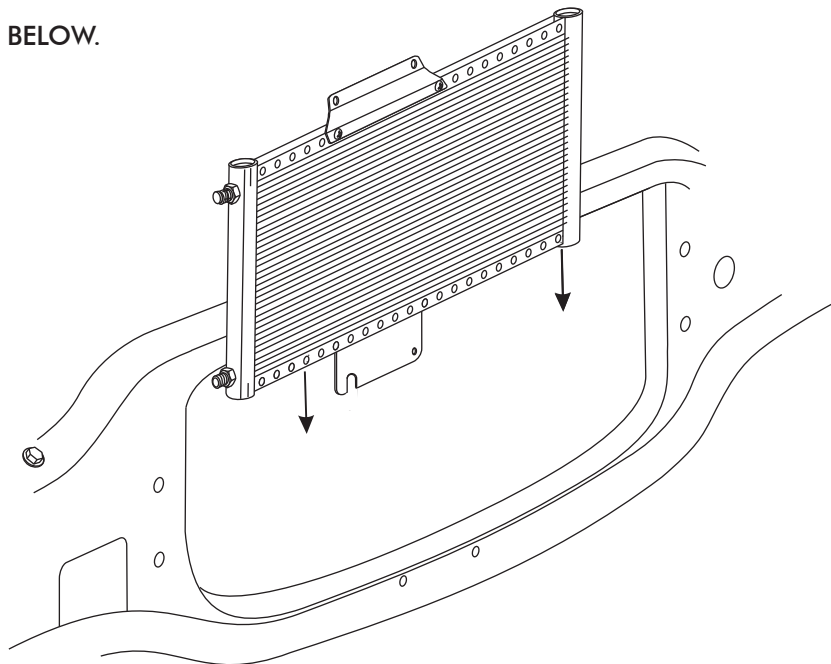



CONDENSER INSTALLATION (CONT.)

- ☐ SECURE THE BOTTOM PASSENGER SIDE OF THE CONDENSER TO THE CORE SUPPORT USING OEM BOLT.
- ☐ USING DRIVER SIDE MOUNTING HOLE AS A GUIDE, DRILL A 3/16" HOLE ON CORE SUPPORT. SECURE CONDENSER TO CORE SUPPORT USING #14 X 3/4 SHEET METAL SCREW W/FLAT WASHER.

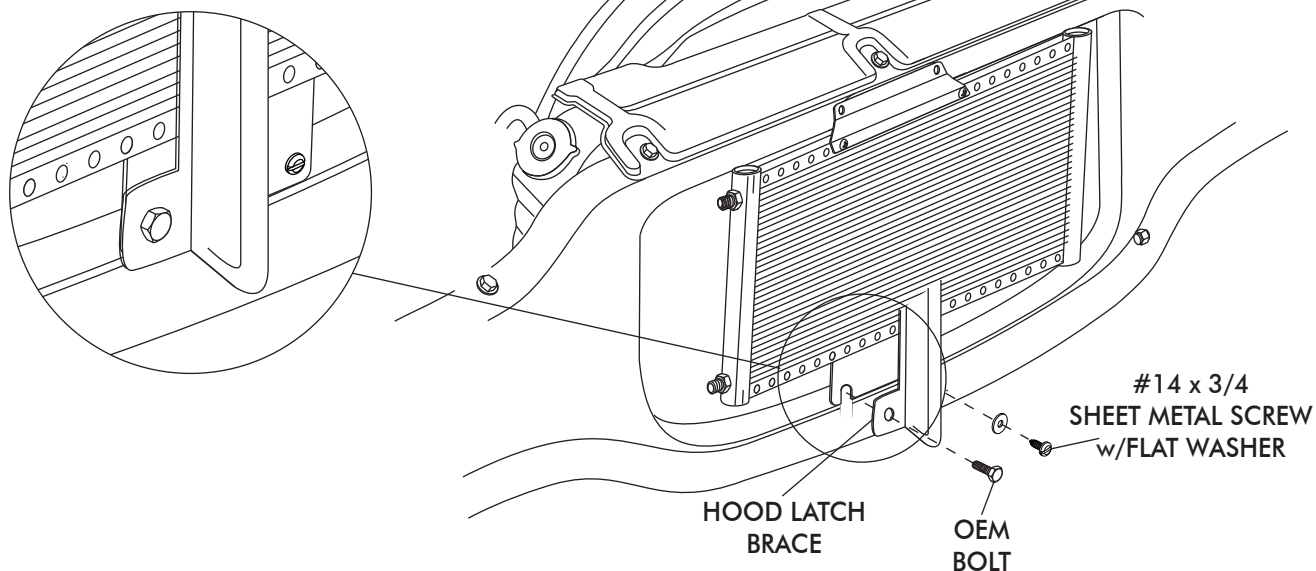

HOOD LATCH INSTALLATION

- ☐ REINSTALL HOOD LATCH ASSEMBLY USING OEM BOLTS. INSTALL OEM BOLTS THROUGH THE HOOD LATCH ASSEMBLY, CONDENSER, BRACKET, AND THROUGH THE CORE SUPPORT.

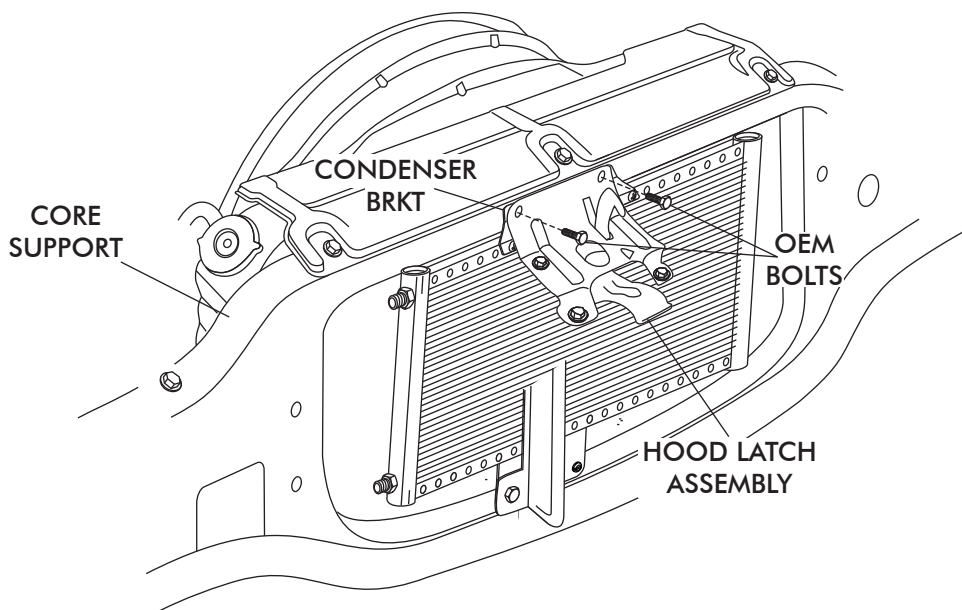



**CONDENSER KIT
026671**

No.	QTY.	PART No.	DESCRIPTION	
1.	1	03767-VUC	14 X 24 PARALLEL FLOW COND.	_____
2.	4	18249-VUB	10-24 X 3/8 PAN HEAD SCREW	_____
3.	4	18260-VUB	10-24 NUT W/STAR WASHER	_____
4.	1	18266-VUB	#14 X 3/4 SHEET METAL SCREW	_____
5.	1	18125-VUB	1/4 FLAT WASHER	_____
6.	1	643055	BRACKET 68-72 NOVA TOP CONDENSER	_____
7.	1	643056	BRACKET 68-72 NOVA BOTTOM CONDENSER	_____

CHECKED BY: _____
 PACKED BY: _____
 DATE: _____

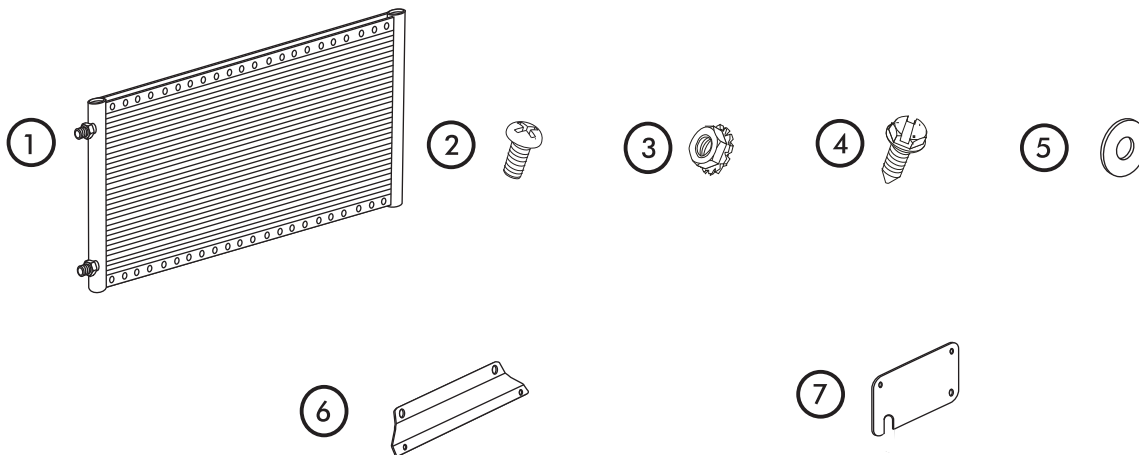

**NOTE: IMAGES MAY NOT DEPICT ACTUAL PARTS AND QUANTITIES.
 REFER TO PACKING LIST FOR ACTUAL PARTS AND QUANTITIES.**