

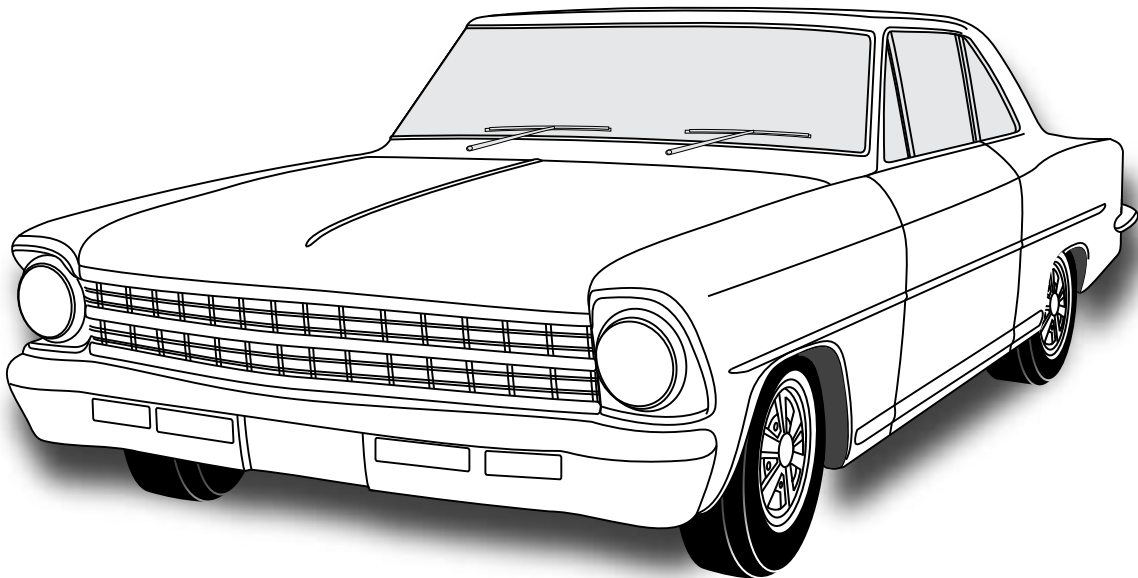

an ISO 9001:2000 Registered Company

1962-67 CHEVY NOVA

CONDENSER WITH DRIER
022665



18865 GOLL ST. - SAN ANTONIO, TX. - 78266 ph.210-654-7171 - fax 210-654-3113



Table of Contents

PAGES

1. COVER
2. TABLE OF CONTENTS
3. PACKING LIST
4. 66-67 NOVA INFORMATION PAGE, HOOD LATCH MODIFICATION
66 NOVA ONLY
5. 62-65 NOVA INFORMATION PAGE
6. CORE SUPPORT MODIFICATION
7. MOUNTING BRACKET AND CONDENSER INSTALLATION
8. HARDLINE INSTALLATION
9. DRIER AND SAFETY SWITCH INSTALLATION
10. HARDLINE TEMPLATE PAGE
11. CONDENSER KIT PACKING LIST



CONDENSER KIT 022665

No.	QTY.	PART No.	DESCRIPTION
1.	1	03764-VUC	SUPER FLOW CONDENSER 14 x 18
2.	1	091965	HARDLINE 62-67 NOVA #8 COND
3.	1	07321-VUC	DRIER (2-PORT)
4.	2	07113-VUB	DRIER CLAMP
5.	8	18260-VUB	10-24 NUT w/STAR WASHER
6.	2	18247-VUB	#10 x 1/2 SHEET METAL SCREW
7.	8	18249-VUB	10-24 x 3/8" PH PAN HEAD SCREW
8.	2	33857-VUF	#6 O-RING
9.	2	18610-VUB	5/16 LOCKWASHER
10.	8	18125-VUB	.250 ID x .750 OD FLAT WASHER
11.	4	18148-VUB	5/16 HEX NUT
12.	4	18308-VUB	5/16 x 1" HEX BOLT
13.	1	091964	HARDLINE 62-67 NOVA #6 COND/DRIER
14.	1	644676-PCA	62-67 NOVA TOP PS COND BRKT ASM
15.	1	644678-PCA	62-67 NOVA TOP DS COND BRKT ASM
16.	1	644677-PCA	62-67 NOVA BOTTOM PS COND BRKT ASM
17.	1	644679-PCA	62-67 NOVA BOTTOM DS COND BRKT ASM
18.	1	33134-VUI	2 HOLE GROMMET
19.	1	33858-VUF	#8 O-RING
20.	1	11079-VUS	MALE BINARY SWITCH
21.	1	23135-VUW	COMPRESSOR LEAD

****BEFORE BEGINNING INSTALLATION OPEN ALL PACKAGES AND CHECK CONTENTS OF SHIPMENT PLEASE REPORT ANY SHORTAGES DIRECTLY TO VINTAGE AIR WITHIN 15 DAYS. AFTER 15 DAYS, VINTAGE AIR WILL NOT BE RESPONSIBLE FOR MISSING OR DAMAGED ITEMS.**

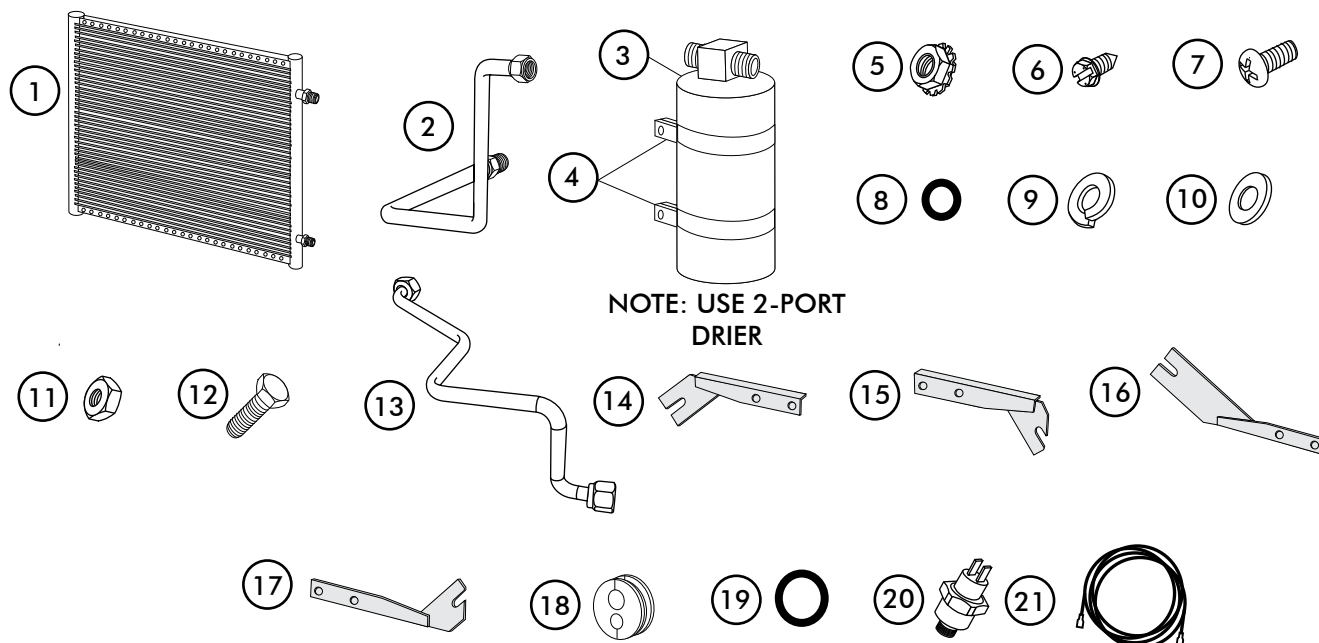



1966-67 NOVA

IMPORTANT NOTICE-PLEASE READ

THIS KIT WAS DEVELOPED BASED ON THE MEASUREMENTS BELOW, WHICH WERE TAKEN FROM A 1967 NOVA WITH FACTORY AIR CORE SUPPORT.

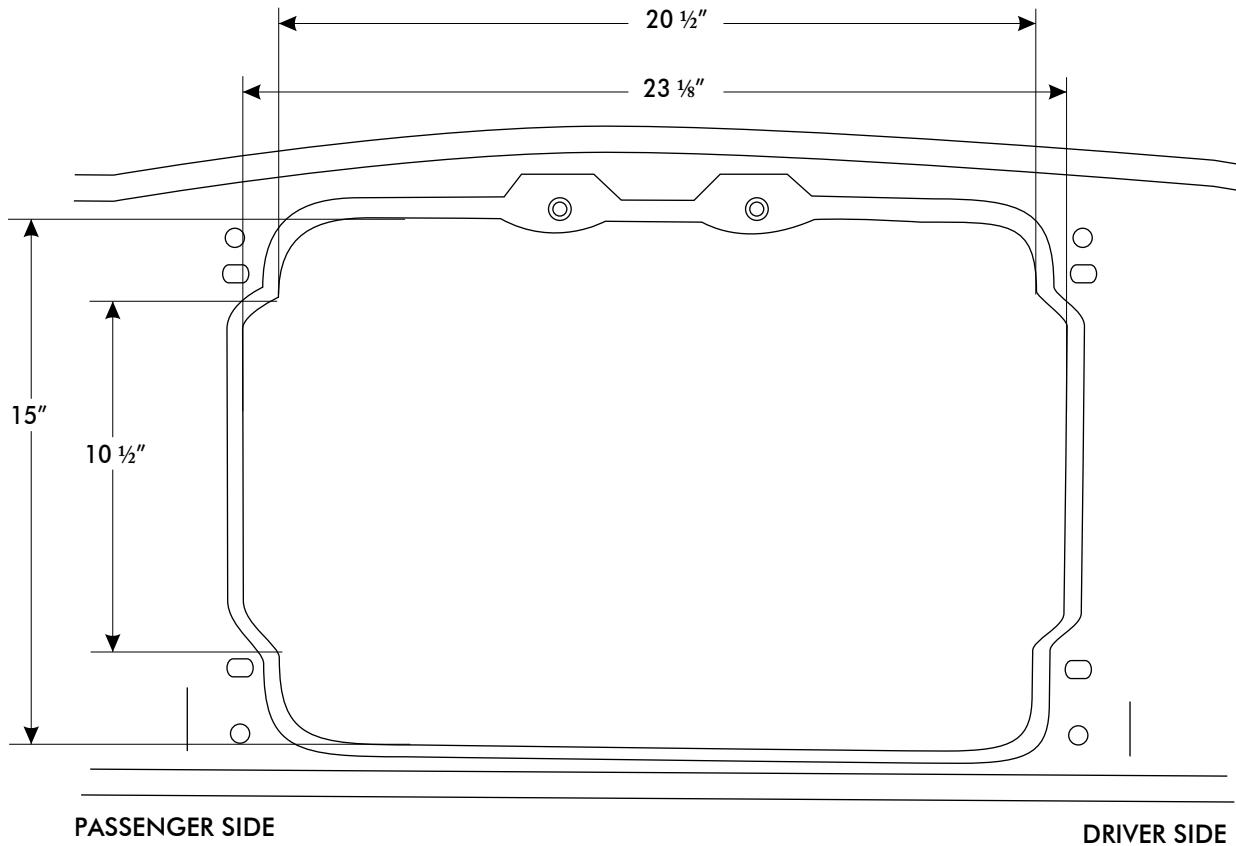

HOOD LATCH MODIFICATION 66 NOVA ONLY

- ☐ REMOVE HOOD LATCH ASSEMBLY FROM THE GRILLE/CORE SUPPORT.
- ☐ PLACE THE HOOD LATCH ASSEMBLY IN A BENCH VISE AS SHOWN BELOW.
- ☐ PLACING YOUR HANDS ON THE TOP OF HOOD LATCH ASSEMBLY, PULL FORWARD AS SHOWN (APPROX. 30°)
- ☐ RE-INSTALL HOOD LATCH ASSEMBLY.

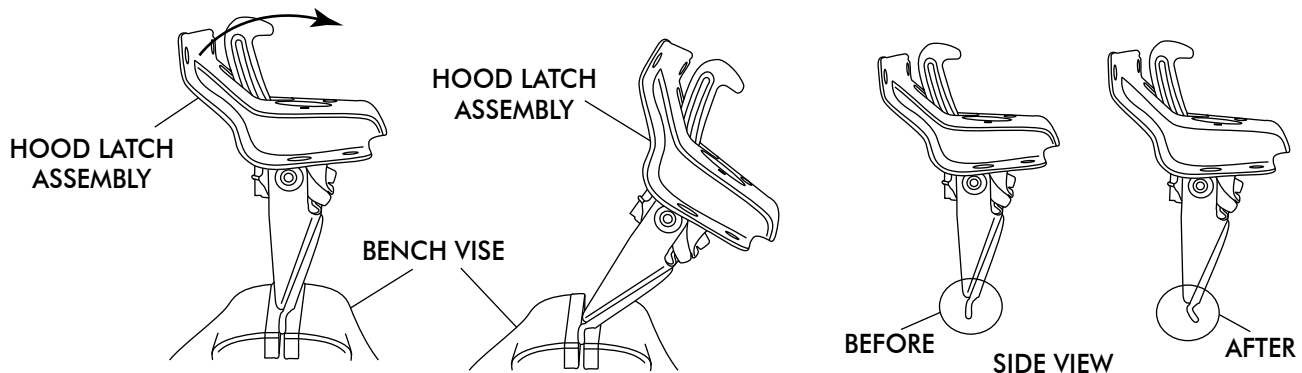



1962-65 NOVA

IMPORTANT NOTICE-PLEASE READ

THIS KIT WAS DEVELOPED BASED ON THE MEASUREMENTS BELOW, WHICH WERE TAKEN FROM A 1964 NOVA WITHOUT AIR CORE SUPPORT.

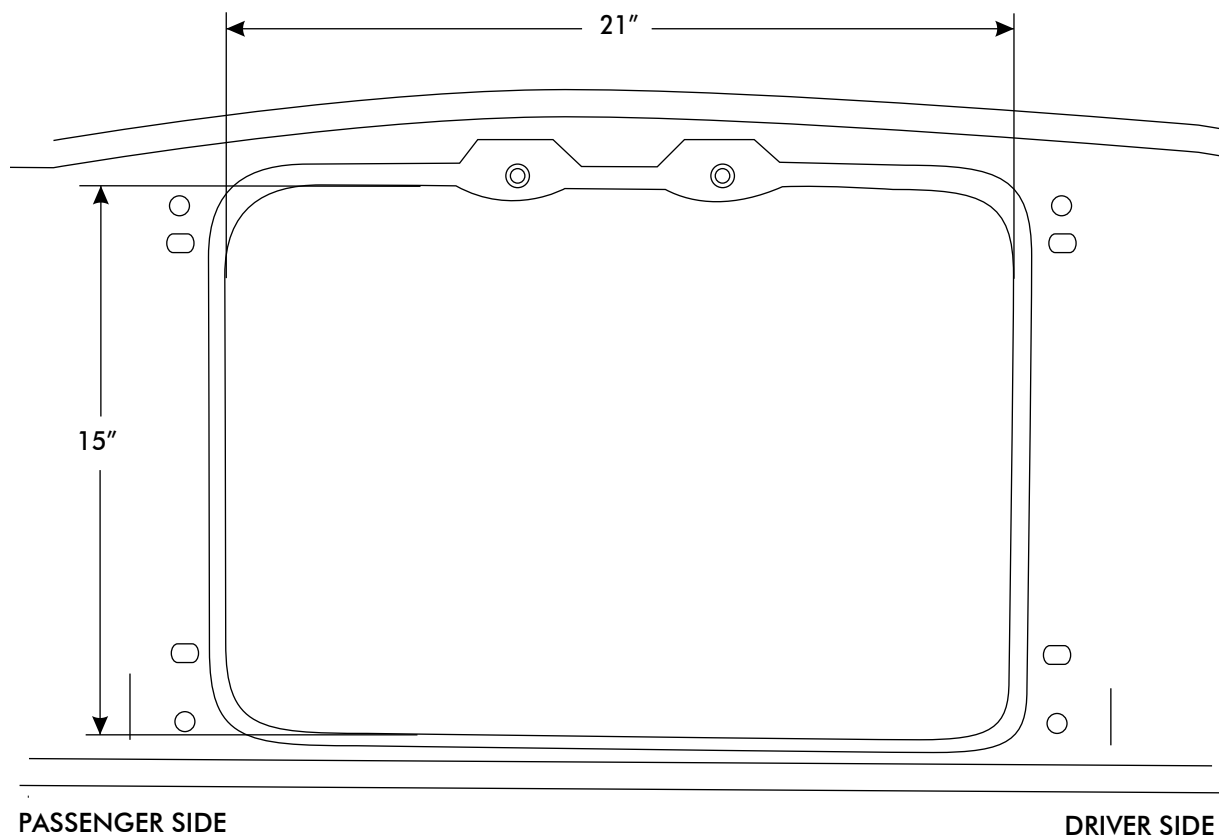



CORE SUPPORT MODIFICATION 62-65 NOVA

- ☐ MODIFY CORE SUPPORT AS SHOWN BELOW FOR HARDLINE CLEARANCE.

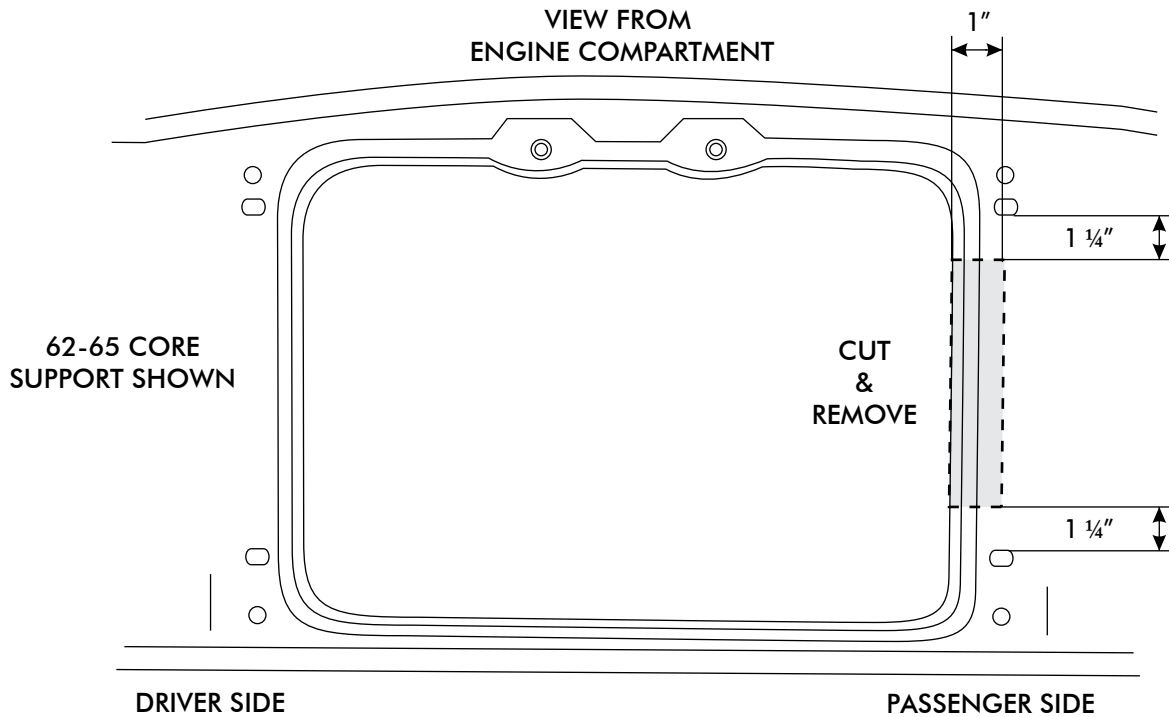

CORE SUPPORT MODIFICATION 62-67 NOVA

- ☐ ON NON AIR CORE SUPPORTS THERE ARE 3 DIMPLES POSITIONED AS SHOWN BELOW. LOCATE THE CENTER DIMPLE AND DRILL A 1 1/4" HOLE IN CORE SUPPORT.
- ☐ IF YOUR CORE SUPPORT DOES NOT HAVE THE DIMPLES, USE THE TEMPLATE PROVIDED ON PAGE 10.
- ☐ ALIGN THE TEMPLATE AS SHOWN BELOW AND DRILL A 1 1/4" HOLE IN THE CORE SUPPORT.

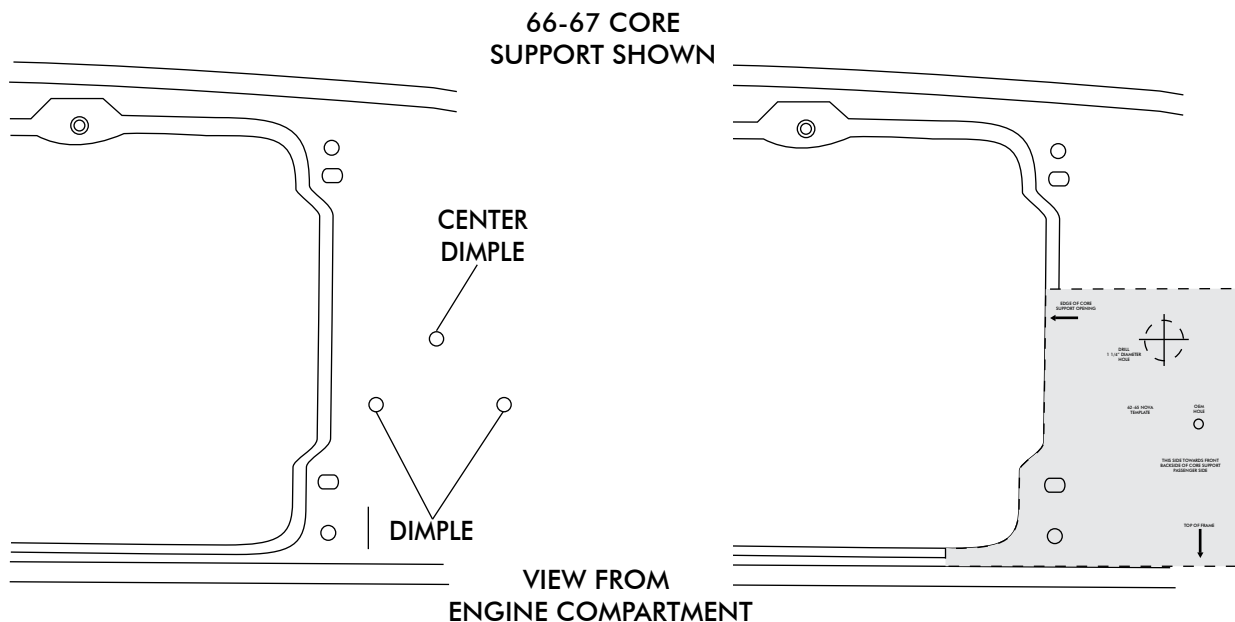



MOUNTING BRACKET INSTALLATION

- INSTALL CONDENSER MOUNTING BRACKET ON TO CONDENSER USING (8) 10-24 x 3/8 PAN HEAD SCREWS AND (8) 10-24 NUTS WITH STAR WASHERS.

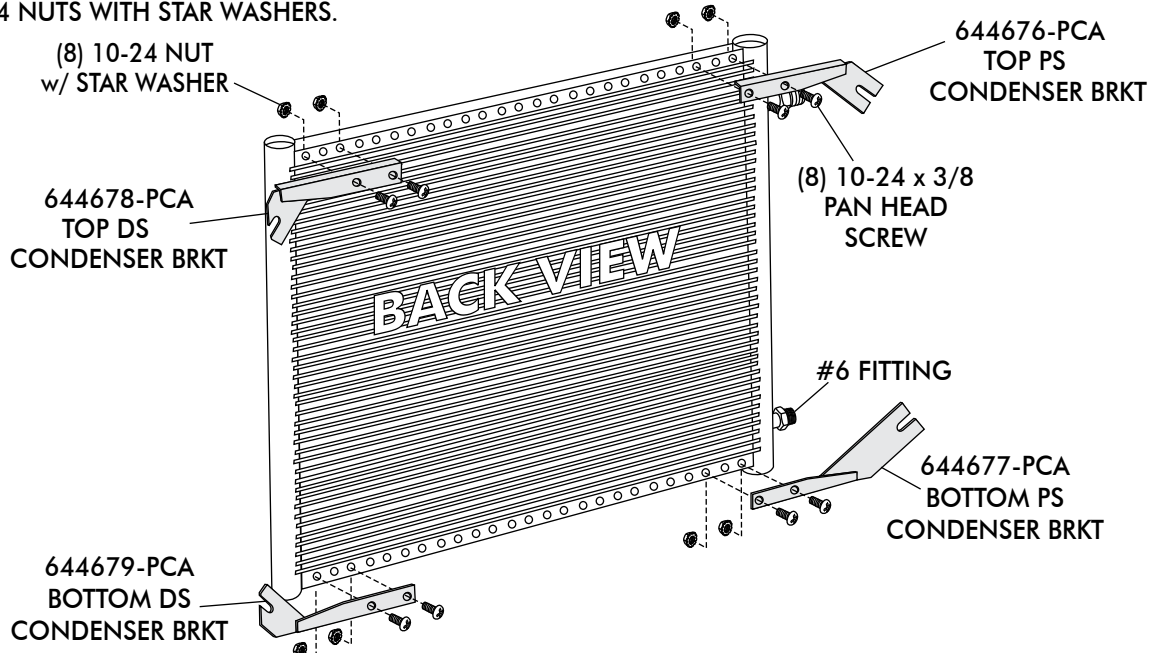

CONDENSER INSTALLATION

- REMOVE HOOD LATCH ASSEMBLY FROM THE GRILLE/CORE SUPPORT.
- DRAIN RADIATOR.
- REMOVE FAN, BELTS, UPPER AND LOWER RADIATOR HOSES.
- REMOVE RADIATOR.
- REMOVE OEM CONDENSER AND LINES IF EQUIPPED WITH FACTORY AIR. REMOVE OEM GROMMET IN CORE SUPPORT.
- USE A 7/16" DRILL BIT TO ENLARGE THE TWO DRIVER SIDE OEM RADIATOR MOUNTING HOLES.
- INSTALL CONDENSER ON THE BACK SIDE OF THE CORE SUPPORT AS SHOWN.
- ALIGN CONDENSER MOUNTING BRACKETS WITH OEM SLOTS IN CORE SUPPORT.
- WITH CONDENSER BRACKETS ALIGNED, SECURE THE DRIVER SIDE OF CONDENSER TO THE CORE SUPPORT USING (2) 5/16" x 1" HEX BOLTS WITH (4) FLAT WASHERS, (2) LOCK WASHER AND (2) 5/16 HEX NUTS.
- TEMPORARILY ATTACH THE PASSENGER SIDE OF THE CONDENSER TO THE CORE SUPPORT USING (2) 5/16" x 1" HEX BOLTS WITH FLAT WASHERS AND (2) 5/16 HEX NUTS AS OEM BOLTS WILL BE USED LATER TO INSTALL THE RADIATOR.

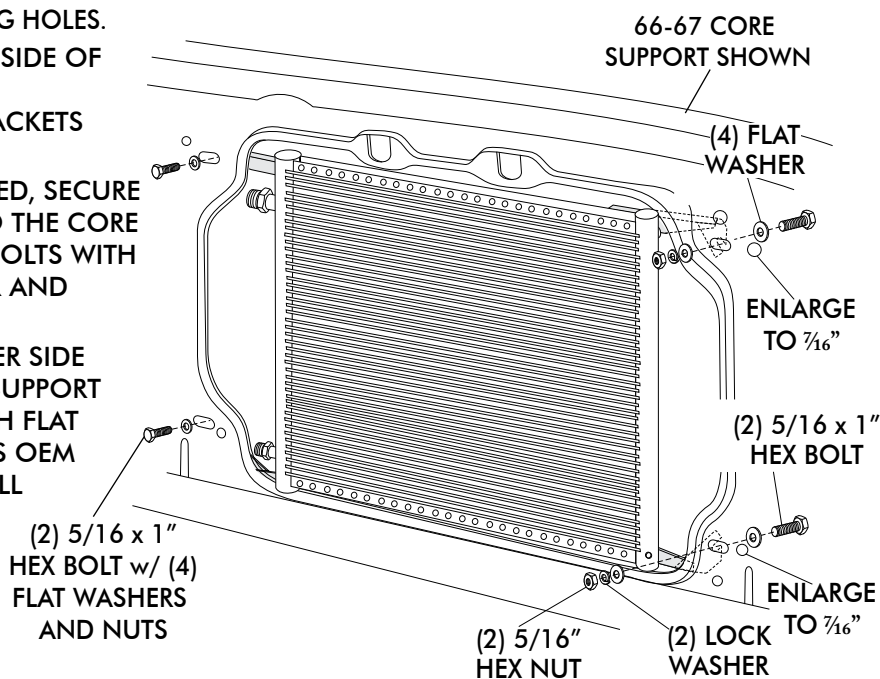



HARDLINE INSTALLATION

- ☐ WITH FACTORY AIR : FROM THE ENGINE COMPARTMENT SIDE OF THE CORE SUPPORT UNDER THE BATTERY BOX ROUTE THE #6 AND #8 HARDLINES THROUGH THE OEM HOLE IN THE CORE SUPPORT.
- ☐ NON AIR: FROM THE ENGINE COMPARTMENT SIDE OF THE CORE SUPPORT UNDER THE BATTERY BOX ROUTE THE #6 AND #8 HARDLINES THROUGH THE 1 1/4" HOLE IN CORE SUPPORT.
- ☐ WITH THE HARDLINES ROUTED THROUGH THE CORE SUPPORT, LUBRICATE A #6 AND #8 O-RING AND ATTACH THE HARDLINES TO THE CONDENSER.

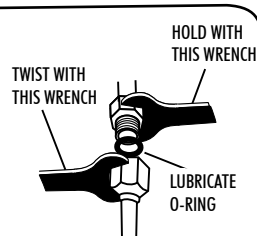

FOR A PROPER SEAL OF FITTINGS - INSTALL SUPPLIED O-RINGS AS SHOWN AND LUBRICATE WITH SUPPLIED OIL.

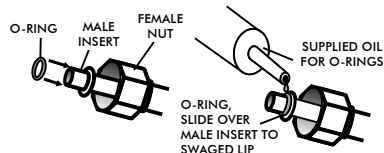

091965
HARDLINE 62-67
NOVA # 8 COND

091964
HARDLINE 62-67
NOVA # 6 COND/ DRIER

#8 O-RING

#6 O-RING

66-67 CORE
SUPPORT SHOWN

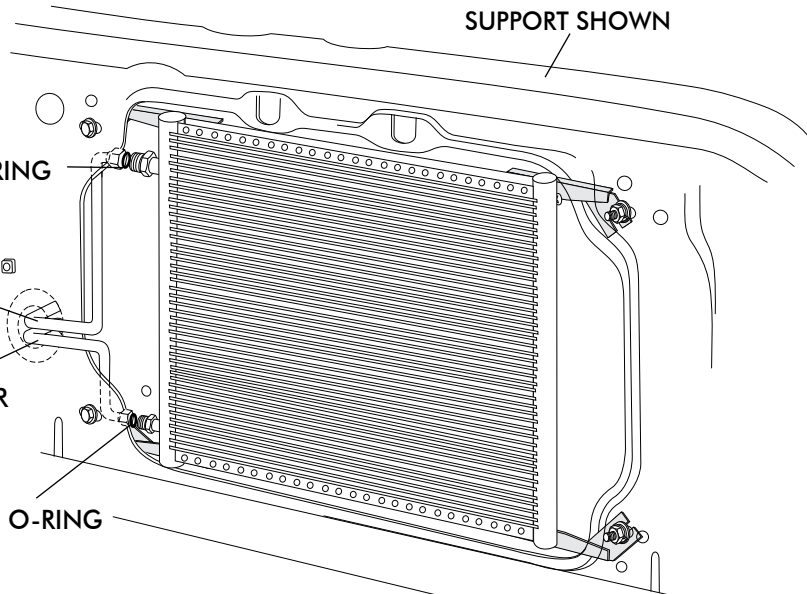

- ☐ WITH HARDLINES IN PLACE, INSTALL GROMMET.

66-67 CORE
SUPPORT SHOWN

33134-VUI
GROMMET

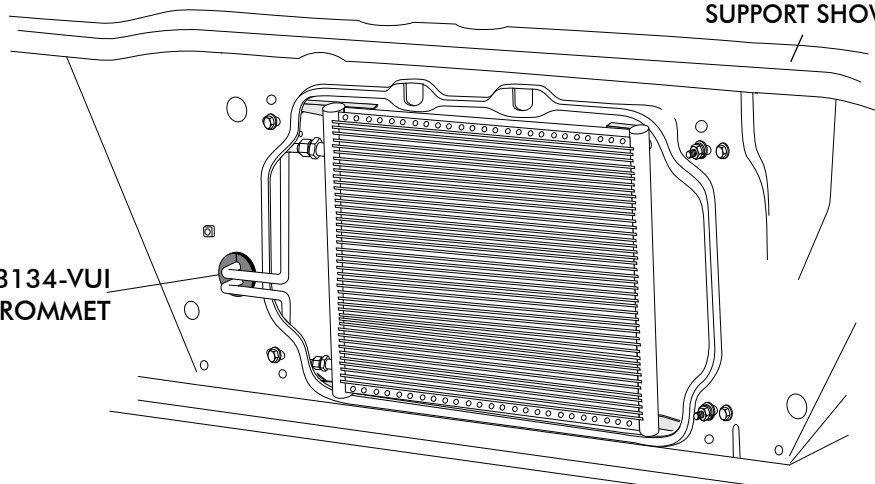



DRIER AND SAFETY SWITCH INSTALLATION

- ☐ LUBRICATE #6 O-RINGS AND INSTALL THE #6 DRIER TO CONDENSER HARDLINE TO DRIER AS SHOWN.
- ☐ INSTALL DRIER ON FENDER WELL WITH BRACKETS USING (2) #10 x ½ SHEET METAL SCREWS AS SHOWN BELOW.
- ☐ TIGHTEN FITTINGS.
- ☐ INSTALL MALE BINARY SWITCH ON DRIER AS SHOWN.

NOTE: IF USING AN ELECTRIC FAN- VINTAGE AIR RECOMMENDS REPLACING BINARY SAFETY SWITCH WITH TRINARY SAFETY SWITCH FOR PROPER SYSTEM OPERATION (PART# 11086-VUS). SWITCHES MUST BE REPLACED PRIOR TO CHARGING SYSTEM.

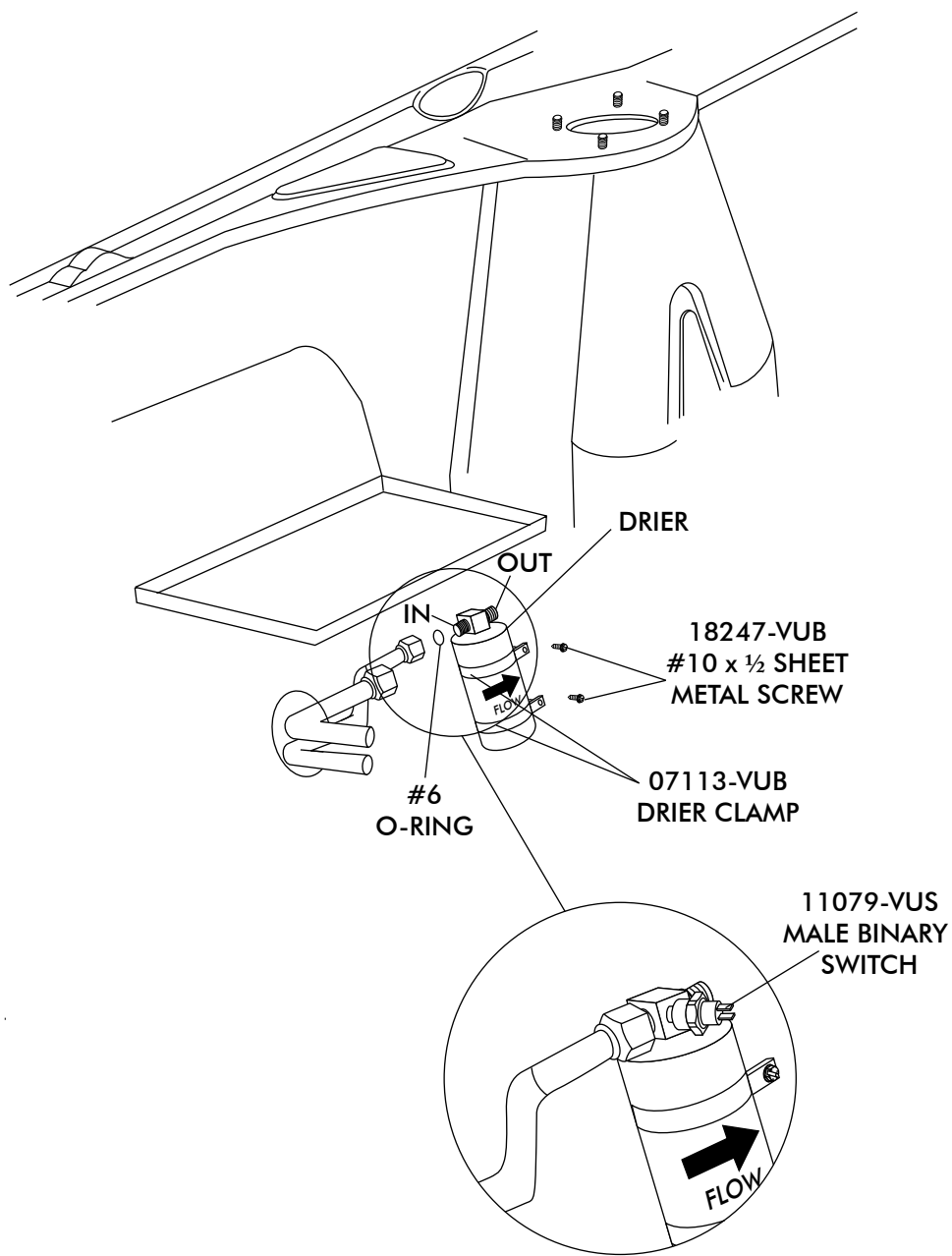

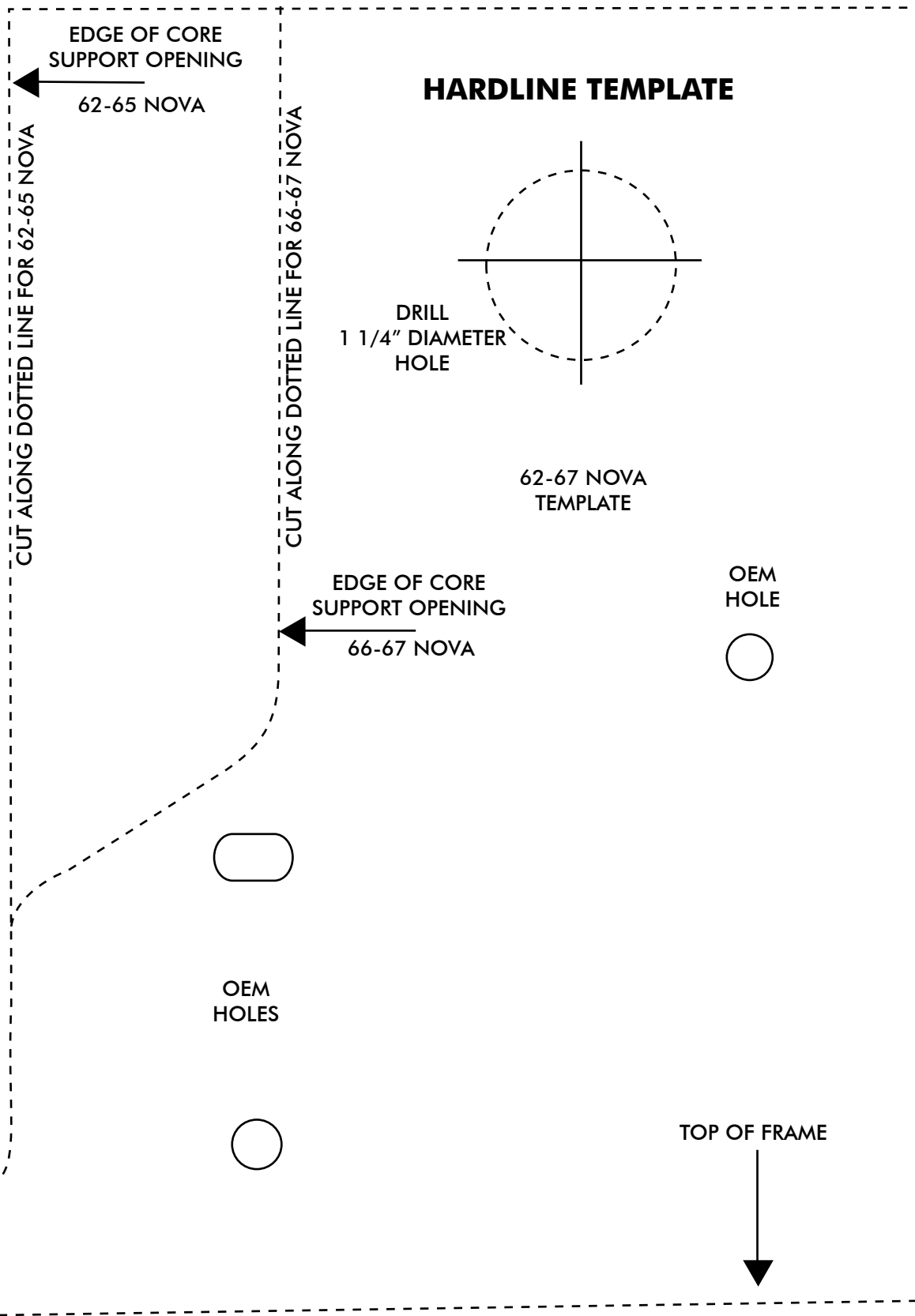



CONDENSER KIT 022665

No.	QTY.	PART No.	DESCRIPTION	
1.	1	03764-VUC	SUPER FLOW CONDENSER 14 x 18	_____
2.	1	091965	HARDLINE 62-67 NOVA #8 COND	_____
3.	1	07321-VUC	DRIER (2-PORT)	_____
4.	2	07113-VUB	DRIER CLAMP	_____
5.	8	18260-VUB	10-24 NUT w/STAR WASHER	_____
6.	2	18247-VUB	#10 x 1/2 SHEET METAL SCREW	_____
7.	8	18249-VUB	10-24 x 3/8" PH PAN HEAD SCREW	_____
8.	2	33857-VUF	#6 O-RING	_____
9.	2	18610-VUB	5/16 LOCKWASHER	_____
10.	8	18125-VUB	.250 ID x .750 OD FLAT WASHER	_____
11.	4	18148-VUB	5/16 HEX NUT	_____
12.	4	18308-VUB	5/16 x 1" HEX BOLT	_____
13.	1	091964	HARDLINE 62-67 NOVA #6 COND/DRIER	_____
14.	1	644676-PCA	62-67 NOVA TOP PS COND BRKT	_____
15.	1	644678-PCA	62-67 NOVA TOP DS COND BRKT	_____
16.	1	644677-PCA	62-67 NOVA BOTTOM PS COND BRKT	_____
17.	1	644679-PCA	62-67 NOVA BOTTOM DS COND BRKT	_____
18.	1	33134-VUI	2 HOLE GROMMET	_____
19.	1	33858-VUF	#8 O-RING	_____
20.	1	11079-VUS	MALE BINARY SWITCH	_____
21.	1	23135-VUW	COMPRESSOR LEAD	_____

CHECKED BY: _____
PACKED BY: _____
DATE: _____

