

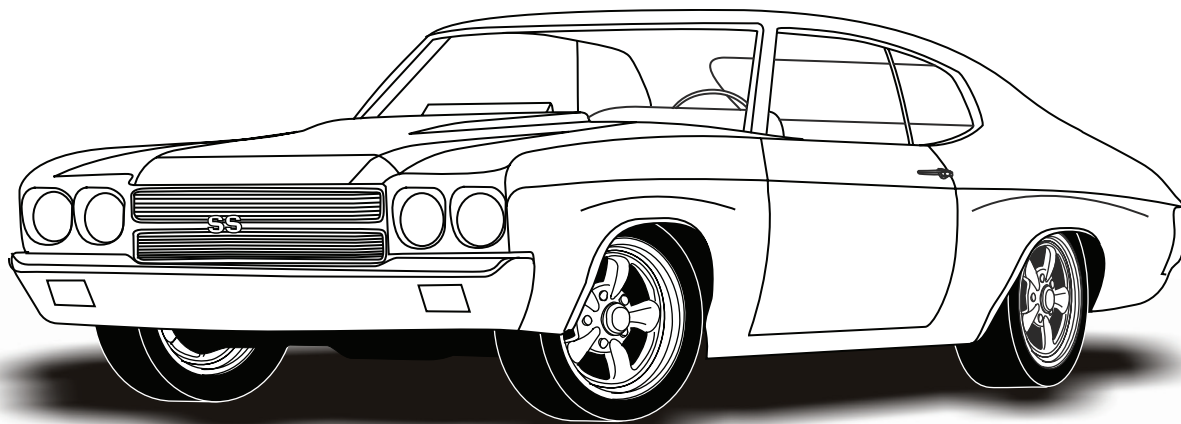

an ISO 9001:2008 Registered Company

1968-72 CHEVELLE

w & w/o AC CONDENSER KIT
026670



18865 GOLL ST. - SAN ANTONIO, TX. - 78266 ph.210-654-7171 - fax 210-654-3113



Table of Contents

PAGES

1. COVER
2. TABLE OF CONTENTS
3. PACKING LIST/PARTS DISCLAIMER
4. INFORMATION PAGE
5. CONDENSER BRACKET INSTALLATION
FIGURE 1 & 2
6. HOOD LATCH ASSY / RADIATOR REMOVAL / CONDENSER INSTALLATION
FIGURES 3 & 4
7. CONDENSER INSTALLATION CONT.
FIGURES 5 & 6
8. PACKING LIST



1968-72 CHEVELLE W & W/O AC CONDENSER KIT

1968-72 CHEVELLE w & w/o AC CONDENSER KIT PACKING LIST

**CONDENSER KIT
026670**

No.	QTY.	PART No.	DESCRIPTION
1.	1	03767-VUC	14" X 24" PARALLEL FLOW COND.
2.	4	18249-VUB	10/24" X 3/8" PAN HEAD
3.	4	18260-VUB	10/24" NUT w/STAR WASHER
4.	1	18266-VUB	#14 x 3/4 SHEETMETAL SCREW
5.	1	18611-VUB	5/16" FLAT WASHER
6.	1	644074	68-78 CAMARO/CHEVELLE COND. BRKT. TOP
7.	1	644071-FCB	68-73 CAMARO/CHEVELLE COND. BRKT. BTM

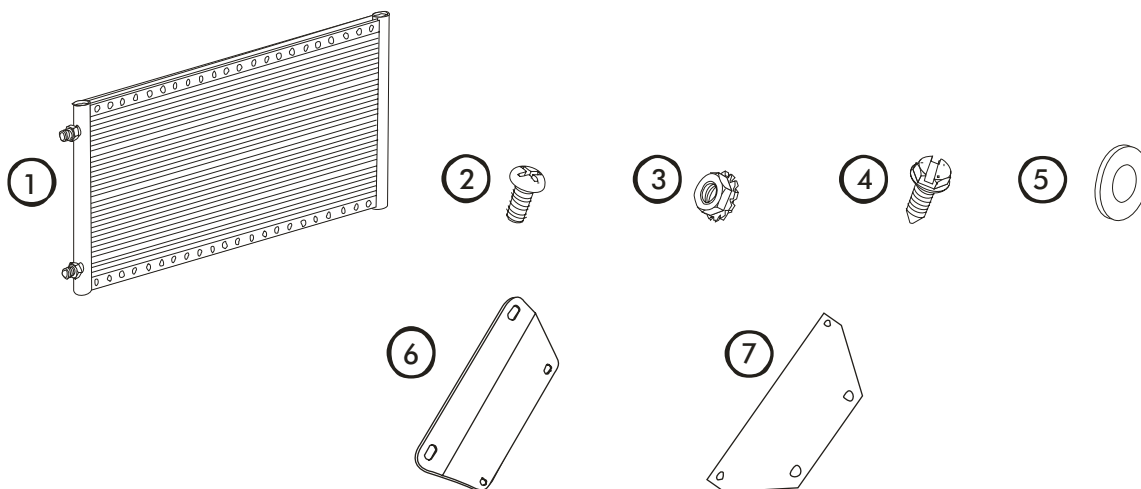

**NOTE: IMAGES MAY NOT DEPICT ACTUAL PARTS AND QUANTITIES.
REFER TO PACKING LIST FOR ACTUAL PARTS AND QUANTITIES**



1970 CHEVELLE

IMPORTANT NOTICE-PLEASE READ

THIS KIT WAS DEVELOPED BASED ON THE MEASUREMENTS BELOW, WHICH WERE TAKEN FROM A 1970 CHEVELLE w/ FACTORY AIR CORE SUPPORT.

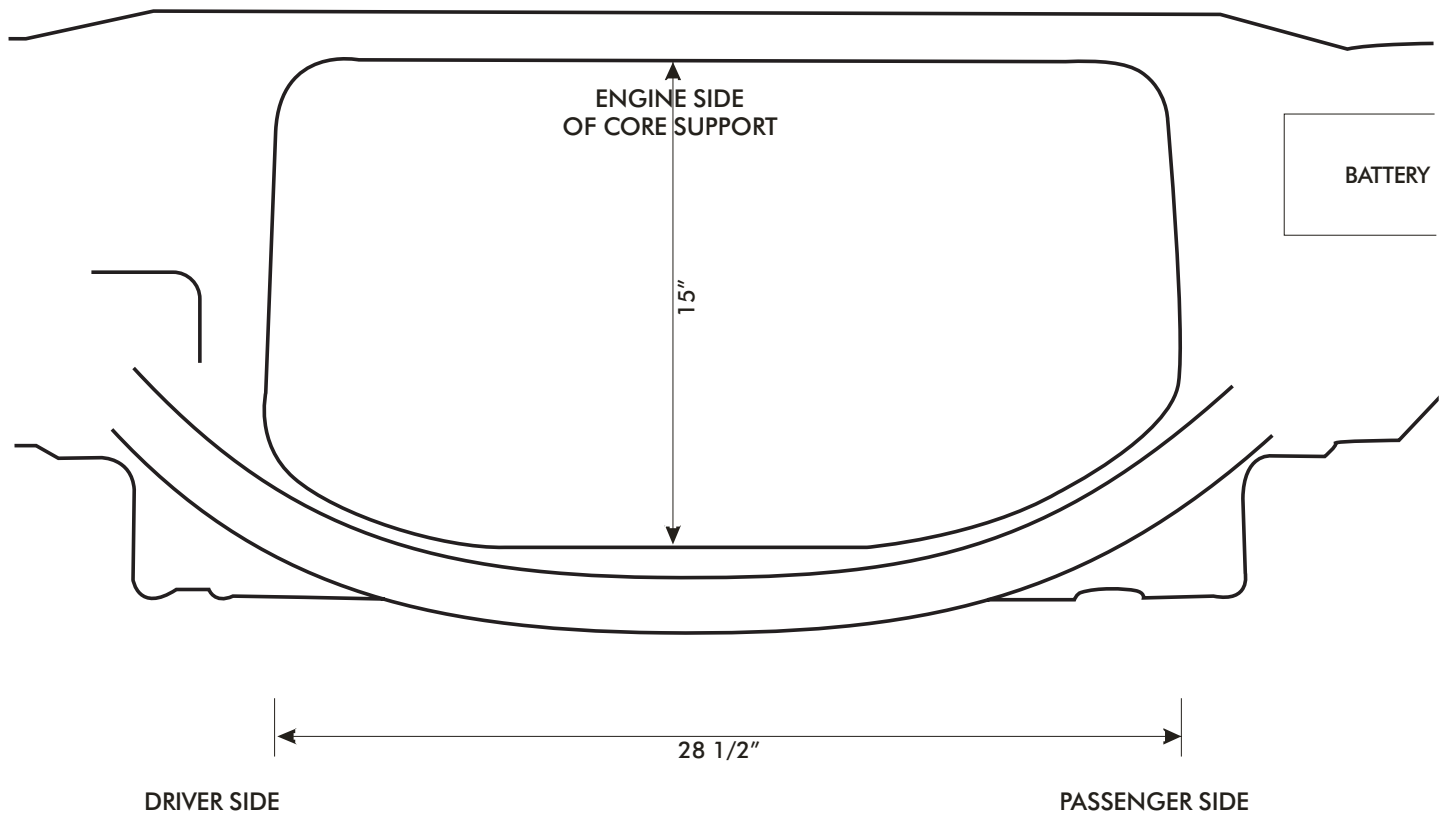



CONDENSER BRACKET INSTALLATION

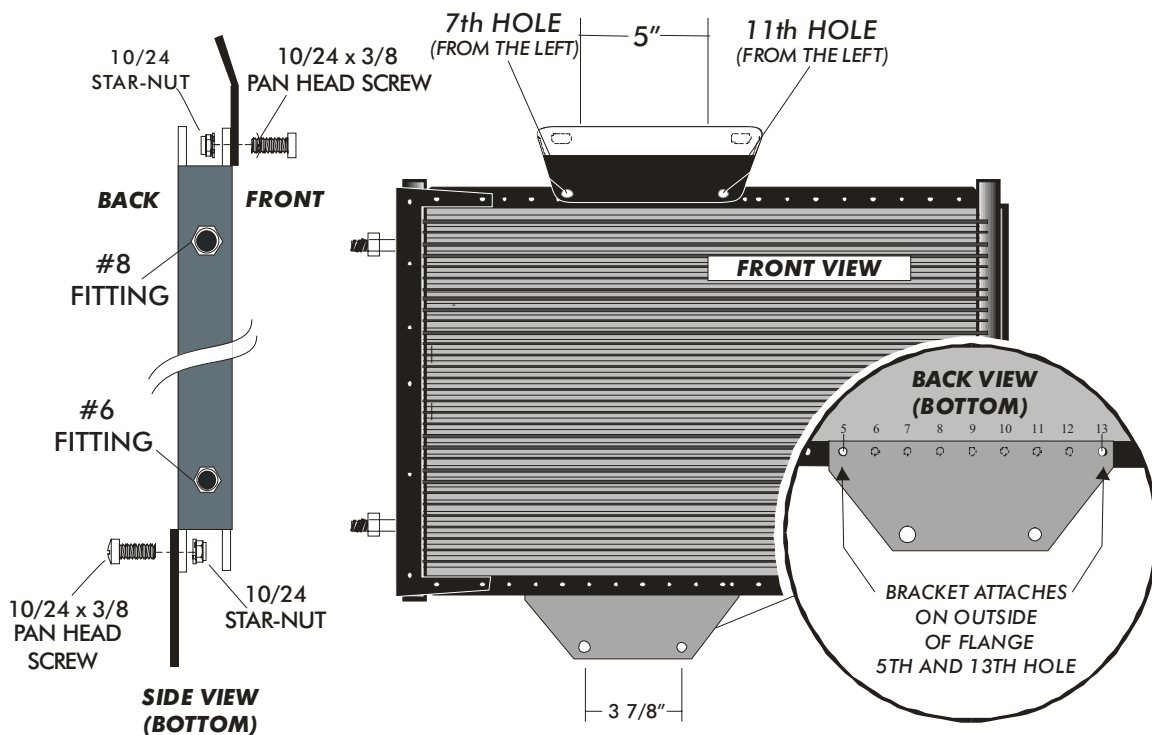

FIGURE 1

MOUNTING BRACKET INSTALLATION

- INSTALL TOP MOUNTING BRACKET ON TO CONDENSER USING (2) 10/24 X 3/8 PAN HEAD SCREWS AND (2) 10/24 NUTS WITH STAR WASHERS. SEE FIGURE 1 & 2. **NOTE: BRACKET MOUNT THROUGH THE 7TH & 11TH HOLE FROM THE LEFT SIDE OF THE CONDENSER.**

- INSTALL BOTTOM MOUNTING BRACKET ON TO CONDENSER USING (2) 10/24 X 3/8 PAN HEAD SCREWS AND (2) 10/24 NUTS WITH STAR WASHERS. SEE FIGURE 2 BELOW. **NOTE: BRACKET MOUNT THROUGH THE 5TH & 13TH HOLE FROM THE RIGHT SIDE OF THE CONDENSER. (BACK VIEW)**

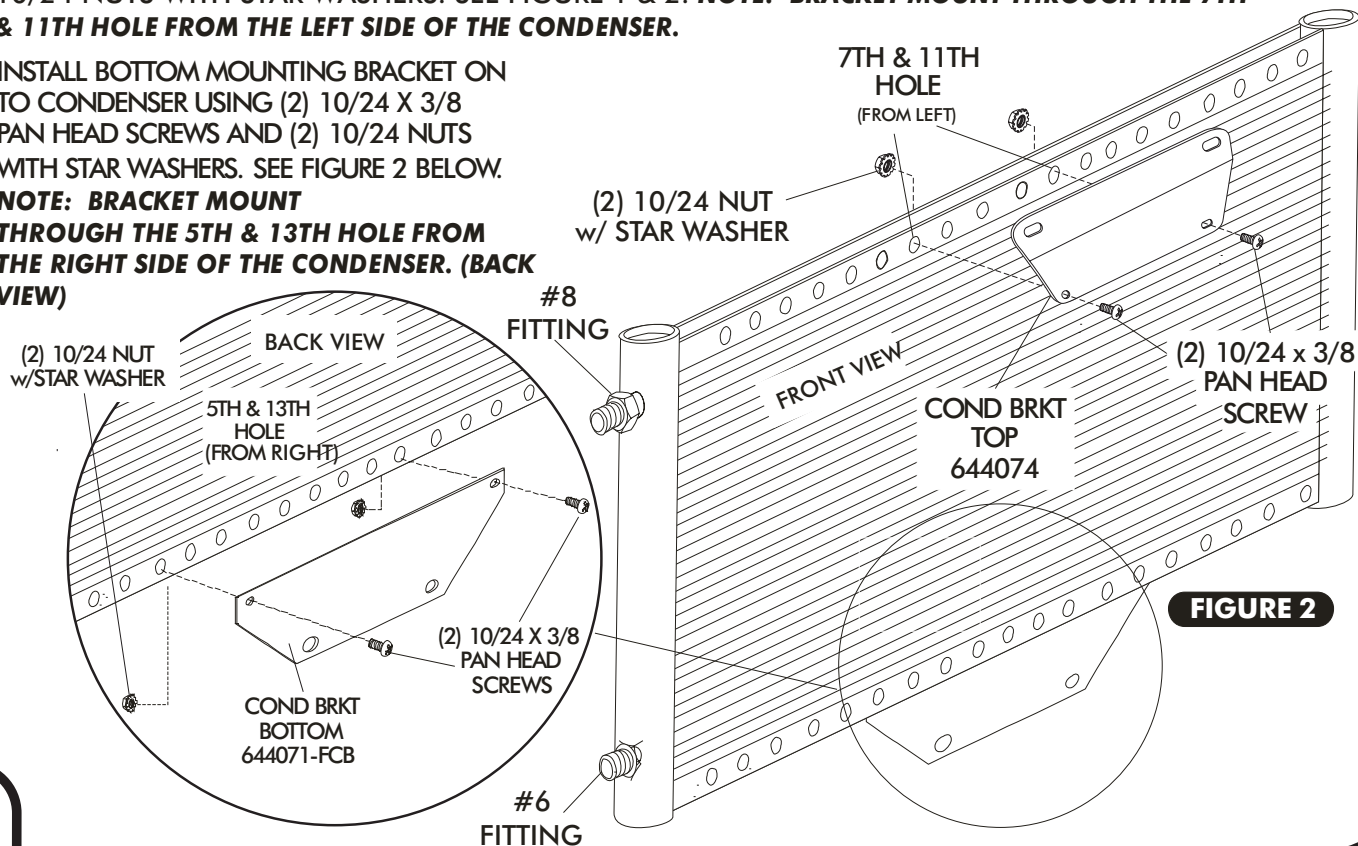
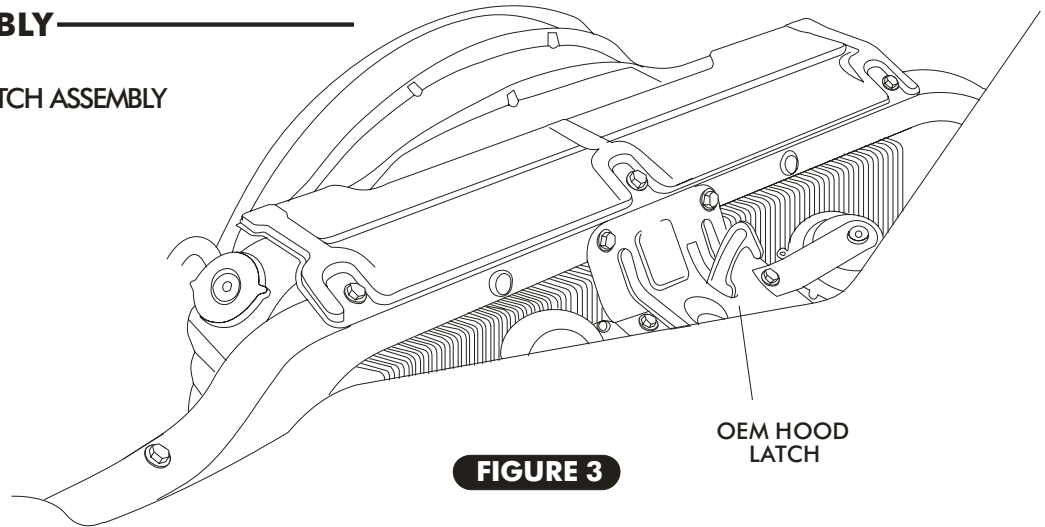

FIGURE 2



HOOD LATCH ASSEMBLY

- ☐ REMOVE OEM HOOD LATCH ASSEMBLY
SEE FIGURE 3 BELOW.



RADIATOR REMOVAL

- ☐ DRAIN RADIATOR REMOVE UPPER AND LOWER RADIATOR HOSES AND REMOVE RADIATOR.

CONDENSER INSTALLATION

- ☐ INSTALL CONDENSER AS SHOWN BELOW, LOWER CONDENSER WITH
FROM THE BACK SIDE OF THE CORE SUPPORT. (ENGINE
COMPARTMENT SIDE)
SEE FIGURE 4 BELOW.

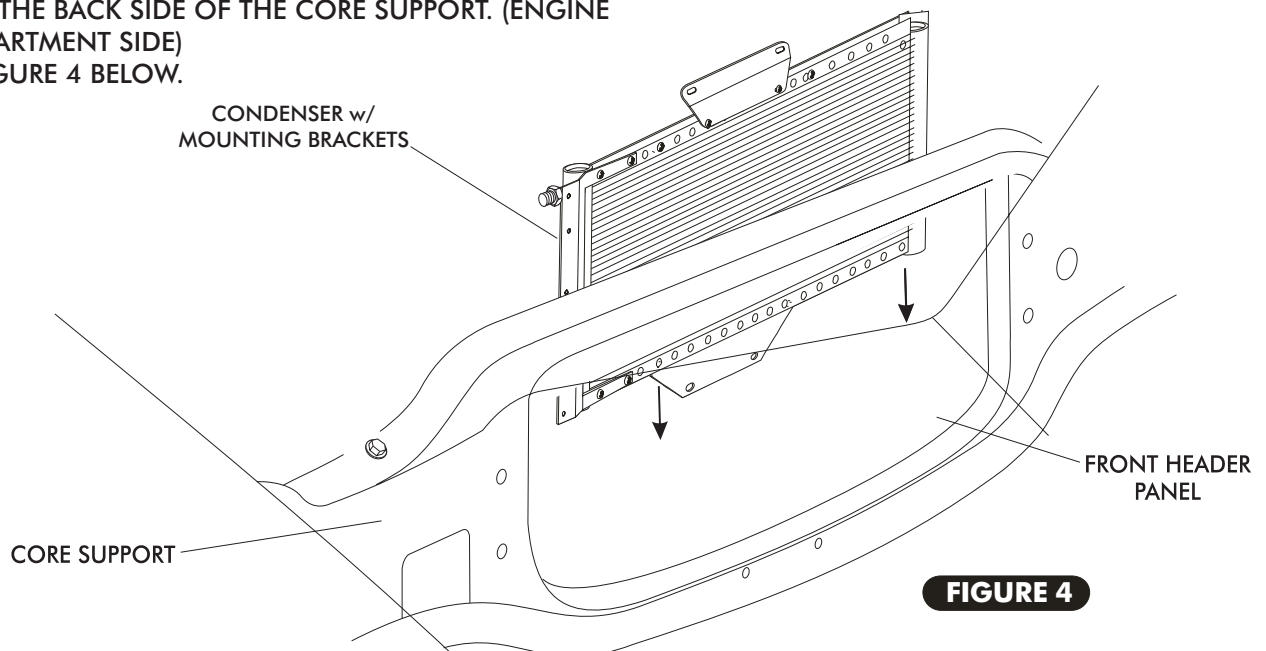

- ☐ **NOTE:** THE TOP MOUNTING BRACKET GOES ON THE FRONT SIDE OF THE CORE SUPPORT.



CONDENSER INSTALLATION CONT.

- ☐ SECURE THE BOTTOM PASSENGER SIDE OF THE CONDENSER TO THE CORE SUPPORT USING OEM BOLT.
- ☐ USE DRIVER SIDE MOUNTING HOLE AS A GUIDE DRILL 3/16" HOLE ON CORE SUPPORT. SECURE CONDENSER TO CORE SUPPORT USING #14 X 3/4 SHEETMETAL SCREW w/ 5/16 FLAT WASHERS SEE FIGURE 5 BELOW.

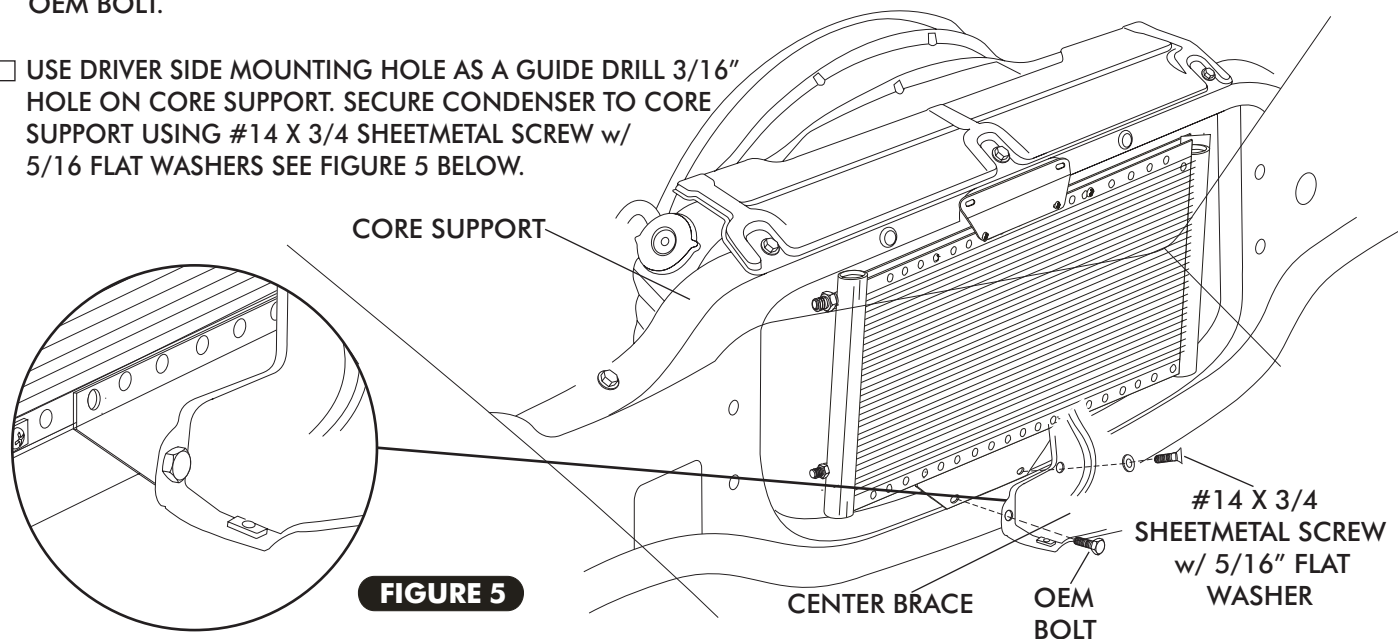

- ☐ USING OEM BOLTS RE-INSTALL HOOD LATCH ASSEMBLY, INSTALL OEM BOLTS THROUGH THE CONDENSER BRACKET, HOOD LATCH ASSEMBLY AND THROUGH THE CORE SUPPORT. SEE FIGURE 6 BELOW.

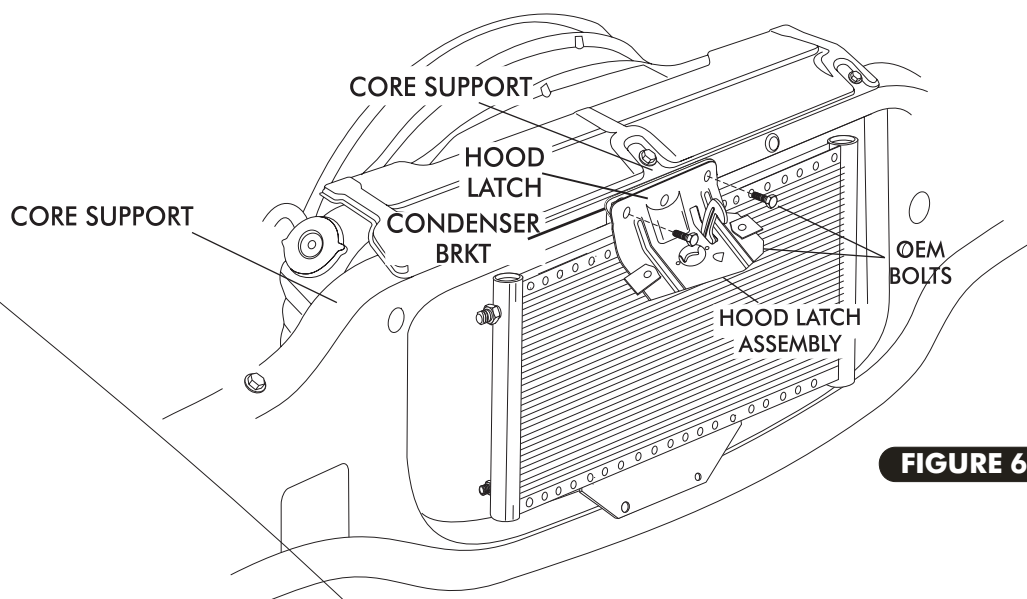



1968-72 CHEVELLE w & w/o AC CONDENSER KIT

1968-72 CHEVELLE w & w/o AC CONDENSER KIT PACKING LIST

**CONDENSER KIT
026670**

No.	QTY.	PART No.	DESCRIPTION	
1.	1	03767-VUC	14" X 24" PARALLEL FLOW COND.	_____
2.	4	18249-VUB	10/24" X 3/8" PAN HEAD	_____
3.	4	18260-VUB	10/24" NUT w/STAR WASHER	_____
4.	1	18266-VUB	#14 x 3/4 SHEETMETAL SCREW	_____
5.	1	18611-VUB	5/16" FLAT WASHER	_____
6.	1	644074	68-78 CAMARO/CHEVELLE COND. BRKT. TOP	_____
7.	1	644071-FCB	68-73 CAMARO/CHEVELLE COND. BRKT. BTM	_____

CHECKED BY: _____
PACKED BY: _____
DATE: _____

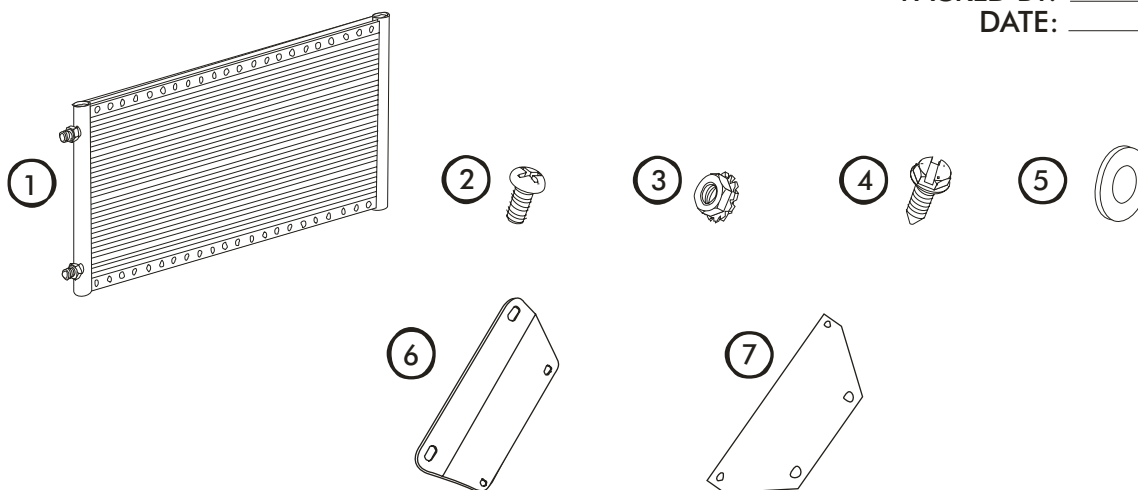

**NOTE: IMAGES MAY NOT DEPICT ACTUAL PARTS AND QUANTITIES.
REFER TO PACKING LIST FOR ACTUAL PARTS AND QUANTITIES**