

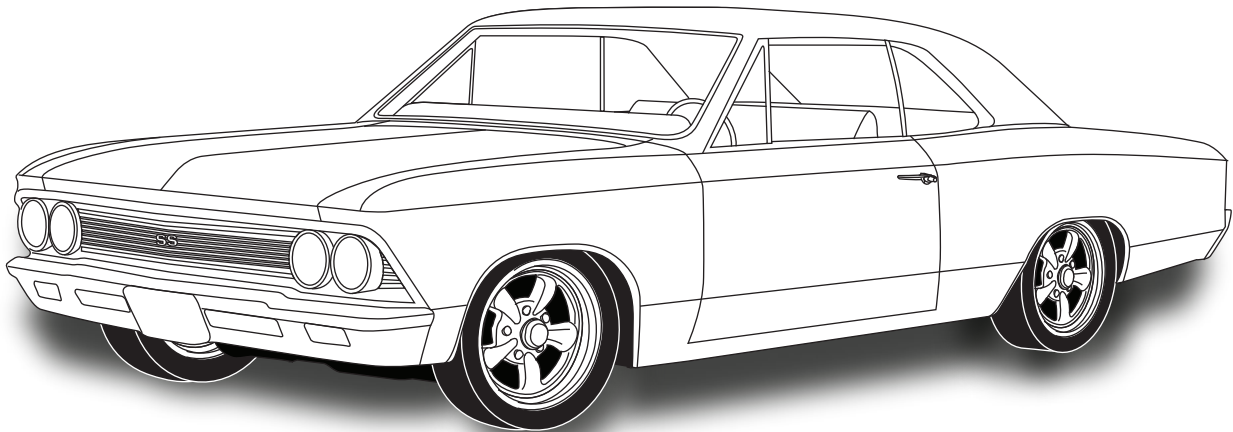

an ISO 9001:2000 Registered Company

# **1964-67 CHEVELLE**

w/wo AC CONDENSER KIT  
**026666**



18865 GOLL ST. - SAN ANTONIO, TX. - 78266 ph.210-654-7171 - fax 210-654-3113



## ***Table of Contents***

### PAGES

1. COVER
2. TABLE OF CONTENTS
3. PACKING LIST/PARTS DISCLAIMER
4. INFORMATION PAGE
5. CONDENSER BRACKET INSTALLATION  
FIGURE 1 & 2
6. RADIATOR REMOVAL/HOOD LATCH ASSEMBLY/CONDENSER  
INSTALLATION FIGURE 3 & 4
7. CONDENSER INSTALLATION CONT  
FIGURES 5 & 6
8. PACKING LIST



## 1964-67 CHEVELLE w/wo AC CONDENSER KIT

### CONDENSER KIT 026666

No.	QTY.	PART No.	DESCRIPTION
1.	1	03767-VUC	14" X 24" PARALLEL FLOW COND.
2.	6	18249-VUB	10/24" X 3/8" PAN HEAD
3.	6	18260-VUB	10/24" NUT w/STAR WASHER
4.	1	18266-VUB	#14 x 3/4 SHEETMETAL SCREW
5.	1	18611-VUB	5/16" FLAT WASHER
6.	2	64197-VCB	66-67 CHEVELLE TOP COND BRKT
7.	1	643057	66-67 CHEVELLE BOTTOM COND BRKT

**\*\* BEFORE BEGINNING INSTALLATION OPEN ALL PACKAGES AND CHECK CONTENTS OF SHIPMENT. PLEASE REPORT ANY SHORTAGES DIRECTLY TO VINTAGE AIR WITHIN 15 DAYS. AFTER 15 DAYS, VINTAGE AIR WILL NOT BE RESPONSIBLE FOR MISSING OR DAMAGED ITEMS.**

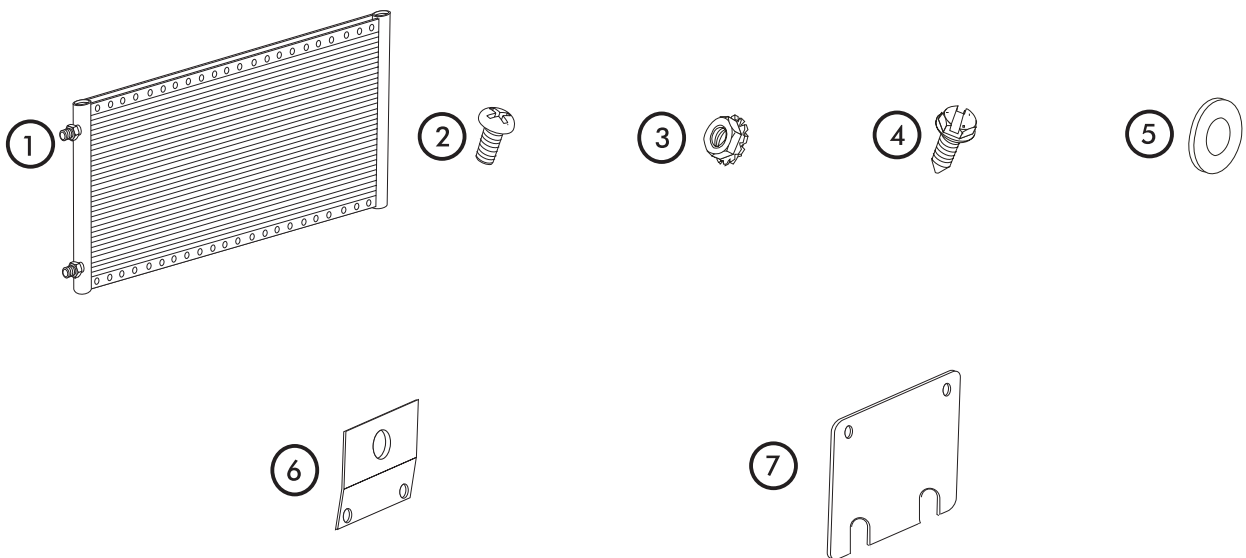

**NOTE: IMAGES MAY NOT DEPICT ACTUAL PARTS AND QUANTITIES.  
REFER TO PACKING LIST FOR ACTUAL PARTS AND QUANTITIES**



**1964-67 CHEVELLE** w/wo AC CONDENSER KIT

## 1964-67 CHEVELLE

### IMPORTANT NOTICE-PLEASE READ

THIS KIT WAS DEVELOPED BASED ON THE MEASUREMENTS BELOW, WHICH WERE TAKEN FROM A 1967 CHEVELLE w/ FACTORY AIR CORE SUPPORT.

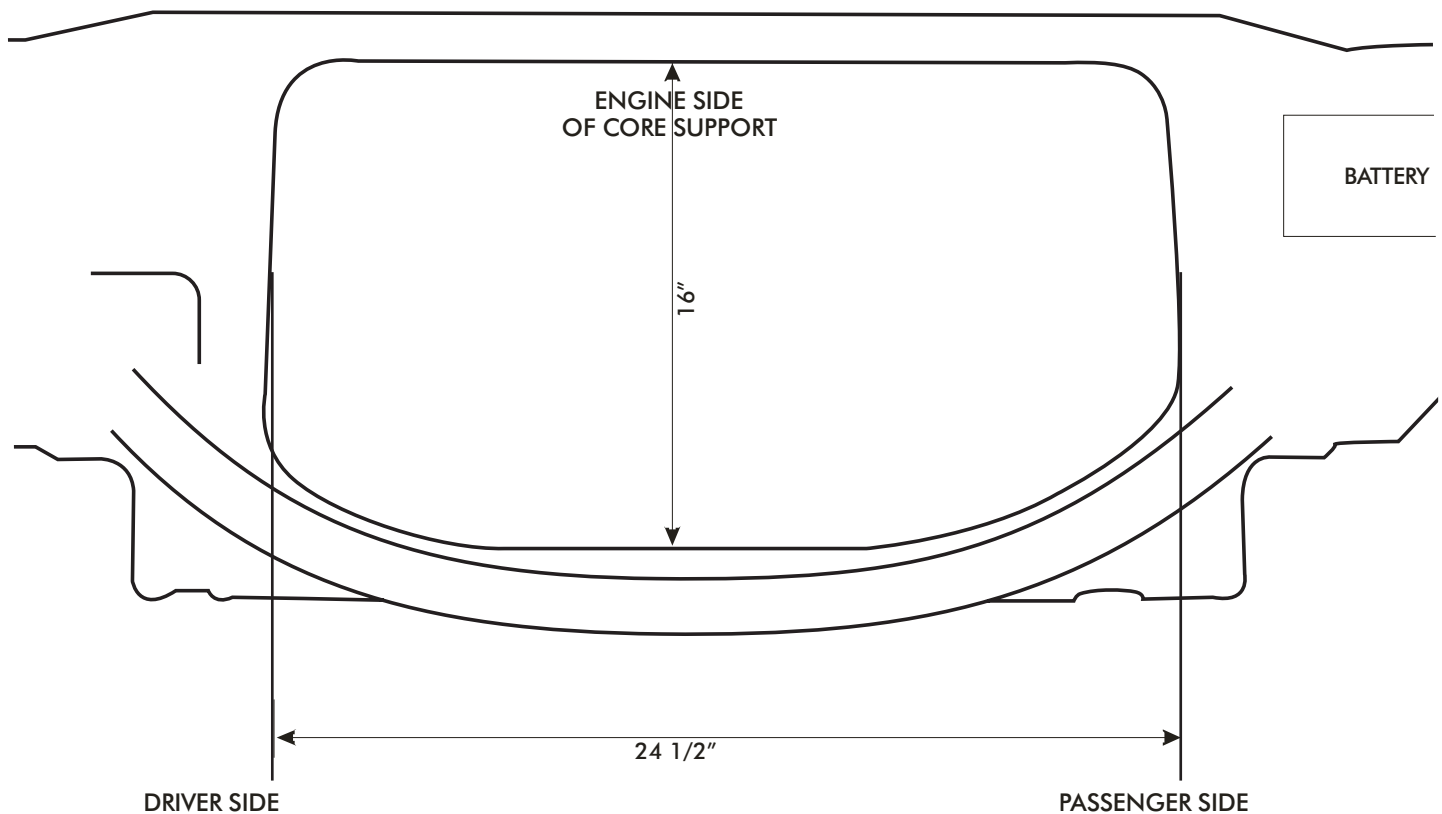



## 1964-67 CHEVELLE w/wo AC CONDENSER KIT

### CONDENSER BRACKET INSTALLATION

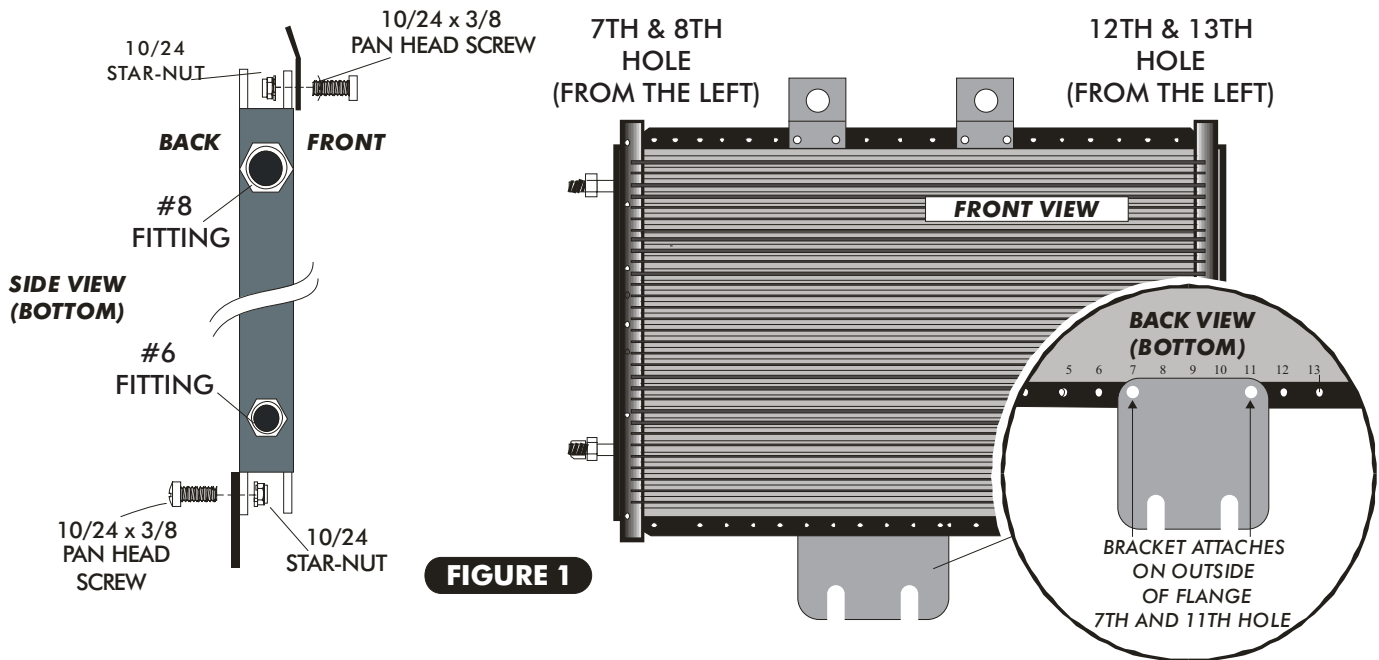

### MOUNTING BRACKET INSTALLATION

- INSTALL TOP MOUNTING BRACKETS ON TO CONDENSER USING (4) 10/24 X 3/8 PAN HEAD SCREWS AND (4) 10/24NUTS WITH STAR WASHERS. SEE FIGURE 2 BELOW. **NOTE BRACKETS MOUNT THROUGH THE 7TH & 8TH AND 12TH & 13TH HOLE FROM THE LEFT SIDE OF THE CONDENSER.**
- INSTALL BOTTOM MOUNTING BRACKET ON TO CONDENSER USING (2) 10/24 X 3/8 PAN HEAD SCREWS AND (2) 10/24 NUTS WITH STAR WASHERS. SEE FIGURE 2 BELOW. **NOTE BRACKET MOUNTS THROUGH THE 7TH & 11TH HOLE FROM THE RIGHT SIDE OF THE CONDENSER (BACK VIEW).**

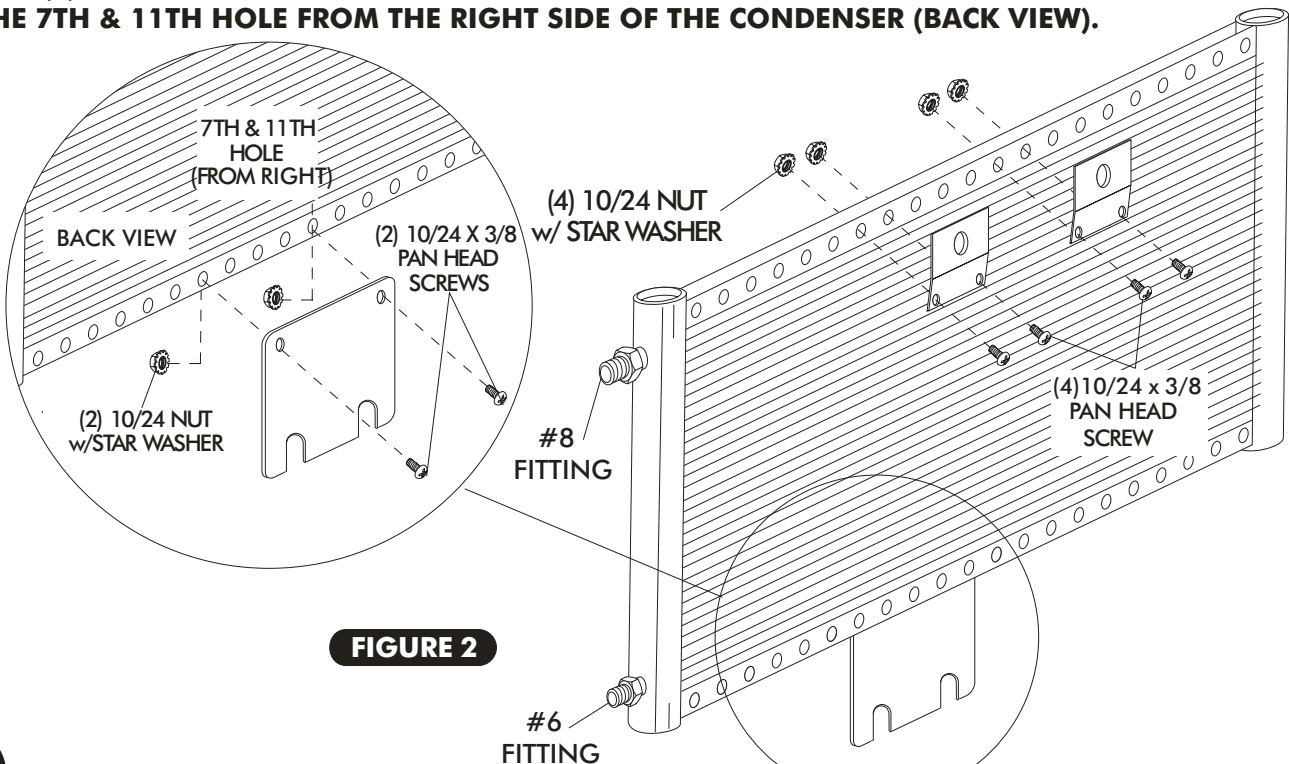



## RADIATOR REMOVAL

- ☐ DRAIN RADIATOR REMOVE UPPER AND LOWER RADIATOR HOSES AND REMOVE RADIATOR.

## HOOD LATCH ASSEMBLY

- ☐ REMOVE OEM HOOD LATCH ASSEMBLY  
SEE FIGURE 3 BELOW.

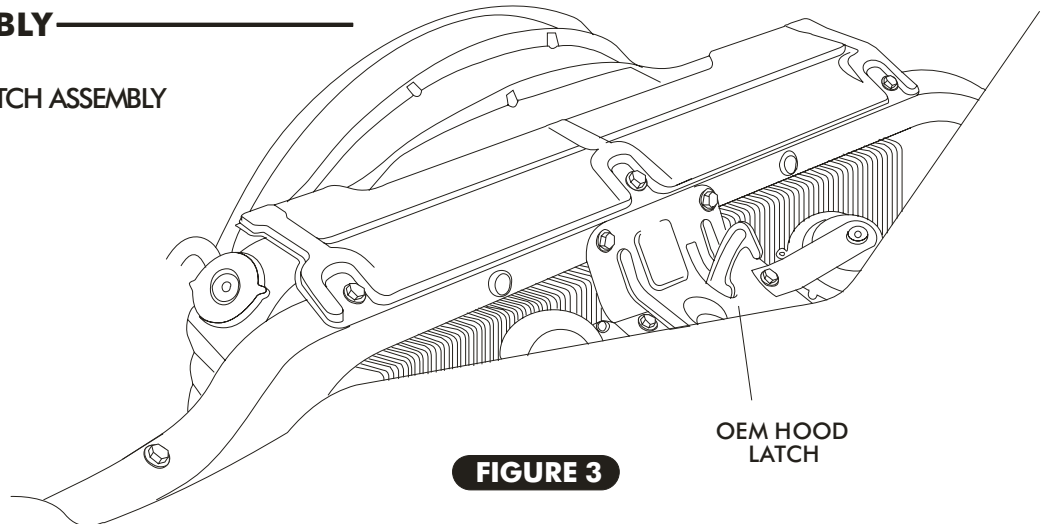

**FIGURE 3**

## CONDENSER INSTALLATION

- ☐ INSTALL CONDENSER AS SHOWN BELOW, LOWER CONDENSER FROM THE BACK SIDE OF THE CORE SUPPORT. (ENGINE COMPARTMENT SIDE)  
SEE FIGURE 4 BELOW.

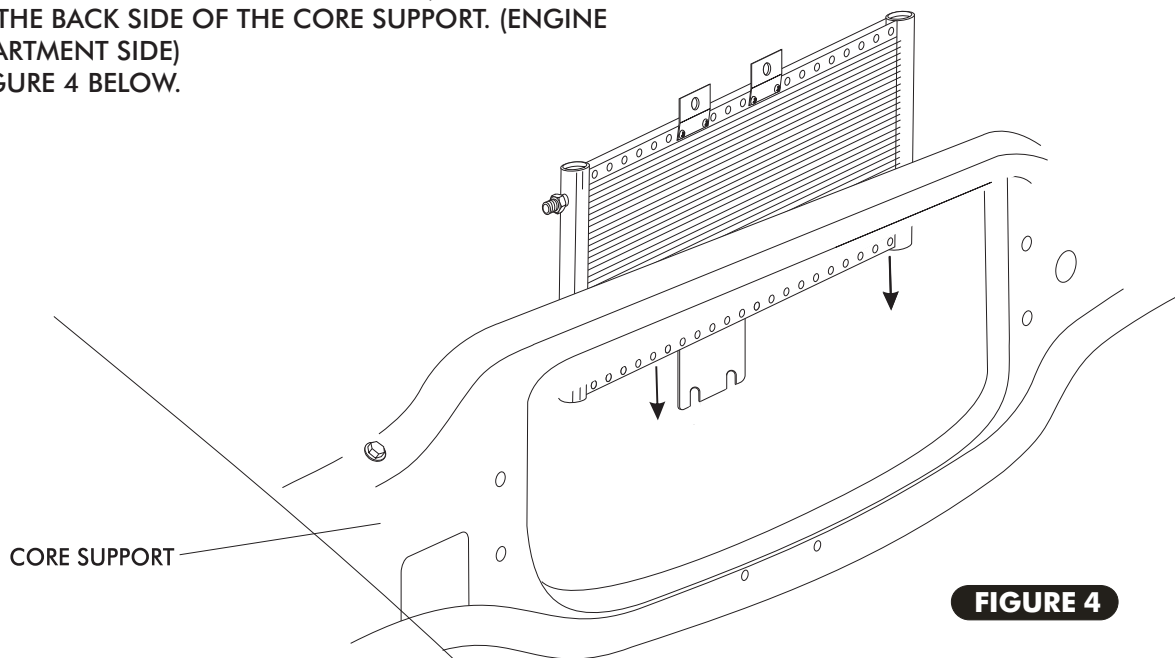

**FIGURE 4**

- ☐ **NOTE:** THE TOP MOUNTING BRACKET GOES ON THE FRONT SIDE OF THE CORE SUPPORT.



## 1964-67 CHEVELLE w/wo AC CONDENSER KIT

### CONDENSER INSTALLATION CONT

- ☐ SECURE THE BOTTOM PASSENGER SIDE OF THE CONDENSER TO THE CORE SUPPORT USING OEM BOLT.
- ☐ USE DRIVER SIDE MOUNTING HOLE AS GUIDE DRILL  $3/16$ " HOLE ON CORE SUPPORT. SECURE CONDENSER TO CORE SUPPORT USING #14 X  $3/4$  SHEETMETAL SCREW W/FLAT WASHERS. SEE FIGURE 5 BELOW.

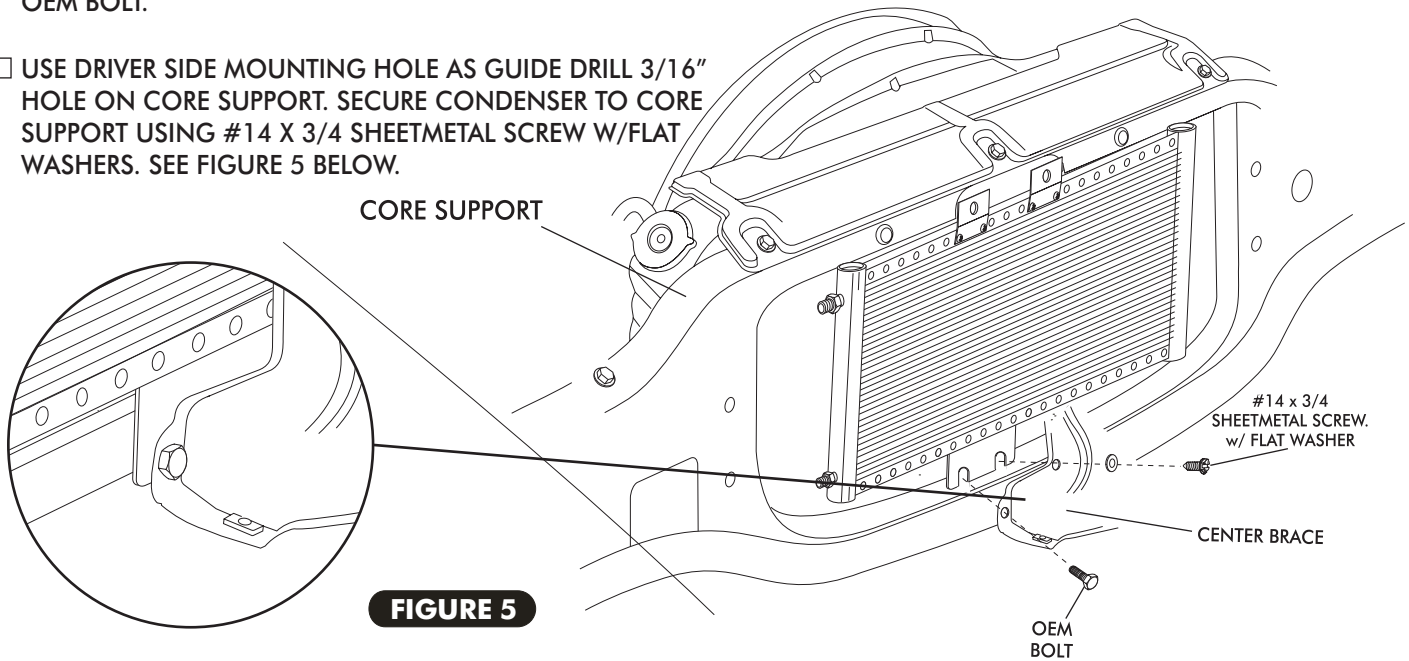

- ☐ RE-INSTALL HOOD LATCH ASSEMBLY USING OEM BOLTS, INSTALL OEM BOLTS THROUGH THE HOOD LATCH ASSEMBLY, CONDENSER, BRACKET, AND THROUGH THE CORE SUPPORT. SEE FIGURE 6 BELOW.

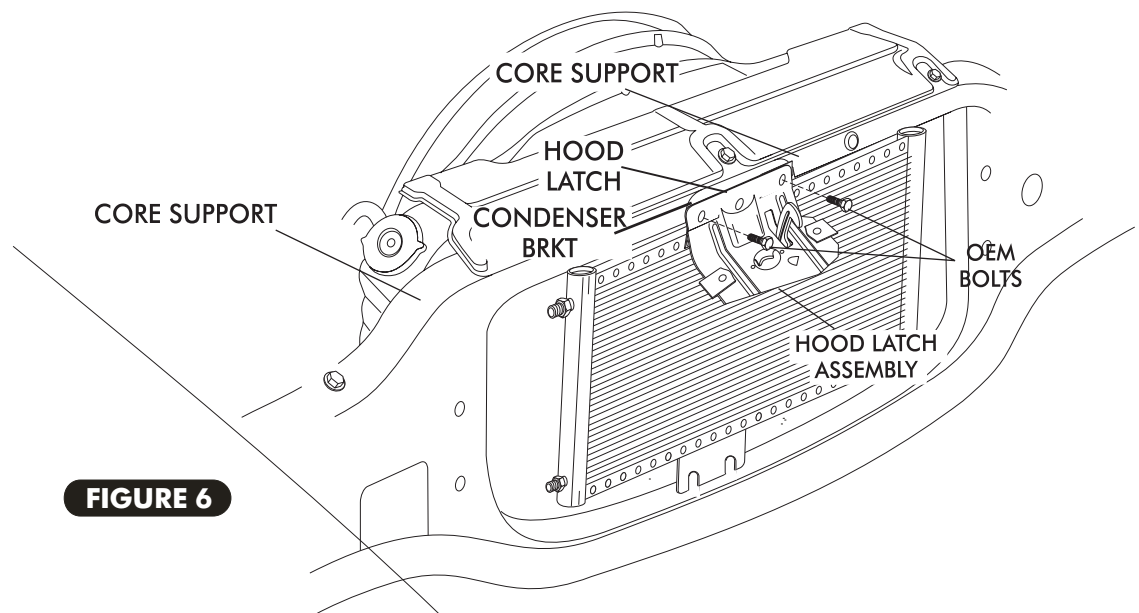



## 1964-67 CHEVELLE w/wo AC CONDENSER KIT

### CONDENSER KIT 026666

No.	QTY.	PART No.	DESCRIPTION	
1.	1	03767-VUC	14" X 24" PARALLEL FLOW COND.	_____
2.	6	18249-VUB	10/24" X 3/8" PAN HEAD	_____
3.	6	18260-VUB	10/24" NUT w/STAR WASHER	_____
4.	1	18266-VUB	#14 x 3/4 SHEETMETAL SCREW	_____
5.	1	18611-VUB	5/16" FLAT WASHER	_____
6.	2	64197-VCB	66-67 CHEVELLE TOP COND BRKT	_____
7.	1	643057	66-67 CHEVELLE BOTTOM COND BRKT	_____

CHECKED BY: \_\_\_\_\_  
PACKED BY: \_\_\_\_\_  
DATE: \_\_\_\_\_

**\*\* BEFORE BEGINNING INSTALLATION OPEN ALL PACKAGES AND CHECK CONTENTS OF SHIPMENT. PLEASE REPORT ANY SHORTAGES DIRECTLY TO VINTAGE AIR WITHIN 15 DAYS. AFTER 15 DAYS, VINTAGE AIR WILL NOT BE RESPONSIBLE FOR MISSING OR DAMAGED ITEMS.**

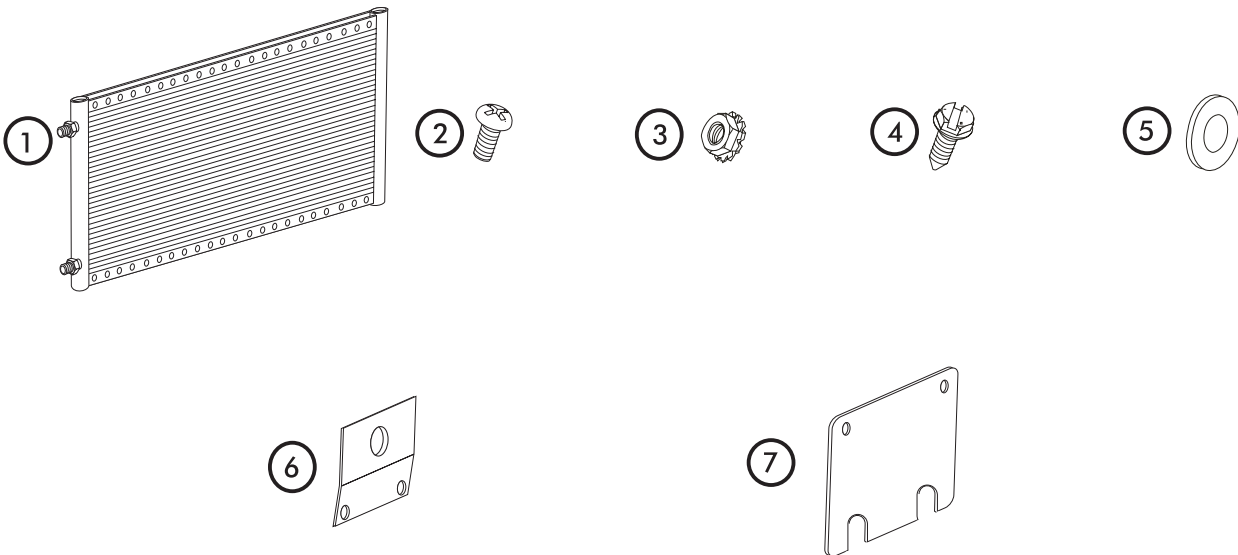

**NOTE: IMAGES MAY NOT DEPICT ACTUAL PARTS AND QUANTITIES.  
REFER TO PACKING LIST FOR ACTUAL PARTS AND QUANTITIES**