

# INSTALLATION INSTRUCTIONS

## 25758M MAGNETO POINTS

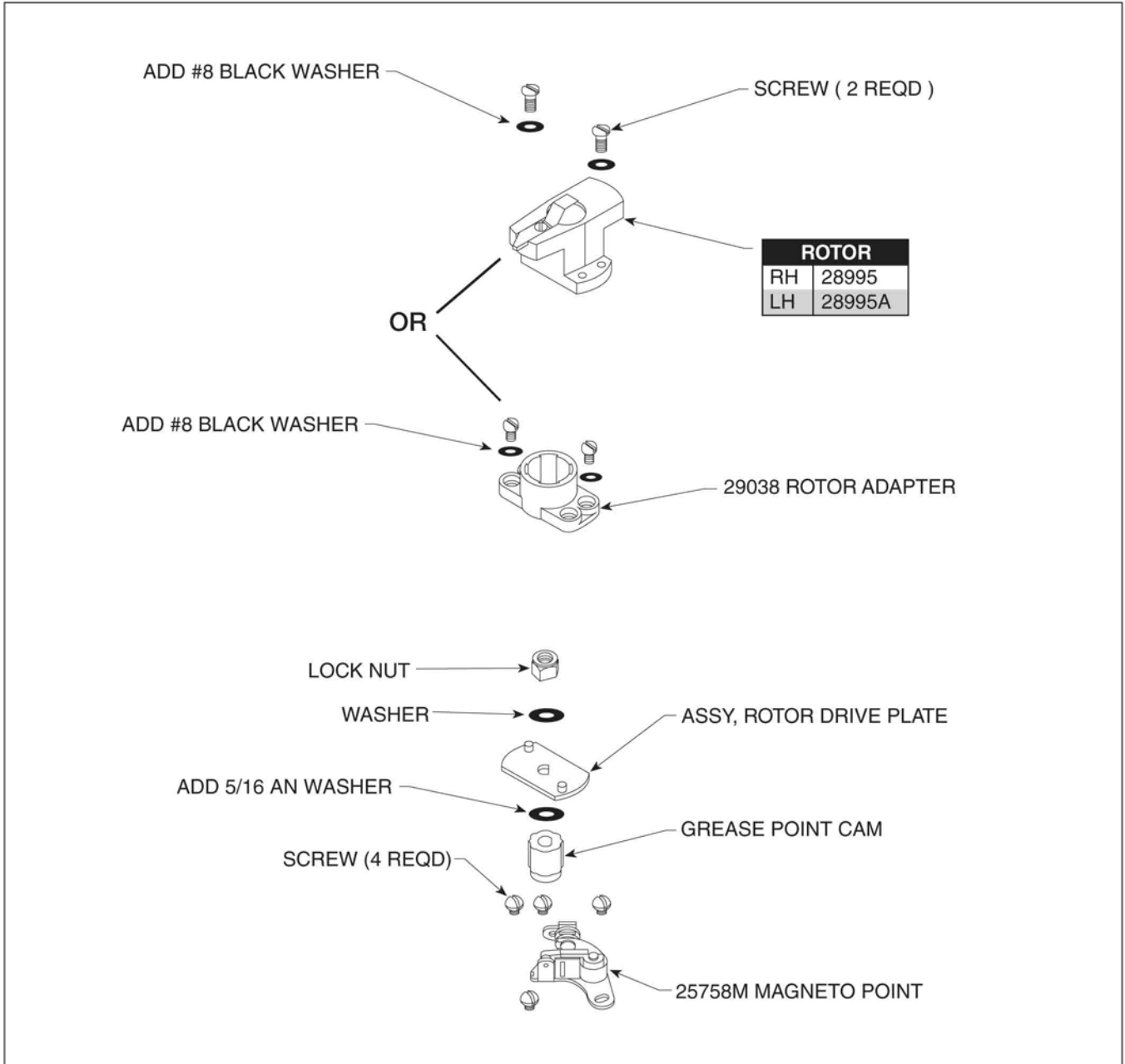

Hold 4 pin driver on bottom of magneto head and remove lock nut, as seen on diagram. Now remove lock washer, rotor drive plate and grease point cam. Next, install 5/16 AN washer, followed by drive plate, lock washer and lock nut. Install #8 black washers on rotor screws. Be sure to adjust point to .016". Double check this gap after about 30 minutes of running time.