



QUALITY... PLAIN & SIMPLE®

Chrysler 727,904, 518 Hi-Tech Kickdown Installation
Part# KD-2727HT, KD-2904HT, KD-2518HT

Chrysler 727, 904, 518 Hi-Tech Kickdown Installation Instructions

Part# KD-2727HT, KD-2904HT, KD-2518HT

Building American Quality... With A Lifetime Warranty!®

10924 Murdock Dr. • Knoxville, TN 37932

TOLL FREE 1-877-469-7440 • (865) 966-2269 • FAX (865) 671-1999 • tech@lokar.com • www.lokar.com

General Installation Notes:

Please read instructions completely before beginning installation. If you have any questions please don't hesitate to call.

Do not attempt to install or adjust Throttle Cable or Kickdown kit while engine is running. Be sure engine, body and frame are grounded properly.

We recommend using an anti-seize lubricant on all aluminum threads before installation. Do not over tighten while fitting cables.

Cut housing by using diagonal cutters, Lineman pliers or taping the housing and using a fine-tooth hacksaw. Klein diagonal cutters, part no. D2000-28 (available at Grainger's, part no. 4A838) work best.

Kickdown Installation

Note: The kickdown kit is designed to mount to a Lokar spring return bracket (SRK-4000) as in **Fig. 1**.

Step 1: Install the Lokar SRK-4000 Spring Return Bracket. (Per the instructions included with the bracket) **Fig. 1**.

Step 2: Install the adjuster bracket to the Lokar Spring Return Bracket (SRK-4000) on carb as shown in **Fig. 1**.

Step 3: Install the cable bracket to the transmission tail housing mounting bolt as in **Fig. 2**.

Step 4: Mount the ball fitting to the kickdown lever on the transmission as illustrated in **Fig. 2**. (The kickdown lever is not included; the OEM Lever must be used)

Step 5: Route braided cable housing up to adjuster, add 1" extra length and cut outer housing to desired length.

Step 6: Install Hex Carb fitting with plastic Lokar Cable Slide Fitting and install tear drop for springs. Hook spring to Tear Drop and tighten hex carb fitting.

Step 7: Install inner cable through Lokar Cable Slide Fitting and slide cable stop over cable. Position cable stop approximately 1 1/2" from hex fitting and tighten allen set screw. Cut off excess cable leaving about 1" extending beyond cable stop.

Step 8: Make final adjustments by holding throttle to wide open and pulling the kickdown inner cable as tight as possible. Slide cable stop up against Lokar Cable Slide Fitting and tighten allen set screw. When the kickdown is properly adjusted you should be able to open the throttle to wide open position and there should be no slack in the kickdown cable.

Step 9: Double check to be sure that all carb and throttle linkage operates freely without binding, then test drive. Once kickdown is correctly adjusted and operating properly you can cut off the excess cable beyond the cable stop.

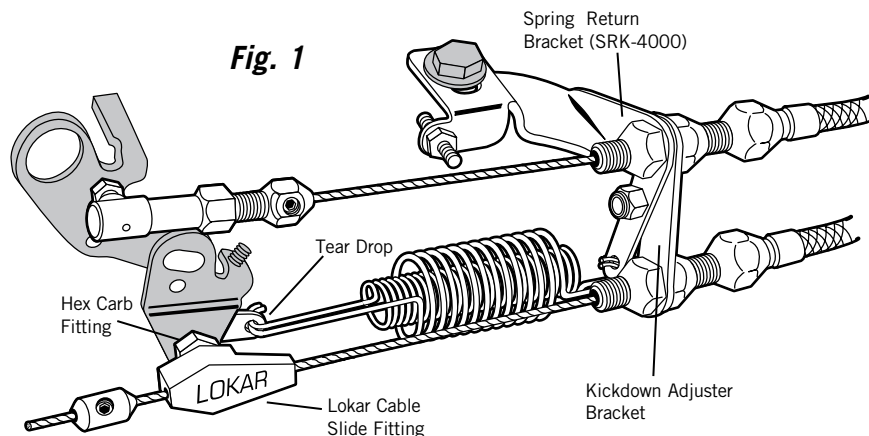

Fig. 2

