



QUALITY... PLAIN & SIMPLE®

Powerglide Hi-Tech Kickdown Kit **Part# KD-20PGHT**

General Installation Notes:

Please read instructions completely before beginning installation. If you have any questions please don't hesitate to call.

Do not attempt to install or adjust Throttle Cable or Kickdown kit while engine is running. Be sure engine, body and frame are grounded properly.

We recommend using an anti-seize lubricant on all aluminum threads before installation. Do not over tighten while fitting cables.

Cut housing by using diagonal cutters, Lineman pliers or taping the housing and using a fine-toothed hacksaw. Klein diagonal cutters, part no. D2000-28 (available at Grainger's, part no. 4A838) work best.

Powerglide Kickdown Installation

Note: The kickdown kit is designed to mount to our spring return bracket (SRK-4000) as shown.

Step 1: Install the threaded kickdown ball onto the transmission kickdown lever as shown in **Fig. 1**.

Step 2: Install the cable mounting bracket onto the bottom of the boss on the side of the transmission as in **Fig. 1**.

Step 3: Install the adjuster bracket to the Lokar Spring Return Bracket (SRK-4000) on the carb as shown in **Fig. 2**.

Powerglide Hi-Tech Kickdown Kit Installation Instructions

Part# KD-20PGHT

Building American Quality... With A Lifetime Warranty!™

10924 Murdock Dr. • Knoxville, TN 37932

TOLL FREE 1-877-469-7440 • (865) 966-2269 • FAX (865) 671-1999 • tech@lokar.com • www.lokar.com

Step 4: Route the braided cable up to the adjuster fitting on the carb. Slide the ferrule back onto the housing and measure between both fittings. Add one inch (1") and cut the outer housing as described in the General Installation Notes. Once the housing is cut, slide the ferrule back to the end of housing and install it into the adjuster fitting. Be sure the cable is mocked up the way it will be routed in the final installation.

Step 5: Install Hex Carb fitting with plastic Lokar Cable Slide Fitting and install tear drop for springs. Hook spring to tear drop and tighten hex carb fitting.

Step 6: Install inner cable through Lokar Cable Slide Fitting and slide cable stop over cable. Position cable stop approximately 1 1/2" from hex fitting and tighten allen set screw. Cut off excess cable leaving about 1" extending beyond cable stop.

Step 7: Make final adjustments by holding throttle to wide open and pulling the kickdown inner cable as tight as possible. Slide cable stop up against Lokar Cable Slide Fitting and tighten allen set screw. When the kickdown is properly adjusted you should be able to open the throttle to wide open position and there should be no slack in the kickdown cable.

Step 8: Double check to be sure that all carb and throttle linkage operates freely without binding, then test drive. Once kickdown is correctly adjusted and operating properly you can cut off the excess cable beyond the cable stop.

Fig. 1

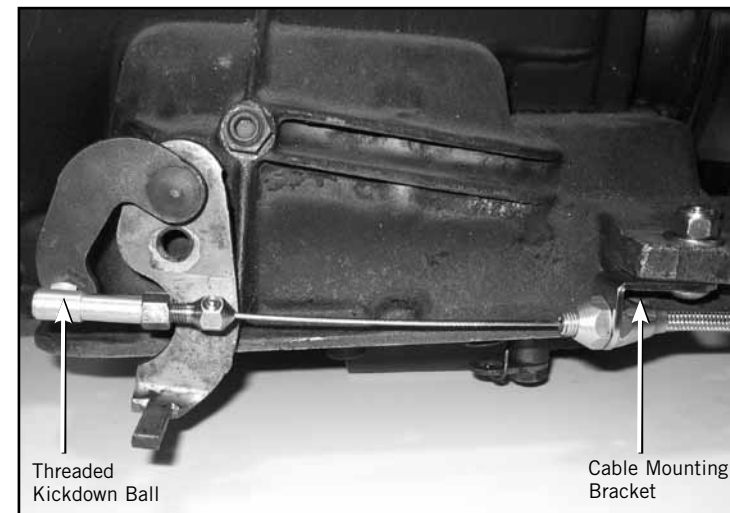

Threaded Kickdown Ball

Cable Mounting Bracket

Fig. 2

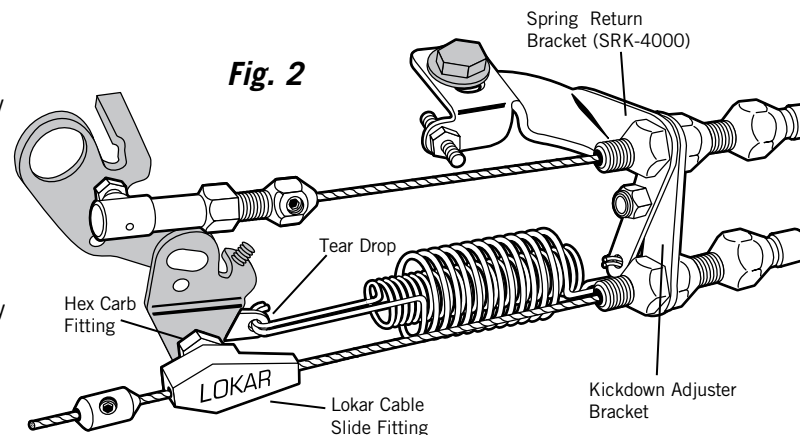

Hex Carb Fitting

Tear Drop

LOKAR

Lokar Cable Slide Fitting

Spring Return Bracket (SRK-4000)

Kickdown Adjuster Bracket