

INSTRUCTION

350-700 G-Comp Rear Suspension: 70-81 Chevy Camaro

©Speedway Motors, Inc. 2017

Kit Contents:

- | | |
|------------|--------------------------------------|
| • 350700.1 | G-Comp Crossmember & Chassis Brace |
| • 350700.2 | G-Comp Rear Crossmember Assembly |
| • 350700.3 | G-Comp Panhard Bar |
| • 350700.4 | Hardware Kit |
| • 350700.5 | G-Comp Panhard Bar Hardware |
| • 350024 | G-Comp Panhard Bar & Saddle Brackets |
| • 350004 | G-Comp Truck Arms |

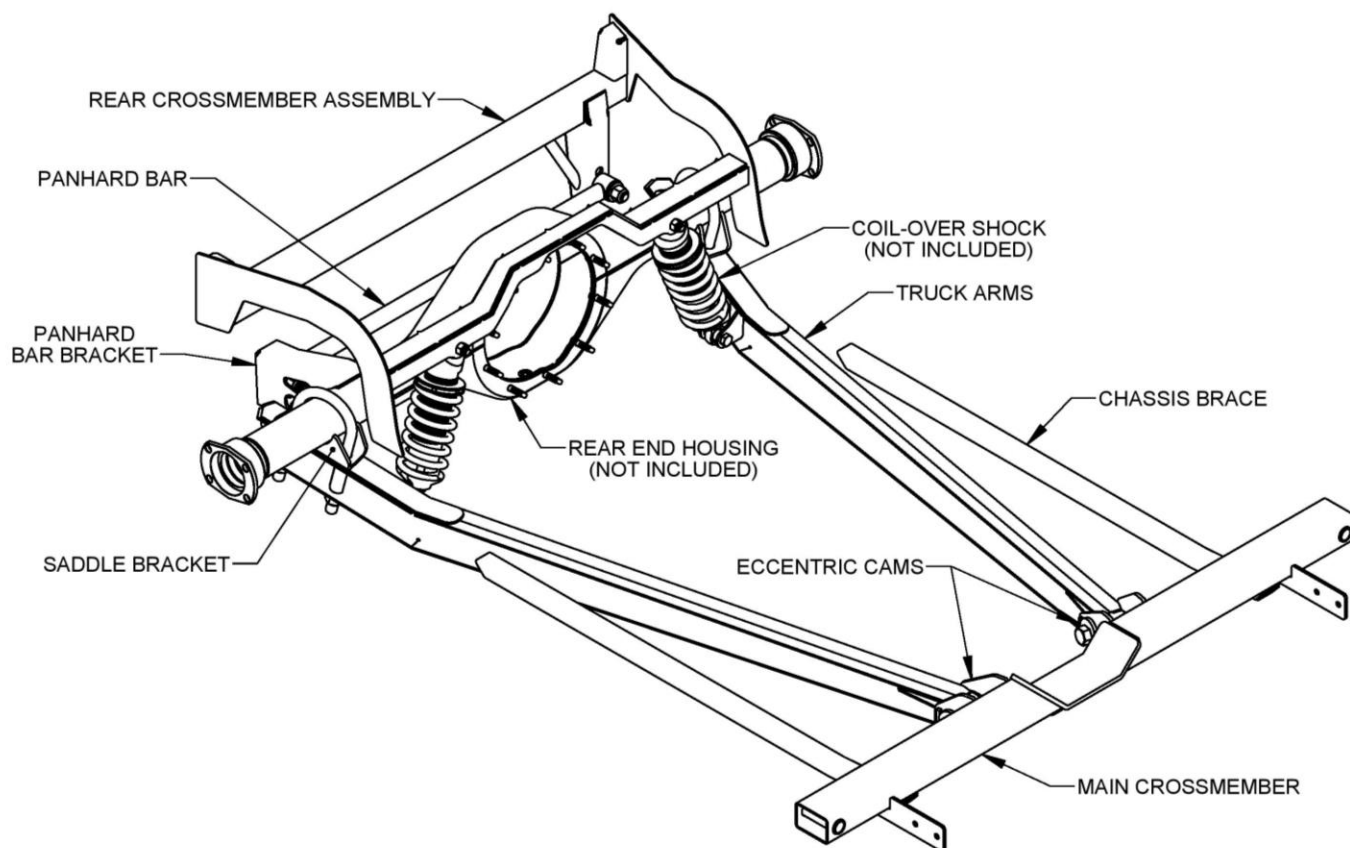

NOTE: This kit requires modifications to the rear floor pans.

1. **Remove Rear Suspension:** Raise the car and support it with jack stands or a lift. Remove; the exhaust, drive shaft, rear end, and all rear suspension components including the rubber bump stops. Disconnect fuel lines and remove fuel tank. Remove fuel lines, brake lines, and E-brake cables from bottom of car. These can be re-routed through the holes in the chassis brace after installation.
2. **Prep for Welding:** Raise the main crossmember into its approximate position and mark all areas that will be welded. These areas should be ground down to bare metal to provide the proper conditions for welding. (Any carpet or padding installed on back side of weld areas should be removed at this time.) The main crossmember should be centered in the car and set between the rockers, just behind the factory crossmember.

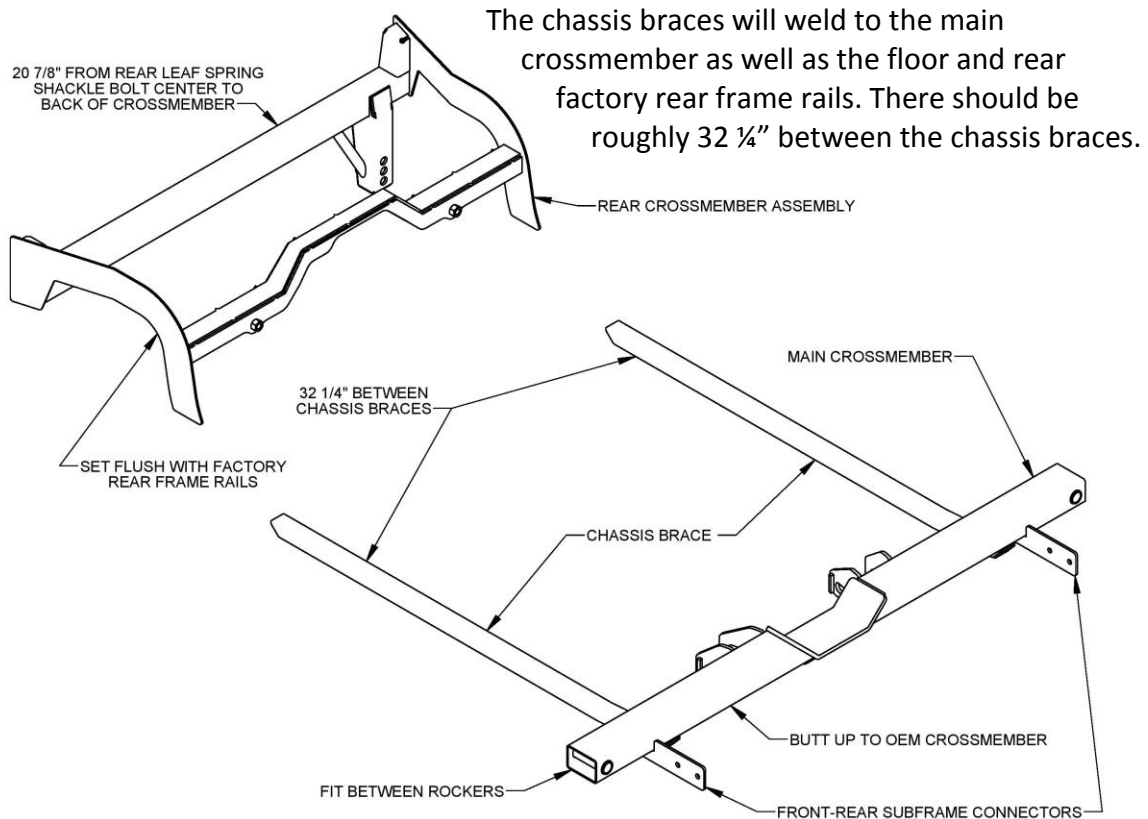

3. **Repeat** step two with the rear crossmember assembly. Depending on the car, minor trimming/fitting may be required. The rear crossmember assembly will sit between the factory rear frame rails and sit against the floor of the car. The rear frame rails should be flush with the outer plates of the assembly and the rear crossmember should be 20 7/8" from the factory rear leaf spring shackle bolt holes.
4. **Tack-Weld Crossmembers:** Once all areas that will be welded have been prepped and cleaned – the main and rear crossmembers can be tack welded into place. (Some grinding and trimming may be necessary to provide proper fit up.) **Note:** Do not fully weld the crossmembers at this time! Only weld enough to securely hold the parts in place during mock up. Hint: Weld in places that can be easily accessed with a grinder in case it becomes necessary to move or adjust the parts.

5. **Prep Rear End:** If re-using your rear end housing, tear down the rear end to just a bare housing. Remove any spring perches or brackets. For the saddles and panhard bar bracket to be positioned properly, it is critical that they fit tightly against the bare axle tubes. Any extra material on the tubes will need to be ground away to provide a proper fit. Prep for welding by removing all paint, oil, and grease where new brackets will be installed.

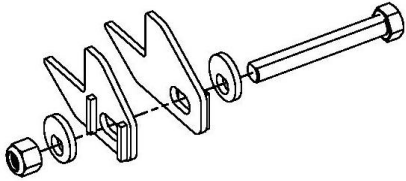
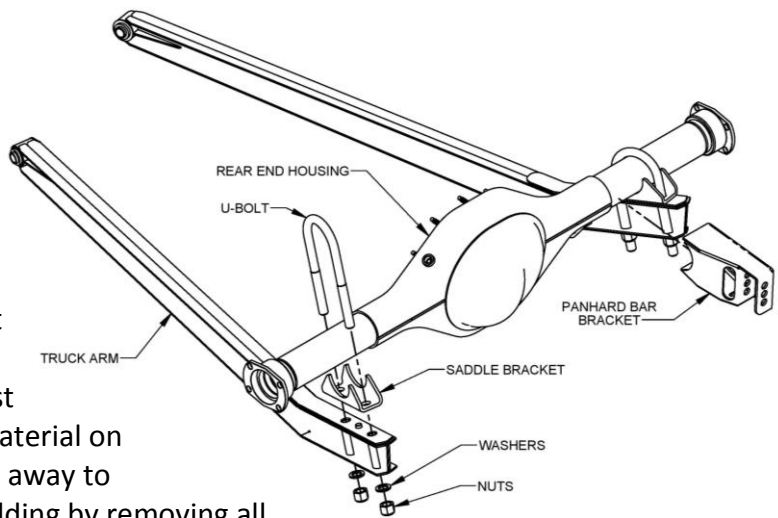

6. **Assemble Truck Arms and Rear End Housing:** Install truck arms onto the front crossmember using the supplied 3/4"-16 X 5-1/2" grade 8 cam bolts and spacers. **NOTE:** Install the cam bolts in the center of adjustment as shown. The flat side of the bolt should be facing upwards. Install rear end housing using the supplied U-bolts and nuts as shown above. **Do not fully tighten u bolts at this time.**

7. **Adjust Rear End:** Raise the rear end to the desired ride height, relative to the car. (Suggested ride height is about 12 1/2" center to center for the shock bolt holes). Support the rear end at this height and center it in the car. The center to center distance on the top side between the two truck arms should be 36 11/16" as shown. The distance from the outer flange of the rear end housing to the truck arm should be the exact same on both sides. Once the rear end is centered, and at ride height, spin the rear end housing to achieve the desired pinion angle. Now, double check that the rear end is in the proper location and tighten down the U-bolt nuts.

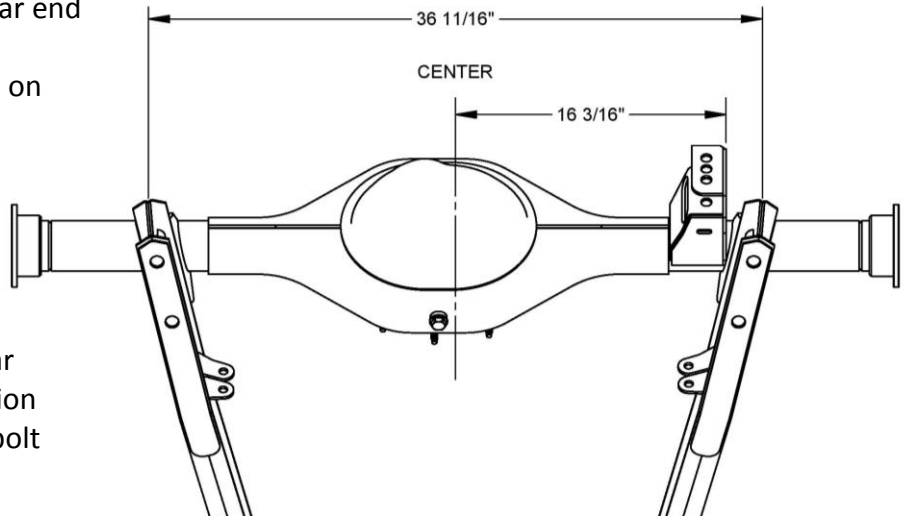

8. **Tack-Weld Saddle Brackets:** Once you are sure the rear end is located properly, tack-weld the saddle brackets to the rear end housing. It is recommended to double check all measurements after tack welding.

9. **Panhard bar:** Secure the panhard bar to the rear crossmember using the supplied 5/8"-11 x 6" grade 5 bolt and nut. Adjust the panhard bar so that there is about 1/2" of thread showing and tighten the jam nut. This will allow for a small amount of adjustment in both directions. Now, raise the panhard bar bracket into place on the rear end and bolt the panhard bar to it using the 5/8"-11 x 3-1/2" grade 5 bolt and nut. Rotate, or "clock" the bracket on the rear end so that the bolt is horizontal. Double check that the bracket is in the proper position and tack weld the bracket to the rear end housing. As shown, the outside edge of the panhard bar bracket should be about 16 3/16" from the center of the housing. The center of the housing can be found by measuring the flange to flange distance and dividing by two. **DO NOT** assume that the drain plug or third member are centered, this is often not the case. You must measure to find the center! **NOTE:** There are 3 possible locations for each end of the panhard bar, use the mounting holes that make the panhard bar level with the ground at ride height. This will vary depending on ride height.

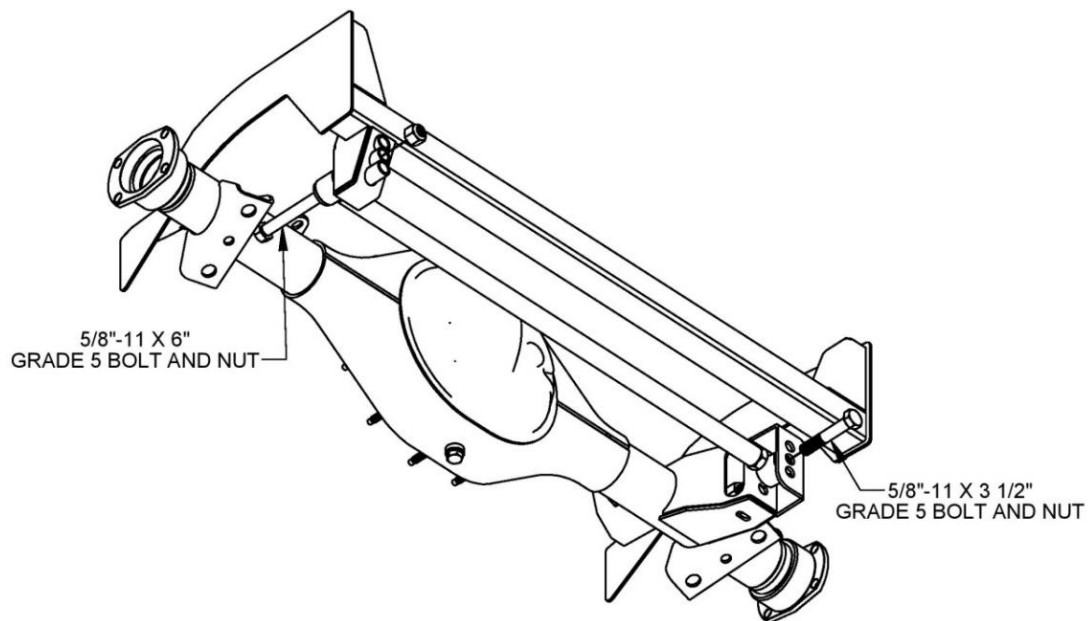

10. **Check Alignment and Clearances:** it is recommended at this point to cycle the suspension through its travel and check for any clearance issues. This is also a good time to double check that the rear end is aligned properly with the car and the pinion angle is correct. (use the cam bolts on the truck arms to adjust the alignment) **Note:** On most cars, the rear floor pans will need to be raised or notched to allow clearance for the truck arms during compression travel.
11. **Finish Weld:** Remove the rear end, panhard bar, and truck arms from the car. Fully weld the crossmember assembly and chassis braces to the car. Weld the saddle brackets and panhard bar bracket to the rear end. **NOTE:** It is a very good idea to only weld a small bead at a time, then move to a new area and allow the first area to cool completely before welding further in that area. This will greatly reduce the risk of warping, especially on the rear end housing.

12. Re-Assemble: Once all of the welding is complete everything can now be re-assembled.

- Secure the truck arms to the chassis brace using the cam bolts and cam spacers as shown in step 6. Torque the nuts to 120 ft-lbs.
- Now is a good time to fully assemble the rear end by installing gears, axles, and brakes. (This can also be done after installing the housing into the car)
- Raise the complete rear end into position. Attach the rear end to the truck arms using the supplied u-bolts, washers, and nuts. Torque nuts to 220 ft-lbs.
- Install the pan hard bar using the 5/8"-11 x 6" grade 5 bolt and nut on the crossmember end and the 5/8"-11 x 3 1/2" grade 5 bolt and nut on the housing end. Torque both bolts to 120 ft-lbs.
- Install your coil over shocks using the supplied 1/2"-13 grade 5 bolts. The 2 3/4" bolts and 3/16" wide spacers are for the bottom while the longer 3" bolts and 5/16" spacers are for the top. Torque the coil-over bolts to 65 ft-lbs **Note:** This kit is design to use shocks with a compressed length of 10" and an extended length of 14". Shock ends should be 1/2" bearings with a mounting width of 1". For recommended part numbers please visit our website or contact one of our tech experts.
- Re-install; drive shaft, fuel tank, fuel lines, brake lines, and E-brake cable etc...
- Bleed the brakes.
- Fill the rear end with fluid.
- Install wheels and tires

13. Alignment:

- Lower the car onto the ground and check for desired ride height. Adjust ride height if necessary by raising the car and spinning the adjusting collar on the coil-over.
- Once the ride height has been set, lower the car onto the ground and make sure the rear end is centered in the car body. Adjust the panhard bar if necessary. Lengthening the panhard bar will move the rear end toward the passenger side, while shortening it will move the rear end toward the driver side.
- Now that the ride height is set and the rear end is centered perfectly in the car, the rear end can be aligned by adjusting the cam bolts on the front of the truck arms. **NOTE:** This is difficult to do accurately and a professional alignment is recommended. This method will get you close enough to drive the car to an alignment shop.

IMPORTANT

DISCLAIMER

In an effort to offer our customers the low prices, quick service and great value, Speedway Motors reserves the right to change suppliers, specifications, colors, prices, materials. Each of the previous items is subject to change without notice. Speedway is not responsible for any typographical errors or misinterpretations. Quantities are limited on some items.

WARRANTY DISCLAIMER

The purchaser understands and recognizes that racing parts, specialized street rod equipment, and all parts and services sold by Speedway Motors, Inc. are exposed to many and varied conditions due to the manner in which they are installed and used. Speedway Motors, Inc. makes no warranties, either express or implied, including any warranty of merchantability or fitness for a particular purpose other than those contained in its current catalog with respect to the goods identified on the face of the invoice. There is no warranty expressed or implied as to whether the goods sold hereby will protect purchaser or ultimate user of such goods from injury or death. Speedway Motors assumes no liability after this period.

BRAKE INSTALLATION ALERT

The selection and installation of brake components should only be done by personnel experienced in the proper installation and operation of braking systems. The installer must use his/her own discretion to determine the suitability of all brake components and brake kits for every particular application. Speedway Motors, Inc. makes no warranties either expressed or implied including any warranty of merchantability or fitness for a particular purpose, other than those contained in its current catalog or website with respect to the goods identified on the face of the invoice. There is no warranty expressed or implied as to whether the goods sold hereby will protect the purchaser or ultimate user of such goods from injury or death.

DAMAGE CLAIMS

Always inspect your package upon delivery. Inspect all packages in the presence of the delivery driver. The driver must note any damage. Ask the driver the Carrier's procedures for handling damage claims. You must hold the original box, packing material and damaged merchandise for inspection or the carrier will not honor the claim. Notify Speedway Motors customer service department for instructions on returning damaged goods. Speedway is not responsible if no notification is given within 5 days of receipt.

SHORTAGES

Always check the contents of your delivery to insure all the parts that you ordered were received. Please read the invoice. Double check all packing materials, small items may be wrapped inside with these products. Shortages may occur from damage to the box, so save all packing materials. Inspect the box for holes that would allow parts to fall out. If you are missing any item(s) be sure to check your invoice for back orders or canceled items before calling the customer service department. If Speedway has to split a shipment into multiple boxes, packages may be delivered on different days. You need to contact the customer service department within 5 days of delivery to assure the prompt replacement. Speedway Motors assumes no liability after this period.

REFUSALS

All refused COD customers will be billed a 15% restocking charge plus freight to and from the destination! If you have questions please contact Speedway's customer service department.

WARRANTY CLAIMS

If an item has a manufacturer's warranty as being free from defects we will exchange only. If the item has been used and you are requesting warranty work, this may take up to 30 days as warranty work is done by the manufacturer NOT Speedway Motors. If you have any questions please contact customer service.

RETURNS

Speedway wants you to be satisfied with your purchase. If within 30 days after you receive your shipment you are not satisfied, you may return the item for refund or exchange. All exchanged or returned merchandise must be in original factory condition with no modifications or alterations. Returned merchandise must include all packaging materials, warranty cards, manuals, and accessories. If the items being returned need to be repackaged there will be a re-packing charge. Re-pack the item in a sturdy box and include a copy of your invoice and complete the form on the back of the invoice. You must ship orders back **PRE-PAID. WE DO NOT ACCEPT COD SHIPMENTS.** All exchanges need to have reshipping charges included. Items that are returned after 30 days are subject to 15% restocking charges. All fiberglass returned will have 15% restocking charge. No returns on electrical parts, video tapes, and books. Absolutely no returns on special order or close out merchandise.

FREE CATALOGS

Speedway Motors offers FREE catalogs for Race, Street, Sprint and Midget, Sport Compact and Pedal Car Restoration.

Some items are not legal for sale or use in California on pollution controlled motor vehicles. These items are legal in California for racing vehicles only which may never be used upon a highway.

**Speedway Motors Inc.,
P.O. Box 81906 Lincoln, NE 68501
800.979.0122 SpeedwayMotors.com**



© , Speedway Motors, Inc.