



Installation Instructions

For Part Numbers:

- 250-325 700-469 Airaid Oiled Media Filter
- 251-325 701-469 SynthaMax Dry Media Filter - Red
- 252-325 702-469 SynthaMax Dry Media Filter - Black
- 253-325 703-469 SynthaMax Dry Media Filter - Blue

2014-16 Chevrolet SS  
6.2L V8

NOT LEGAL FOR SALE OR USE ON ANY POLLUTION CONTROLLED MOTOR VEHICLE IN CALIFORNIA OR STATES ADOPTING CALIFORNIA EMISSION PROCEDURES.

See AIRAID.COM for CARB status on each part for a specific vehicle.

Component Identification

- |     |                                 |   |
|-----|---------------------------------|---|
| 1.  | Airaid Premium Filter           | 1 |
| 2.  | Airaid Intake Tube              | 1 |
| 3.  | Cool Air Dam                    | 1 |
| 4.  | Filter Adapter                  | 1 |
| 5.  | Reducing Coupler                | 1 |
| 6.  | Hump Hose                       | 1 |
| 7.  | Weatherstrip 28.5in             | 1 |
| 8.  | Adapter Coupler                 | 1 |
| 9.  | Grommet                         | 1 |
| 10. | PCV Fitting                     | 1 |
| 11. | Barbed 90° Fitting              | 1 |
| 12. | 1/4" Flat Washer                | 3 |
| 13. | 1/4-20 x 1/2" Button Head Screw | 3 |
| 14. | #56 Hose Clamp                  | 1 |
| 15. | #60 Hose Clamp                  | 1 |
| 16. | #64 Hose Clamp                  | 2 |
| 17. | #68 Hose Clamp                  | 1 |
| 18. | 5/8" Speed Clamp                | 2 |
| 19. | PCV Hose 4"                     | 1 |
| 20. | Cap (Not Shown)                 | 1 |

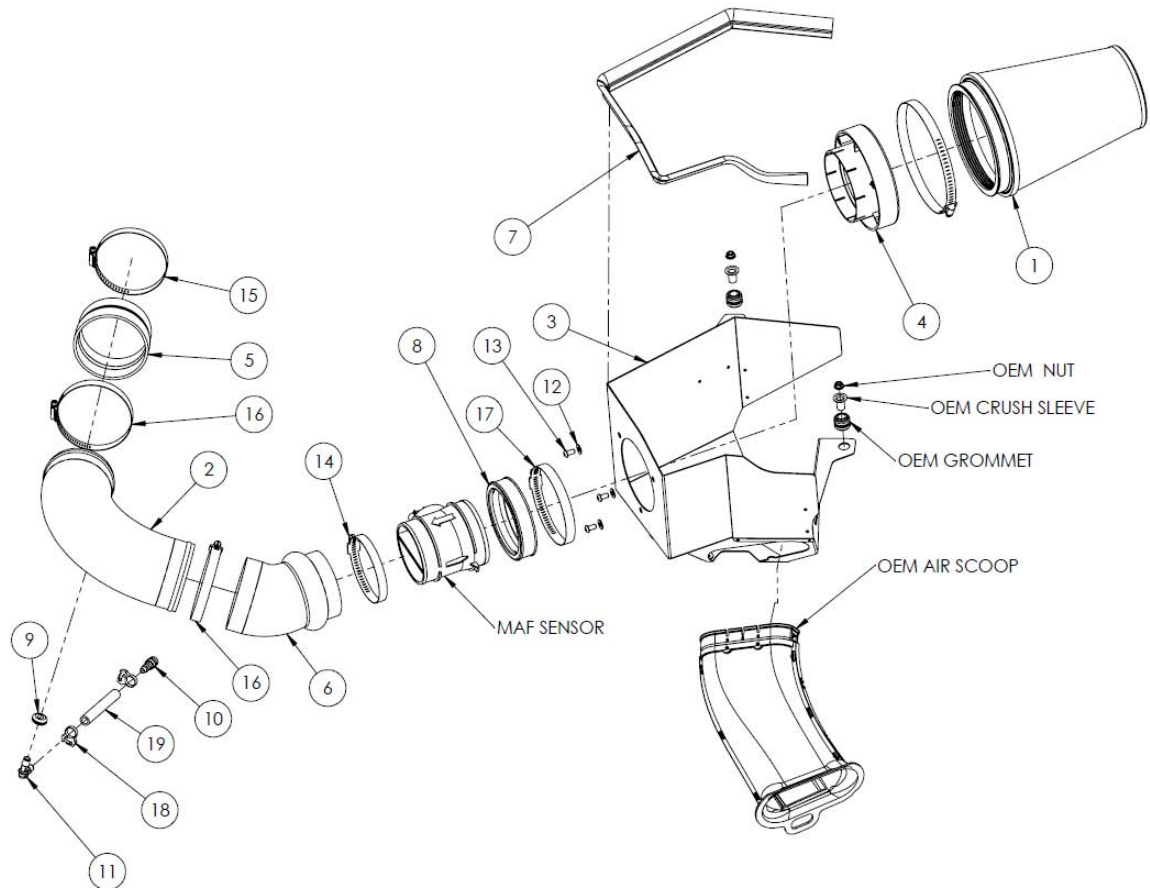

Full color instructions can be viewed on our web site at [Airaid.com](http://Airaid.com). Use the **Product Search** function to find your part number, and click **View Details**. If you need any assistance please call 1-800-858-3333 to speak with a representative in our Customer Service Center before returning the product.

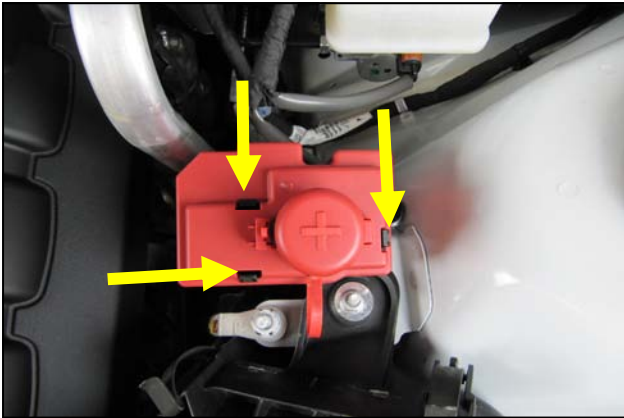

**1. Disconnect the negative battery terminal.**  
Depress the three locking tabs on the positive terminal cover and remove it.

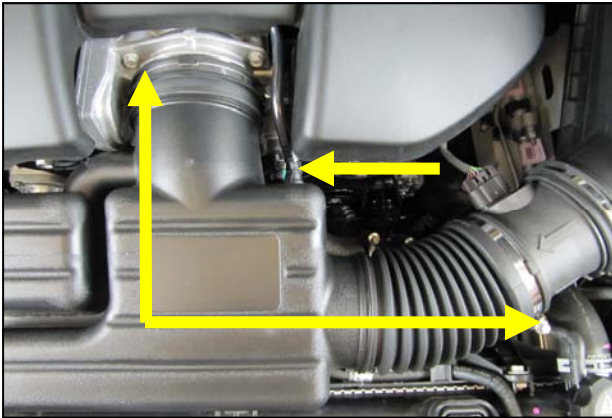

**2. Loosen the intake tube clamps. Disconnect the Valve cover breather and remove the factory intake tube.**

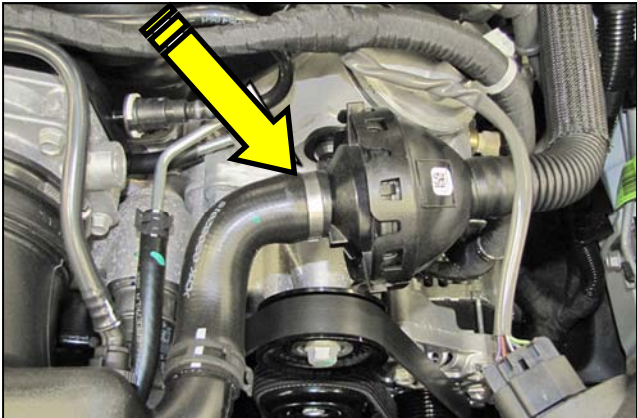

**5. On vehicles equipped with a resonator, disconnect the tube at the diaphragm and block off the inlet using the supplied Cap.**

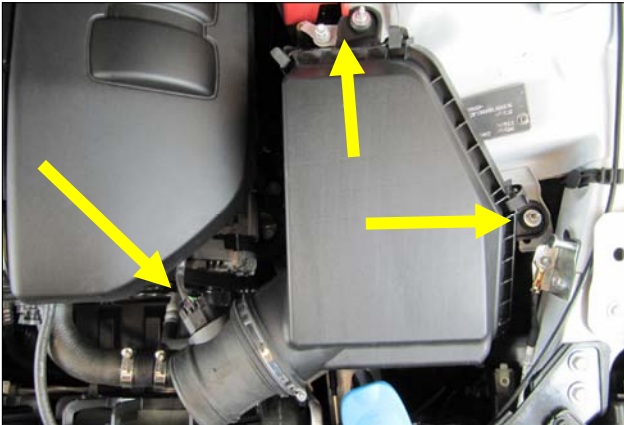

**3. Remove the two 6mm flange nuts securing the air box assembly to the inner fender. And disconnect the Mass Air Flow meter.**



**4. Remove the entire air box assembly from the vehicle.**



**6. Carefully remove the protective film from both sides of the Air Dam. Install the Filter Adapter onto the Air Dam as shown using the three Button Head Screws and Flat washers.**

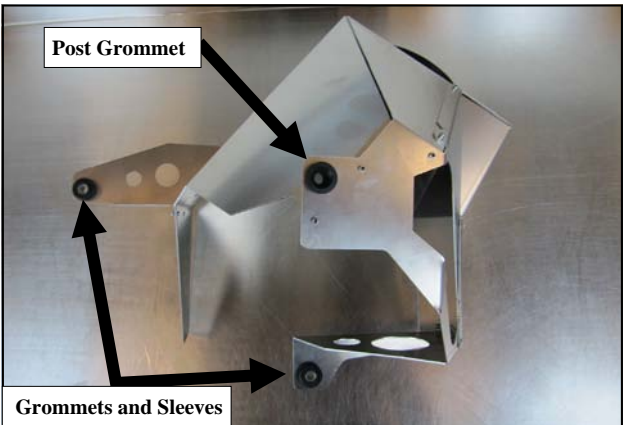

**7. Transfer the OEM grommets and steel sleeves from the factory air box, into the Air Dam assembly as shown. The grommets and steel sleeves are located on the upper half of the box and the post grommet in the lower half.**

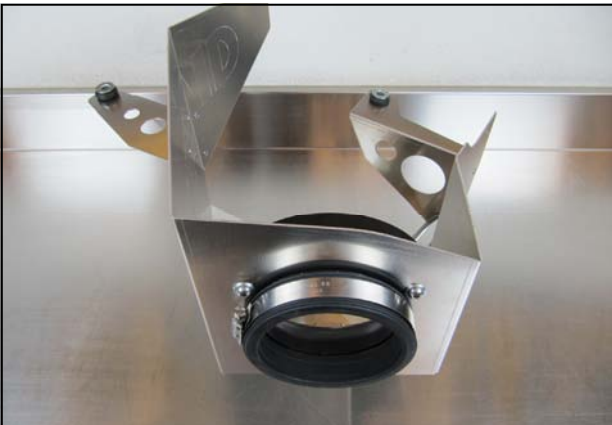

**8. Install the Adapter Coupler and Clamp onto the Filter Adapter.**

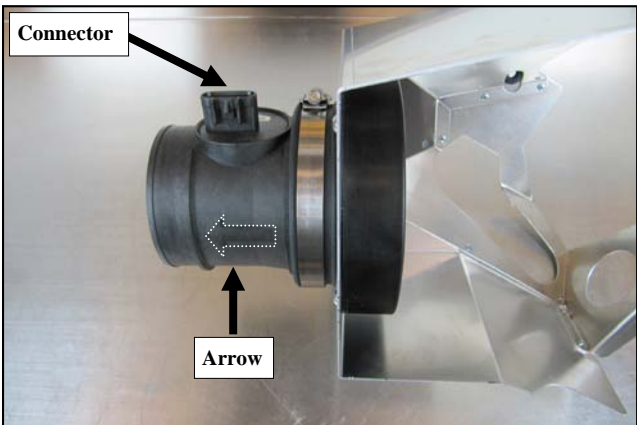

**9. Transfer the Air Flow meter into the Coupler as shown. Note the location of the connector and direction indicating arrow. Do not tighten the Clamp at this time.**



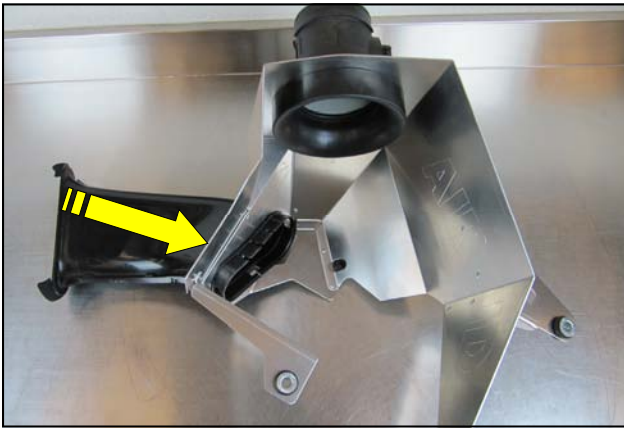

**10.** Transfer the factory air box scoop into the Air Dam assembly as shown. When properly installed, a distinct snap will sound indicating that it has locked firmly in place.

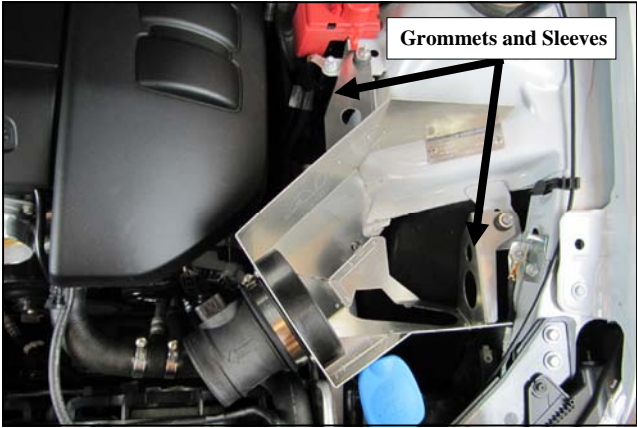

**11.** Install the Air Dam assembly into the inner fender area of the vehicle in the same manner as the OEM air-box. The grommets and sleeves are to be secured to the inner fender by re using the 6mm nuts that were removed in step Three.

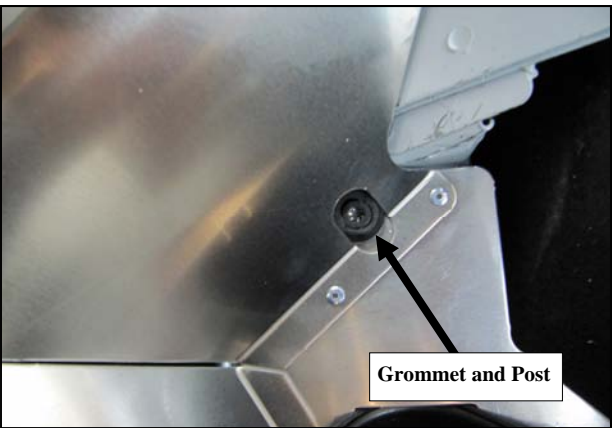

**12.** The bottom of the Air Dam assembly is to be secured using the grommet and post. Re connect the intake tube to the Mass Air Flow meter and reinstall the battery post cover.

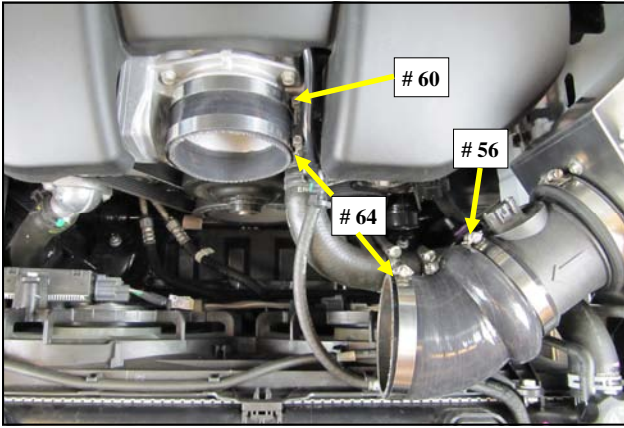

**13.** Slide the Reducing coupler and #60 clamp onto the throttle body with the #64 clamp on the larger end on the Tube side. Slide the Hump Hose, #56 and 64 Clamps onto the Air meter as shown. Leave the Clamps loose for now.



**14.** Insert the Grommet into the Airaid Intake Tube as shown.

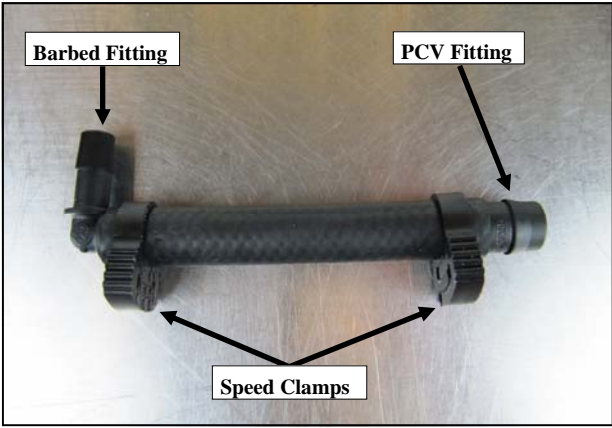

**15.** Insert the 90 deg. Barbed Fitting into the PCV Hose and the PCV Fitting into the other end. Secure the fittings using the two Speed Clamps.

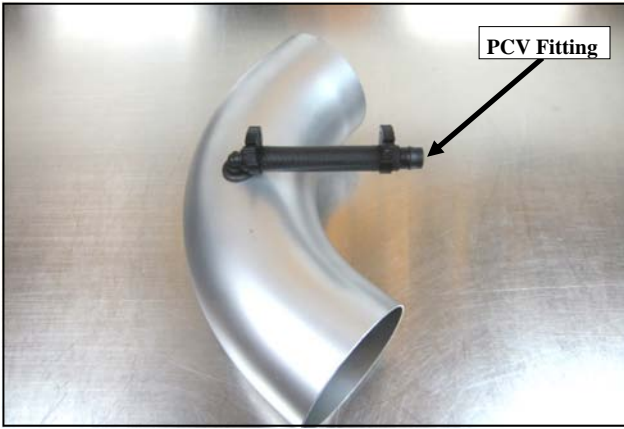

**16.** Insert the 90 deg. Barbed Fitting into the Grommet in the Intake Tube as shown.



**17.** Slide the Intake tube into the Hump Hose first, then into the Coupler. Check the positioning of al the components. Adjust if necessary and tighten the Clamps.

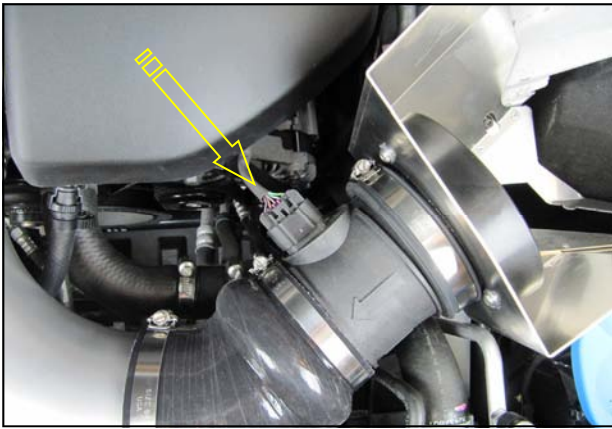

**18.** Reconnect the Air Flow Meter and reinstall the Positive terminal cover removed in step 1.



**19.** Install the Airaid Premium Filter on to the Filter Adapter.

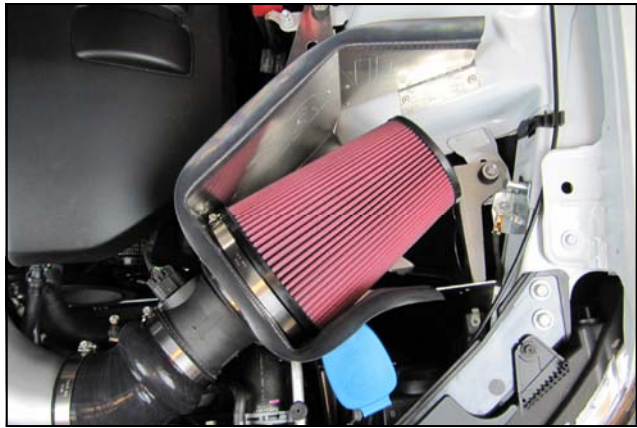

**20.** Install the Weatherstrip onto the top edge of the Air Dam with the contour rolling away from the Filter.



**Double check your work!**  
Make sure there is no foreign material in the intake path. Make sure all clamps, hoses, bolts, and screws are tight. Double check the hood clearance. Reconnect the negative battery cable.

**For your Oiled media filter we suggest using the AIRAID Filter Tune-Up Kit!**

**P/N 790-551 Aerosol Spray  
P/N 790-550 Squeeze Spray**



Synthamax Air Filters do not require oil. Service air filter as needed by cleaning with common non-petroleum all-purpose household cleaner and water. Simple Green®, Formula 409® or equivalent works great. Apply cleaner to outside of air filter and allow to soak. Then flush filter clean from the inside out with a garden hose and repeat steps if necessary. Do not apply high pressure water or air to clean filter. Allow filter to air dry and reinstall.



**NOT LEGAL FOR SALE OR USE ON ANY POLLUTION CONTROLLED MOTOR VEHICLE IN CALIFORNIA OR STATES ADOPTING CALIFORNIA EMISSION PROCEDURES.**

See AIRAID.COM for CARB status on each part for a specific vehicle.

Thank you for purchasing the Airaid Intake System. Contact Airaid @ (800) 498-6951 8:00 AM - 5:00 PM MST weekdays for questions regarding fit or instructions that are not clear to you. Your Airaid Intake System was carefully inspected and packaged. Check that no parts are missing, or were damaged during shipping. If any parts are missing, contact Airaid. The air filter element is protected from direct exposure to water and debris; care should be taken not to drive through deep water. WATER INGESTION IS THE DRIVERS RESPONSIBILITY! The air filter is reusable and should be cleaned periodically.