

Assembly Instructions for AFCO Remote Adjuster P/N 20150

AFCO Racing Products
800-632-2320
www.AFCORacing.com



PRE-ASSEMBLY

- 1) Cut free end of cable and sleeve to desired length. Strip approximately 5/8" of sleeve back to expose cable.
- 2) Use a heat gun to shrink included heat-shrink tube over sleeve. Leave approximately 1/2" of bare cable exposed.
- 3) Attach A550040024X cable end using the two A901060022X screws. Be sure cable is inserted fully into A550040024X end.

ATTACHMENT TO ROD END

WARNING Use soft jaw pliers or a wrench to securely hold the rod end knob or A550040022X rod end adapter when removing or installing the socket head screw. Failure to do so may result in damage to the internal rebound adjustment mechanism.

- 1) Remove A550040020X knob from AFCO short rod end assembly and set aside the bolt and washer retaining the knob to the rod end.
- 2) Install the A550040022X rod end adapter in its place using the included A901060022X screw.
- 3) Set the adjuster on the rod end to the middle of the desired adjustment range. Adjuster should not be full stiff or full soft as a starting point.
- 4) Install the remote adjuster assembly into the A550040022X adapter and secure it in place using the A901080009X bridge pin.
- 5) After installing the shock, secure the cable to the chassis with nylon ties every 3-6 inches. The better the cable is secured the more positive and repeatable the remote adjuster will operate.

NOTE You must have an AFCO Short Rod End equipped shock in order to use the 20150 Remote Adjuster

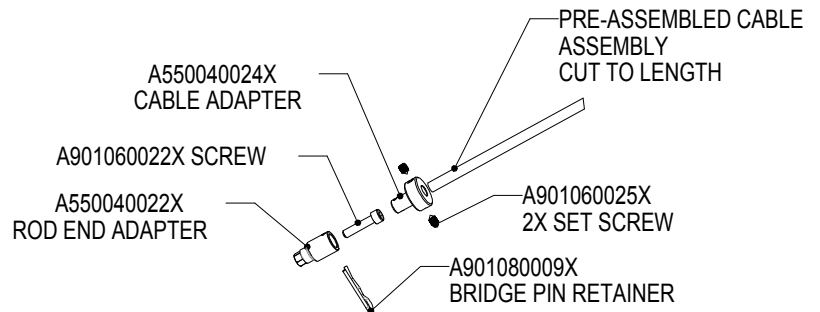
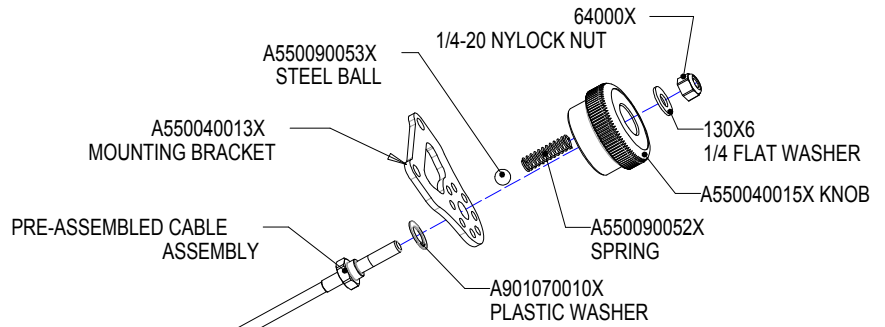

LIT-572 REV-D 5/14/10

Assembly Instructions for AFCO Remote Adjuster P/N 20150

AFCO Racing Products
800-632-2320
www.AFCORacing.com



PRE-ASSEMBLY

- 1) Cut free end of cable and sleeve to desired length. Strip approximately 5/8" of sleeve back to expose cable.
- 2) Use a heat gun to shrink included heat-shrink tube over sleeve. Leave approximately 1/2" of bare cable exposed.
- 3) Attach A550040024X cable end using the two A901060022X screws. Be sure cable is inserted fully into A550040024X end.

ATTACHMENT TO ROD END

WARNING Use soft jaw pliers or a wrench to securely hold the rod end knob or A550040022X rod end adapter when removing or installing the socket head screw. Failure to do so may result in damage to the internal rebound adjustment mechanism.

- 1) Remove A550040020X knob from AFCO short rod end assembly and set aside the bolt and washer retaining the knob to the rod end.
- 2) Install the A550040022X rod end adapter in its place using the included A901060022X screw.
- 3) Set the adjuster on the rod end to the middle of the desired adjustment range. Adjuster should not be full stiff or full soft as a starting point.
- 4) Install the remote adjuster assembly into the A550040022X adapter and secure it in place using the A901080009X bridge pin.
- 5) After installing the shock, secure the cable to the chassis with nylon ties every 3-6 inches. The better the cable is secured the more positive and repeatable the remote adjuster will operate.

NOTE You must have an AFCO Short Rod End equipped shock in order to use the 20150 Remote Adjuster

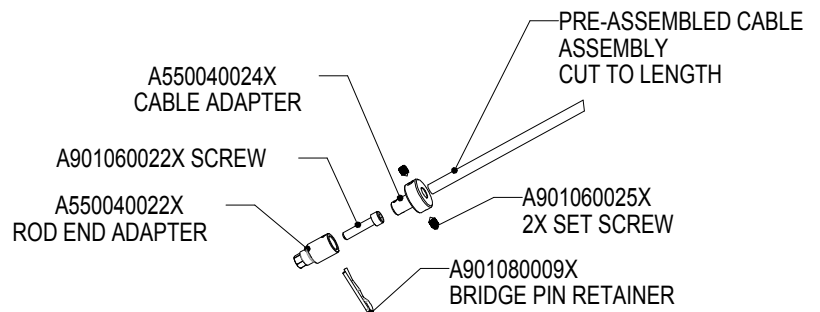
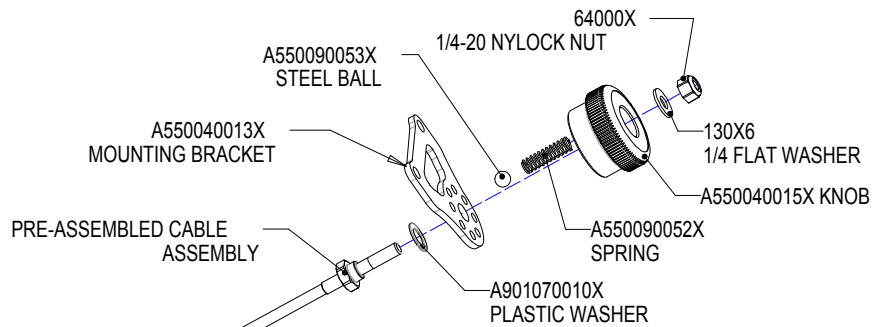

LIT-572 REV-D 5/14/10