

## NOTICE

TO PROTECT & PRESERVE YOUR BLACK POWDER PAINTED OR CHROME PLATED BRACKETS' FINISH, BE SURE AND APPLY A GOOD QUALITY WAX SUCH AS CARNAUBA, AS NEEDED.



phone **800.979.0122**

fax **800.736.3733**

340 Victory Lane • Lincoln NE 68528

**[www.SpeedwayMotors.com](http://www.SpeedwayMotors.com)**



## INSTALLATION INSTRUCTIONS

**916-68040**

---

**TO MAKE INSTALLATION EASIER, PLEASE READ ALL THE INSTRUCTIONS BEFORE INSTALLING THE BRACKET.**

---

### **SIDE MOUNT ALTERNATOR BRACKET INFORMATION**

- Designed to fit 1998-2002 Camaro, 2000-2015 Truck LS Vortec Truck, Older Non Supercharged CTSV, and 2010 up Camaro Alternators.
- For use with LS1/LS2/LS6 wide pulley water pump (GM P/N 19256263), LS2 (GM P/N 89018052) or truck based water pump (GM P/N 19207665 or any truck pump).
- Spacer kit 916-68043 and 916-68044 are required for middle (F-Body/GTO) and long (truck) spacing, respectively.
- No drilling or tapping is required. The bracket mounts to the factory drilled holes on the head and water pump.
- When installing the bracket, leave all bolts snug, but not tight, until alignment of the belt, belt length and bracket positioning have been verified.

### **TOOLS REQUIRED FOR INSTALLATION:**

6mm Allen Wrench, 8mm Allen Wrench.

## HOW TO INSTALL YOUR SIDE MOUNT ALTERNATOR BRACKET

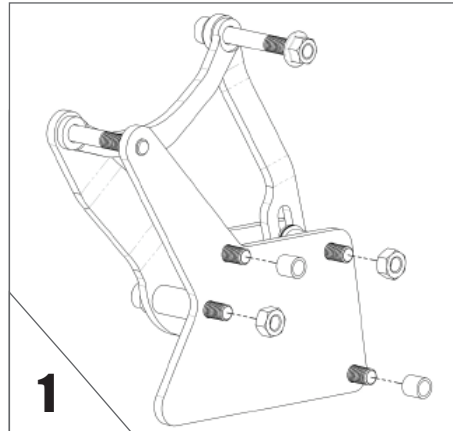

**REMOVE** the plastic sleeves and nuts from the bolts.  
**NOTE:** Please do not disassemble the bracket.

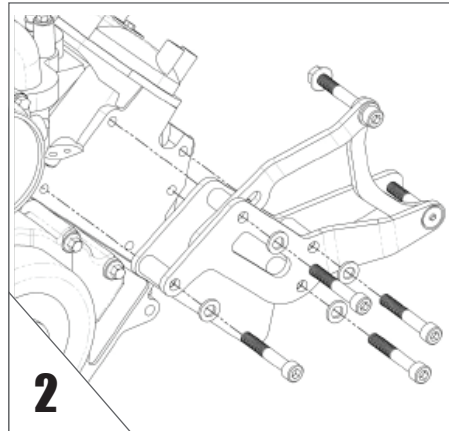

**BOLT** the bracket to the head and snug the bolts.

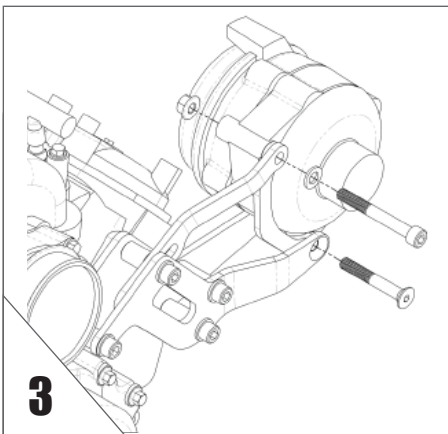

**INSTALL** the alternator.

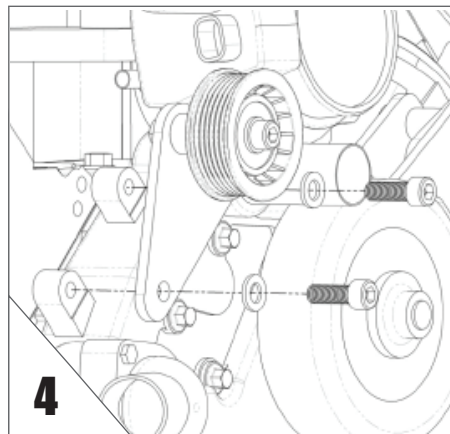

**BOLT** the pre-assembled tensioner assembly onto the passenger's side water pump.

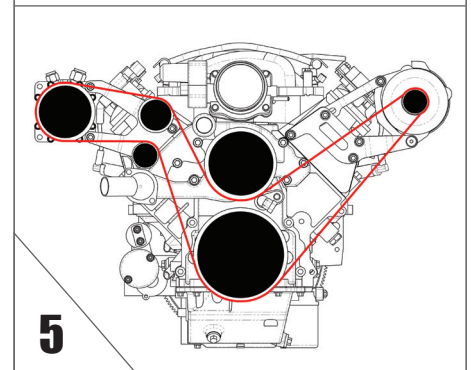
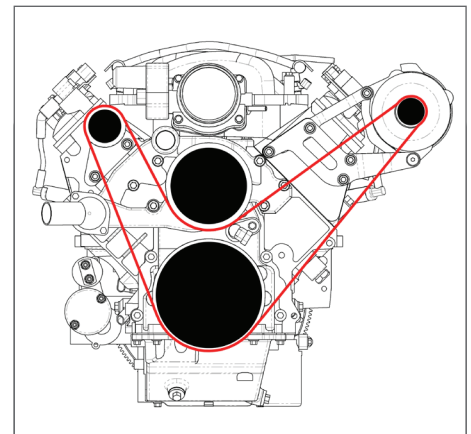

**ROUTE** the belt, adjust the tension and tighten the adjusting arm bolt on the alternator. Tighten all bolts now and check for proper alignment.

When installing the belt, loosen the adjusting arm to its shortest length and route the belt around all pulleys, slipping the belt over the smooth water pump pulley last.

## BELT SIZE SUGGESTIONS

- if used with **ALTERNATOR ONLY** - Gates **K060725** / Gates **K060730**
- if used with **AIR CONDITIONING** - Gates **K060891** / Gates **K060895**

## TO MEASURE BELT LENGTH:

After all brackets and accessories are installed, move the adjusting arm to its shortest position and route masking tape or string around the belt path. Mark or cut the tape/string to length and remove from the pulleys. You will need to convert belt length to millimeters if measured in inches (inches X 25.4 = mm). Go to any auto parts store and ask for a 6PK0000 belt with the "0000" being the length in millimeters. For example, if you measured 2430 mm the part number would be 6PK2430.