

This brake kit uses Speedway Motors metric calipers and 11" Speedway Motors rotors 4-1/2" or 4-3/4" Bolt Circle to Speedway Motors Modified 49-54 Chevy spindles.

**PLEASE READ YOUR INSTRUCTIONS COMPLETELY BEFORE  
STARTING YOUR INSTALLATION**

These brake kits will require spindle modifications if you are using OEM 49-54 GM spindles!

You can purchase spindles from Speedway Motors and eliminate having to find spindles or having yours machined. Or if you already have spindles you can send them to Speedway Motors and we will do all the machine work for you.

916-32100 NEW 49-54 Chevy modified forged steel spindles

916-32101 machining of your 49-54 Chevy spindles

		<b>Parts list</b>	
Index	Part number	Description	Qty
	91096267	Bracket kit	1
2	-91096267.3-L	Left bracket	1
2	-91096267.3-R	Right bracket	1
	-91096267.1	hardware kit	1
3	-HZ8HCSF-.44-1.50	7/16"-20 x 1-1/2" GR 8 hex bolts	4
4	-HZ8HCSF-.44-1.75	7/16"-20 x 1-3/4" GR 8 hex bolts	2
5	-HZ5NLNF-.44	7/16"-20 Nylock nut	6
6	-HZ5HNF-.38	3/8"-24 hex nut	2
7	-HB8BSCSF-.38-1.25	3/8"-24 x 1-1/4" Button head bolt	2
8	912TLM67048	Inner bearing cone	2
9	912S18565	Seal	2
10	91031070	Speedway brake rotor 4-3/4 BC	2
10	91031066	Speedway brake rotor 4-1/2" BC	2
11	912TLM11949	Outer bearing cone	2
	910616005	Spindle nut kit	1
12	-910615065	Spindle washer	2
13	-910618013	Spindle nut	2
14	-HZ0CP-.13-1.75	Cotter pin	2
15	91031071	Dust cap set	1
16	9193381	Brake pad set	1
17	91031045-L	IMCA Metric caliper left	1
17	91031045-R	IMCA Metric caliper right	1
18	8352300542	Slide bolt	4

**BRAKE INSTALLATION ALERT:** The selection and installation of brake components should only be done by personnel experienced in the proper installation and operation of braking systems. The installer must use his/her own discretion to determine the suitability of the brake components and brake kits for every particular application. Speedway Motors, Inc. makes no warranties, either expressed or implied, including any warranty of merchantability or fitness for a particular purpose, other than those contained in its current catalog or website with respect to the goods identified on the face of the invoice. There is no warranty expressed or implied as to whether the goods sold hereby will protect the purchaser or ultimate user of such goods from injury or death.

## Brake kit installation

1. The caliper brackets mount to the rear of the spindle and on the outboard side of the mounting flanges. The welded bosses on the brackets face to the inside. Install the caliper brackets #2 on to the spindle #1, using the 7/16"-20 x 1-1/2" GR 8 bolts #3 and the 7-16"-20 nylock nuts #5 on the upper mounting flanges. Use the longer 7/16"-20 x 1-3/4" GR 8 bolts # 4 and the 7-16"-20 nylock nuts #5 on the lower mounting flanges. **NOTE:** The lower bolt also bolts the steering arms to the spindle. Use the remaining 7/16"-20 x 1-1/2" GR 8 bolts and nylock nuts to bolt the front of the steering arm to the spindle. Torque the bolts to 80 ft. lbs.
2. Install the 3/8"-24 nut #6 and the 3/8"-24 button head bolt #7 into the threaded hole on the inside of the caliper bracket. This is your steering stop and will be adjusted in a later step.
3. Pack and install the inner bearings #8 with fresh disc brake bearing grease and install the grease seals #9. Seals must be installed straight; we recommend using a seal installation tool to install the seal.
4. Install the rotor #10 on to the spindle #1. Pack and install the outer bearing #11. Install the spindle washer #12 and spindle nut #13. Adjust the bearing preload as normal. Install the cotter pin #14 and dust cap #15.
5. Install the brake pads #16 into the calipers #17 and install the calipers on to the mounting brackets #2 with the bleeders pointing up. Only use the correct GM mounting bolts # 18. **NOTE: Some GM metric calipers have a small tab cast into the body that will interfere with the caliper brackets. This can be easily ground off for clearance.**
6. Adjust your steering stops. Turn your steering box from lock to lock and check for any interference with brake and suspension components. Adjust the 3/8" button head bolt #7 accordingly and tighten the 3/8" nut #6.
7. Install the brake lines making sure you check that the lines have clearance through the entire suspension travel, and turning radius. Bleed the system as normal.
8. Before operating the vehicle, test the brakes under controlled conditions. Make several stops in a safe area from low speeds and gradually work up to operating speeds.

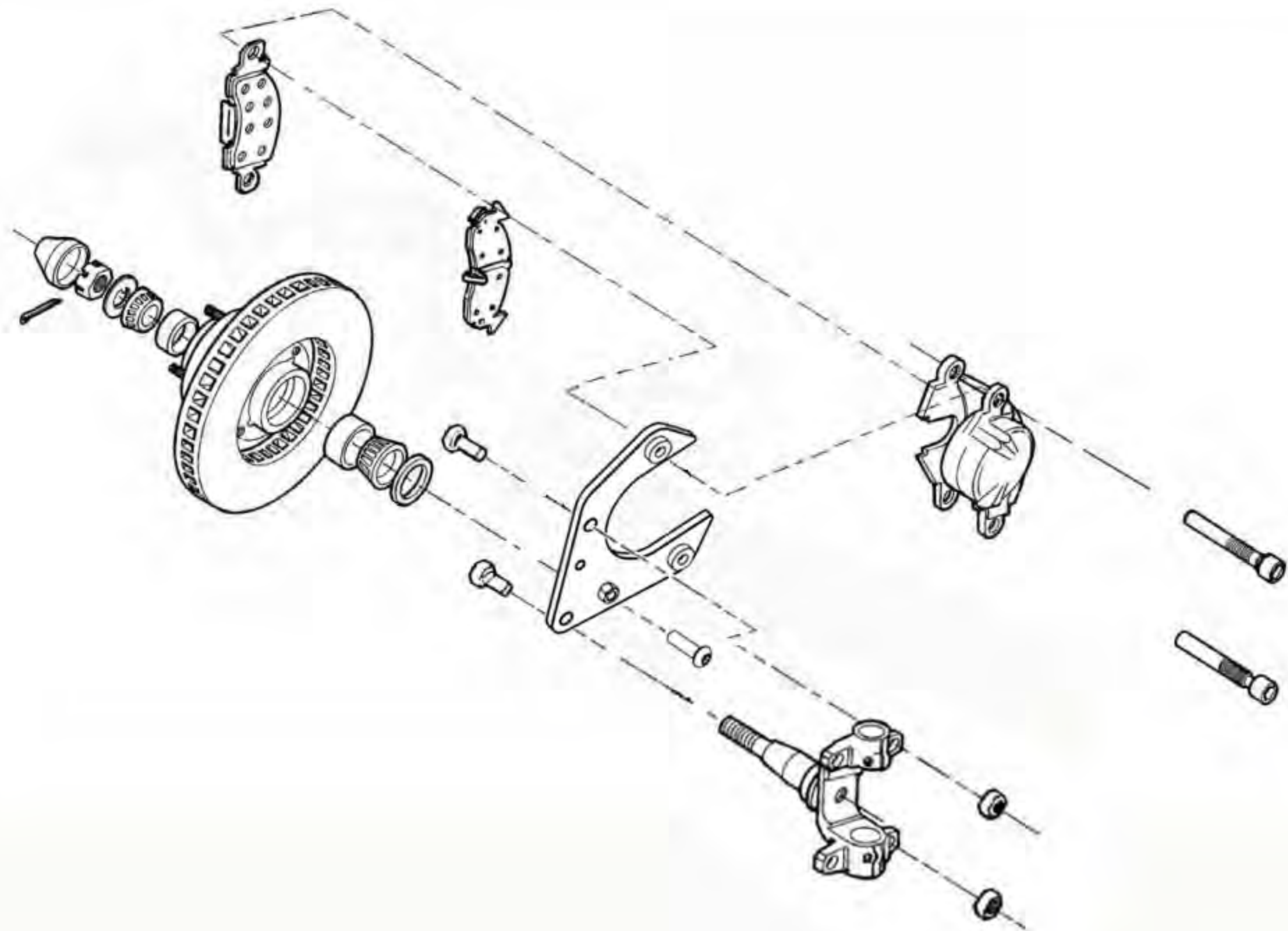

# IMPORTANT

## **DISCLAIMER**

In an effort to offer our customers the low prices, quick service and great value, Speedway Motors reserves the right to change suppliers, specifications, colors, prices, materials. Each of the previous items is subject to change without notice. Speedway is not responsible for any typographical errors or misinterpretations. Quantities are limited on some items.

## **WARRANTY DISCLAIMER**

The purchaser understands and recognizes that racing parts, specialized street rod equipment, and all parts and services sold by Speedway Motors, Inc. are exposed to many and varied conditions due to the manner in which they are installed and used. Speedway Motors, Inc. makes no warranties, either express or implied, including any warranty of merchantability or fitness for a particular purpose other than those contained in its current catalog with respect to the goods identified on the face of the invoice. There is no warranty expressed or implied as to whether the goods sold hereby will protect purchaser or ultimate user of such goods from injury or death. Speedway Motors assumes no liability after this period.

## **BRAKE INSTALLATION ALERT**

**The selection and installation of brake components should only be done by personnel experienced in the proper installation and operation of braking systems. The installer must use his/her own discretion to determine the suitability of all brake components and brake kits for every particular application. Speedway Motors, Inc. makes no warranties either expressed or implied including any warranty of merchantability or fitness for a particular purpose, other than those contained in its current catalog or website with respect to the goods identified on the face of the invoice. There is no warranty expressed or implied as to whether the goods sold hereby will protect the purchaser or ultimate user of such goods from injury or death.**

## **DAMAGE CLAIMS**

Always inspect your package upon delivery. Inspect all packages in the presence of the delivery driver. The driver must note any damage. Ask the driver the Carrier's procedures for handling damage claims. You must hold the original box, packing material and damaged merchandise for inspection or the carrier will not honor the claim. Notify Speedway Motors customer service department for instructions on returning damaged goods. Speedway is not responsible if no notification is given within 5 days of receipt.

## **SHORTAGES**

Always check the contents of your delivery to insure all the parts that you ordered were received. Please read the invoice. Double check all packing materials, small items may be wrapped inside with these products. Shortages may occur from damage to the box, so save all packing materials. Inspect the box for holes that would allow parts to fall out. If you are missing any item(s) be sure to check your invoice for back orders or canceled items before calling the customer service department. If Speedway has to split a shipment into multiple boxes, packages may be delivered on different days. You need to contact the customer service department within 5 days of delivery to assure the prompt replacement. Speedway Motors assumes no liability after this period.

## **REFUSALS**

All refused COD customers will be billed a 15% restocking charge plus freight to and from the destination! If you have questions please contact Speedway's customer service department.

## **WARRANTY CLAIMS**

If an item has a manufacturer's warranty as being free from defects we will exchange only. If the item has been used and you are requesting warranty work, this may take up to 30 days as warranty work is done by the manufacturer NOT Speedway Motors. If you have any questions please contact customer service.

## **RETURNS**

Speedway wants you to be satisfied with your purchase. If within 30 days after you receive your shipment you are not satisfied, you may return the item for refund or exchange. All exchanged or returned merchandise must be in original factory condition with no modifications or alterations. Returned merchandise must include all packaging materials, warranty cards, manuals, and accessories. If the items being returned need to be repackaged there will be a re-packing charge. Re-pack the item in a sturdy box and include a copy of your invoice and complete the form on the back of the invoice. You must ship orders back **PRE-PAID. WE DO NOT ACCEPT COD SHIPMENTS.** All exchanges need to have reshipping charges included. Items that are returned after 30 days are subject to 15% restocking charges. All fiberglass returned will have 15% restocking charge. No returns on electrical parts, video tapes, and books. Absolutely no returns on special order or close out merchandise.

## **FREE CATALOGS**

Speedway Motors offers FREE catalogs for Race, Street, Sprint and Midget, Sport Compact and Pedal Car Restoration.

Some items are not legal for sale or use in California on pollution controlled motor vehicles. These items are legal in California for racing vehicles only which may never be used upon a highway.

**Speedway Motors Inc.,  
P.O. Box 81906 Lincoln, NE 68501  
800.979.0122 SpeedwayMotors.com**

