

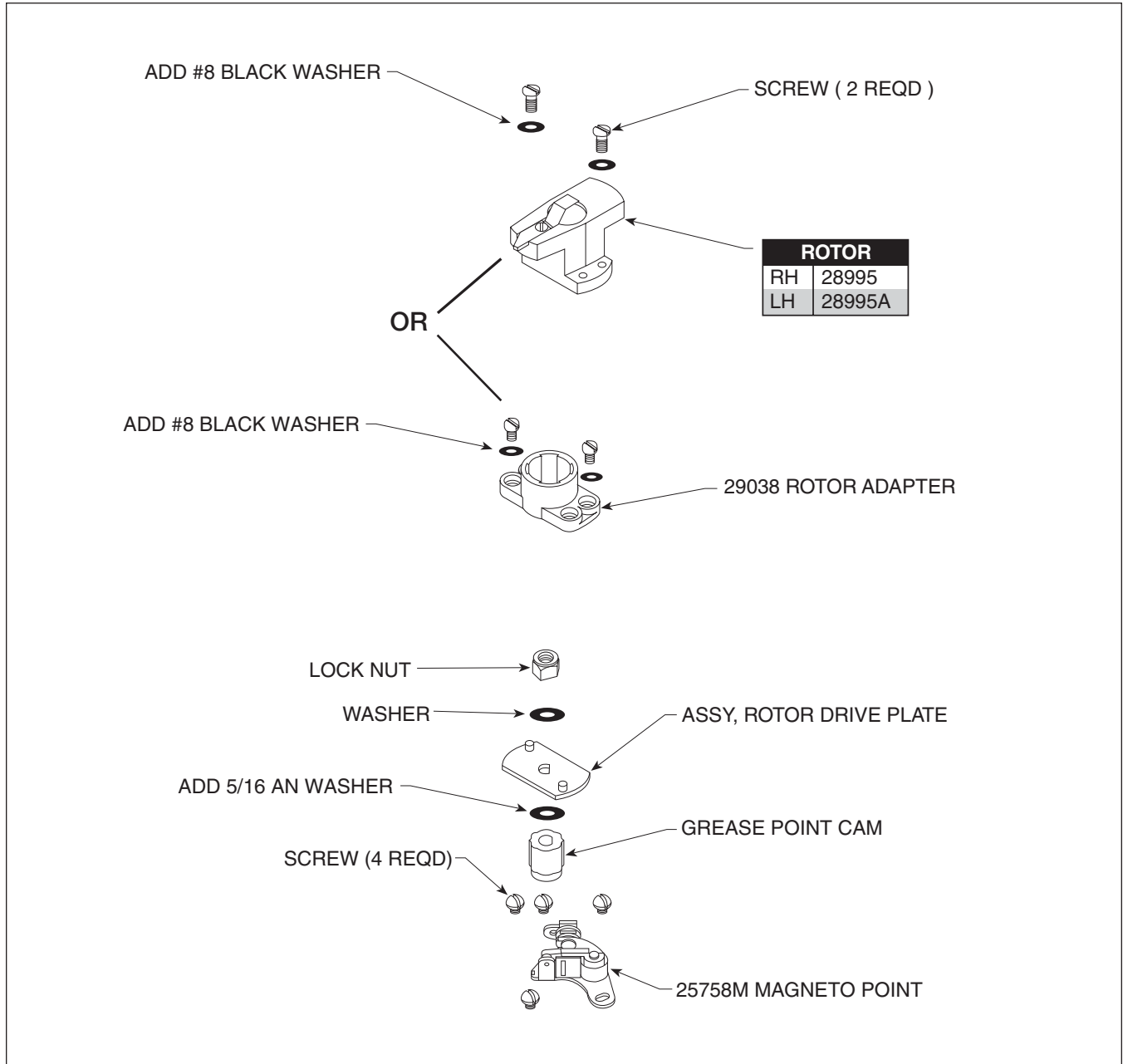

INSTALLATION INSTRUCTIONS

25758M MAGNETO POINTS



Hold 4 pin driver on bottom of magneto head and remove lock nut, as seen on diagram. Now remove lock washer, rotor drive plate and grease point cam. Next, install 5/16 AN washer, followed by drive plate, lock washer and lock nut. Install #8 black washers on rotor screws. Be sure to adjust point to .016". Double check this gap after about 30 minutes of running time.



MALLORY IS A DIVISION OF THE MR. GASKET PERFORMANCE GROUP
10601 MEMPHIS AVE. #12, CLEVELAND, OH 44144
216.688.8300 FAX 216.688.8306

FORM 1646
03/05
Made in U.S.A.
Printed in U.S.A.