

INSTRUCTION

350-800 G-Comp Unser Edition Rear Suspension:

70-81 Chevy Camaro

©Speedway Motors, Inc. 2017

Kit Contents:

- | | |
|-----------------|----------------------------------|
| • 350700.1 | G-Comp Main Crossmember |
| • 350800.1 | G-Comp 58" Floater Rear Housing |
| • 350800.2 | G-Comp Upper Crossmember |
| • 350402 | G-Comp Rear Sway Bar |
| • 350400.1 | Chevy II Unser Rear Arms (pair) |
| • 350800.4 | Hardware Kit Unser Rear – Camaro |
| • 350029.2 | Floater Components |
| • 350800.3 | G-Comp Rear Watts Link Package |
| • 65579031-27.5 | 27.5" Double Splined Axle – 31 |
| • 65579031-32 | 32" Double Splined Axle – 31 |

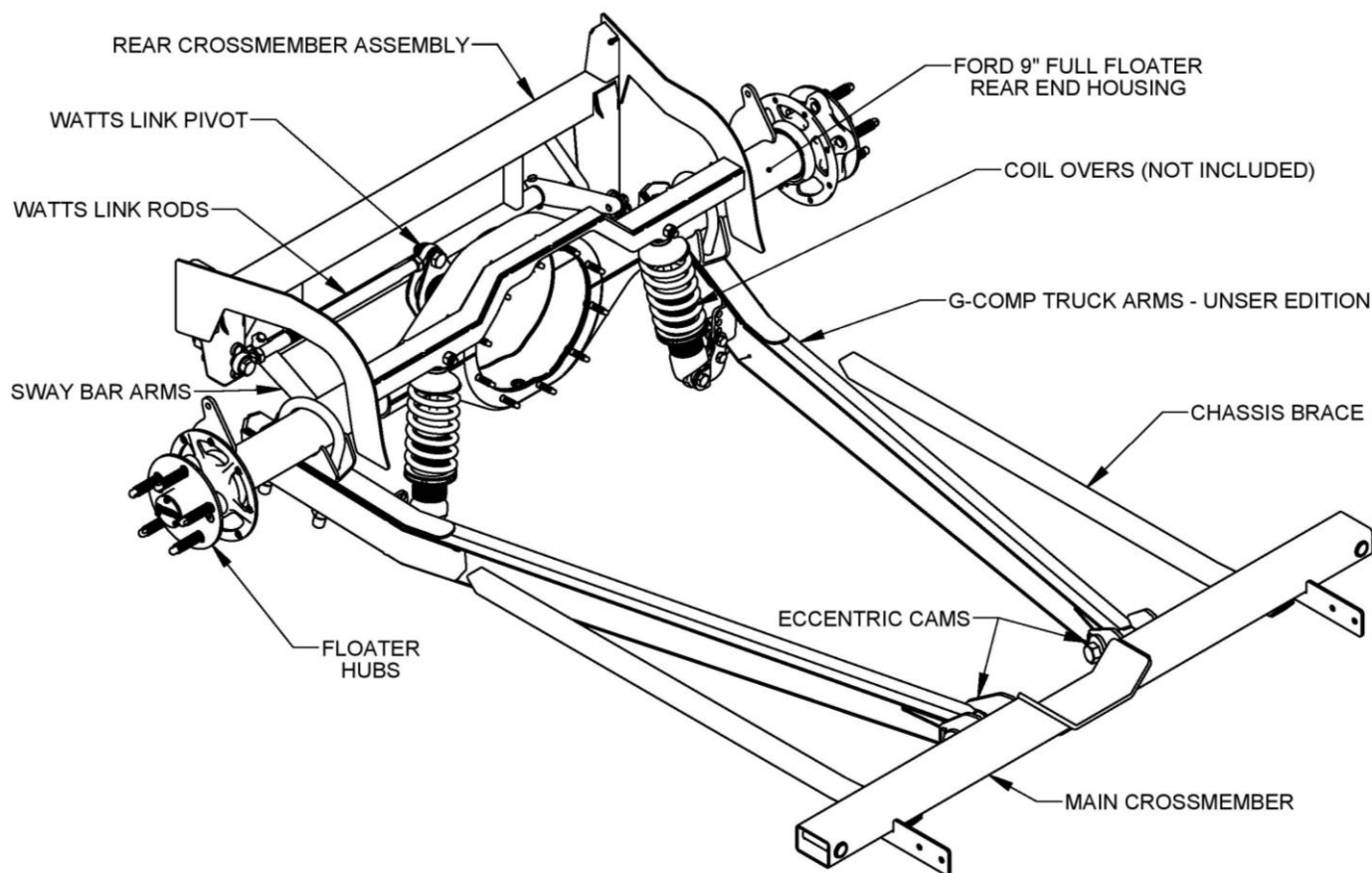

Note: This kit will require modifications to the rear floor pans.

1. **Remove Rear Suspension:** Raise the car and support it with jack stands or a lift. Remove; the exhaust, drive shaft, rear end, and all rear suspension components including the rubber bump stops. Disconnect fuel lines and remove fuel tank. Remove fuel lines, brake lines, and E-brake cables from bottom of car. These can be re-routed through the holes in the main crossmember after installation.
2. **Prep for Welding:** Raise the main crossmember into its approximate position and mark all areas that will be welded. These areas should be ground down to bare metal to provide the proper conditions for welding. (Any carpet or padding installed on back side of weld areas should be removed at this time.) The main crossmember should be centered in the car and set between the rockers, just behind the factory crossmember. The chassis braces will weld to the main crossmember as well as the floor and rear factory rear frame rails. There should be roughly 32 1/4" between the chassis braces.

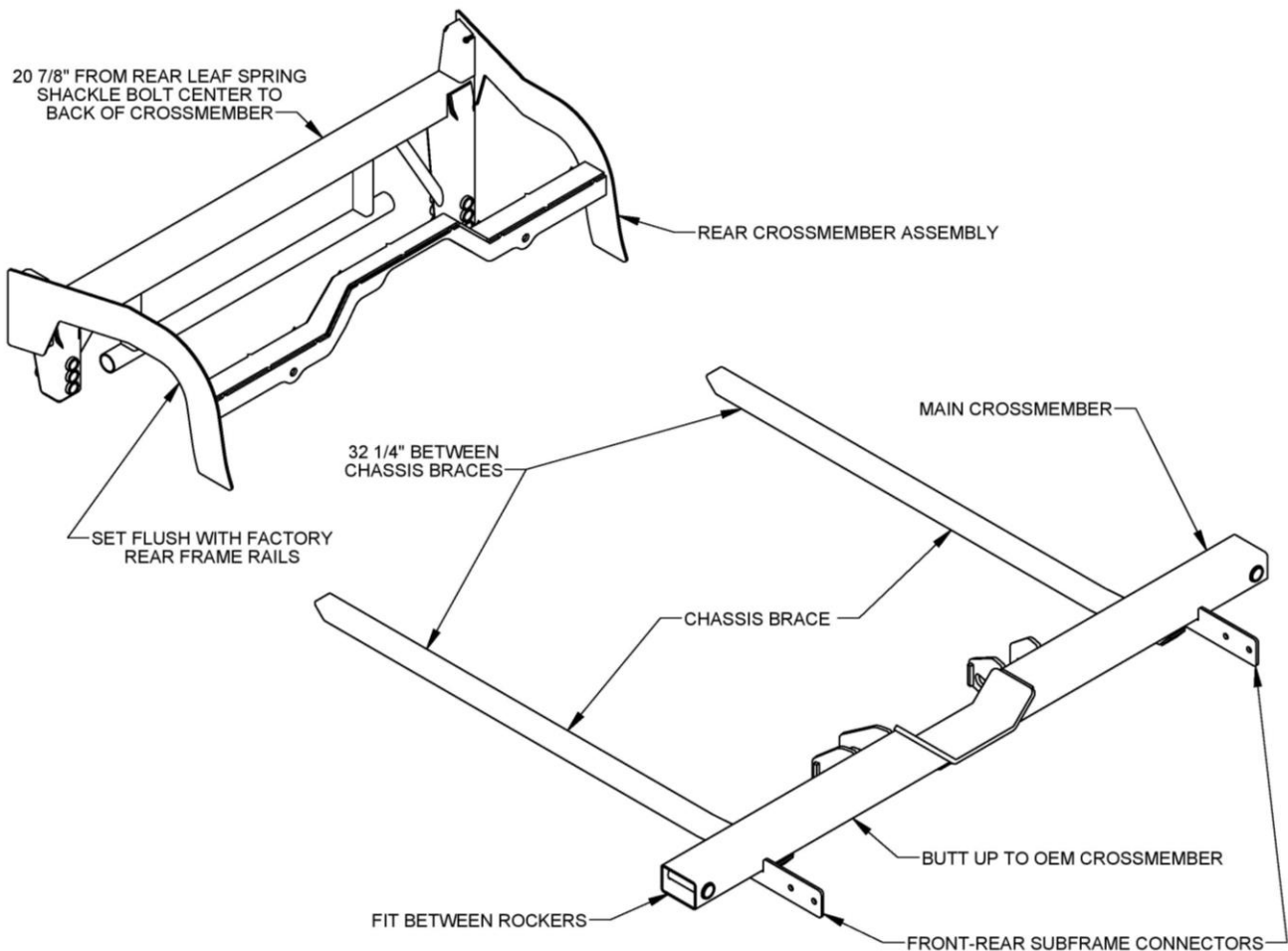

3. **Repeat** step two with the rear crossmember assembly. Depending on the car, minor trimming/fitting may be required. The rear crossmember assembly will sit between the factory rear frame rails and sit against the floor of the car. The rails should be flush with the outer plates of the assembly and the rear crossmember should be 20 7/8" from the factory rear leaf spring shackle bolts.

4. **Tack-Weld Crossmembers:** Once all areas that will be welded have been prepped and cleaned – the main and rear crossmembers can be tack welded into place. (Some grinding and trimming may be necessary to provide proper fit up.) **Note:** Do not fully weld the crossmembers at this time! Only weld enough to securely hold the parts in place during mock up. Hint: Weld in places that can be easily accessed with a grinder in case it becomes necessary to move or adjust the parts.
5. **Assemble Truck Arms and Rear End Housing:** Install the truck arms onto the front cross member using the supplied 3/4"-16 X 5-1/2" grade 8 cam bolts and spacers. **NOTE:** Install the cam bolts in the center of adjustment as shown. The flat side of the bolt should be facing upwards. Tighten the nut until it just touches the cam spacer, but do not fully tighten it yet. Raise the rear end housing into its approximate location. Using the supplied U-bolts and nuts, attach the truck arms to the rear end housing. The U-bolts only need to be snug at this time. There is no need to fully tighten them yet. With the rear end housing connected to the truck arms, and raised up to ride height, you can now tighten the cam bolts.

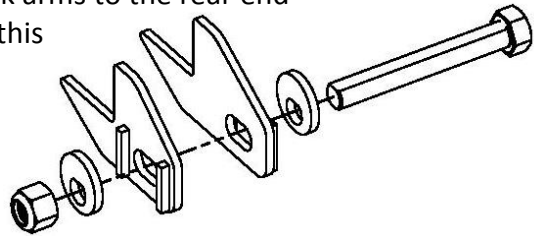

6. **Install the Watts Link Pivot:** Once the truck arms have been connected to the rear end housing, it's time to mock up the watts link. Start by installing the center pivot to the rear end housing. Use the supplied 3/4-16 x 3" grade 5 bolt and washer to attach the pivot to the housing as shown. For initial mock up, use the second hole from the top on the rear end housing.

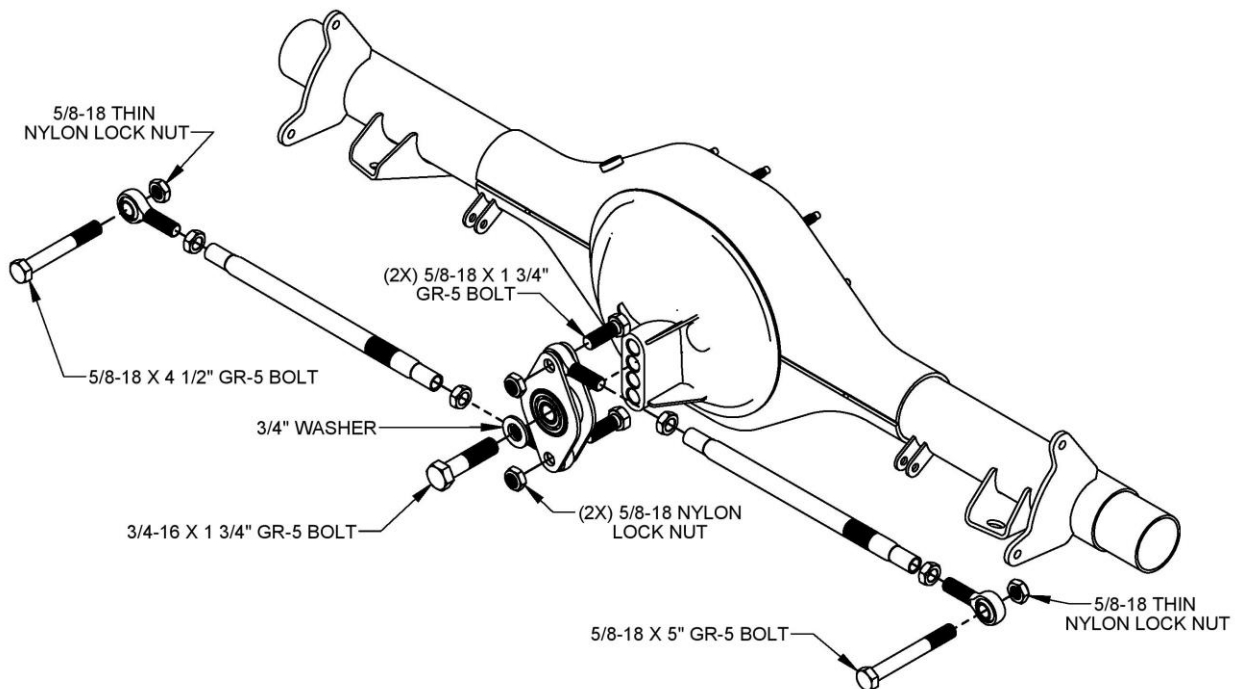

7. **Install the Link Rods:** Start by centering the rear end housing in the car. Then install the lower/drivers side link rod first, as shown. Once the link is installed, adjust the length of the link by spinning the tube until the pivot is at a 90° angle with the ground. **Note:** The link should be level with the ground at this time. The rear end housing may need to be raised or lowered to achieve this. Once the link is level with the ground, and the pivot is at a 90° angle, the jam nuts can be tightened. With the first link installed, it is now time to install the upper/passenger side link. Be sure to keep the rod ends adjusted evenly on either side of the tube. **Note:** The center pivot bolts must be installed as shown, with the nut towards the rear of the car. Installing them in the other direction may result in interference between the bolt and the rear end housing. With the links adjusted properly and the rear end at ride height, both links should be parallel to the ground and the pivot should be at a 90° angle.
8. **Check Alignment and Clearances:** On most cars, a portion of the rear floor will need to be raised to clear the truck arms under full compression. The affected area is the rear seat floor and foot pan are. **Note:** the floor should be raised or notched enough to have adequate clearance at full compression. Cycle the suspension completely through its travel and check for any clearance issues with the trunk, floor, etc...
9. **Install connecting braces (Optional):** This kit includes connecting braces that tie the front and rear subframes together. These can be used to stiffen the chassis when installing front and rear G-Comp suspension kits on the same vehicle. Install these after the front end has been installed and aligned. Hold the braces in place as shown and use the brace as a template to mark the front subframe. Drill 3/8" holes in the front subframe in the marked locations. Now bolt the connecting brace to the front subframe. Weld the connecting braces to the main crossmember.

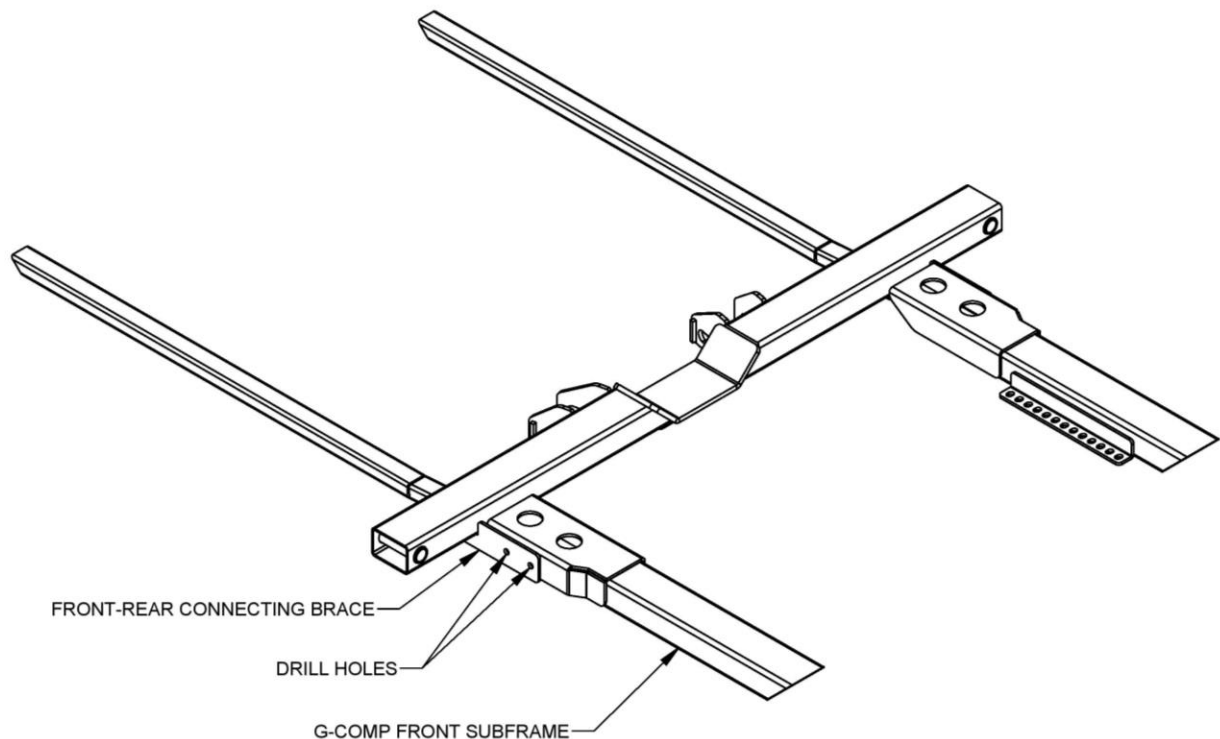

10. **Weld:** If there are no clearance issues, it is time to fully weld in the crossmembers. Start by removing the rear end, watts link, and truck arms from the car. Take note which link rod goes on which side. Fully weld the cross members and chassis braces to the car.
NOTE: It is a good idea to only weld a small bead at a time, then move to a new area and allow the first area to cool completely before welding further in that area. This will greatly reduce the risk of warping.

11. **Final-Assembly:** Once all of the welding is complete, the suspension can be assembled.

12. Now is a good time to fully assemble the rear end by installing gears, hubs, axles, and brakes. **Note:** This can also be done after installing the housing into the car. Assemble the hub as shown below. Be sure to pack the wheel bearings with high quality grease. **Do not** over torque the axle nut! The hub should spin freely with zero endplay. To achieve this, assemble the hub as shown. Tighten the axle nut and spin the hub a dozen or so rotations.

Now back the axle nut off 2 full turns. Then tighten the axle nut until it just starts to get snug. At this point the hub

should spin freely with little to no resistance, and there should be no endplay in the bearing. Bend the tab on the lock ring into the groove on the axle nut. This will prevent the axle nut from loosening.

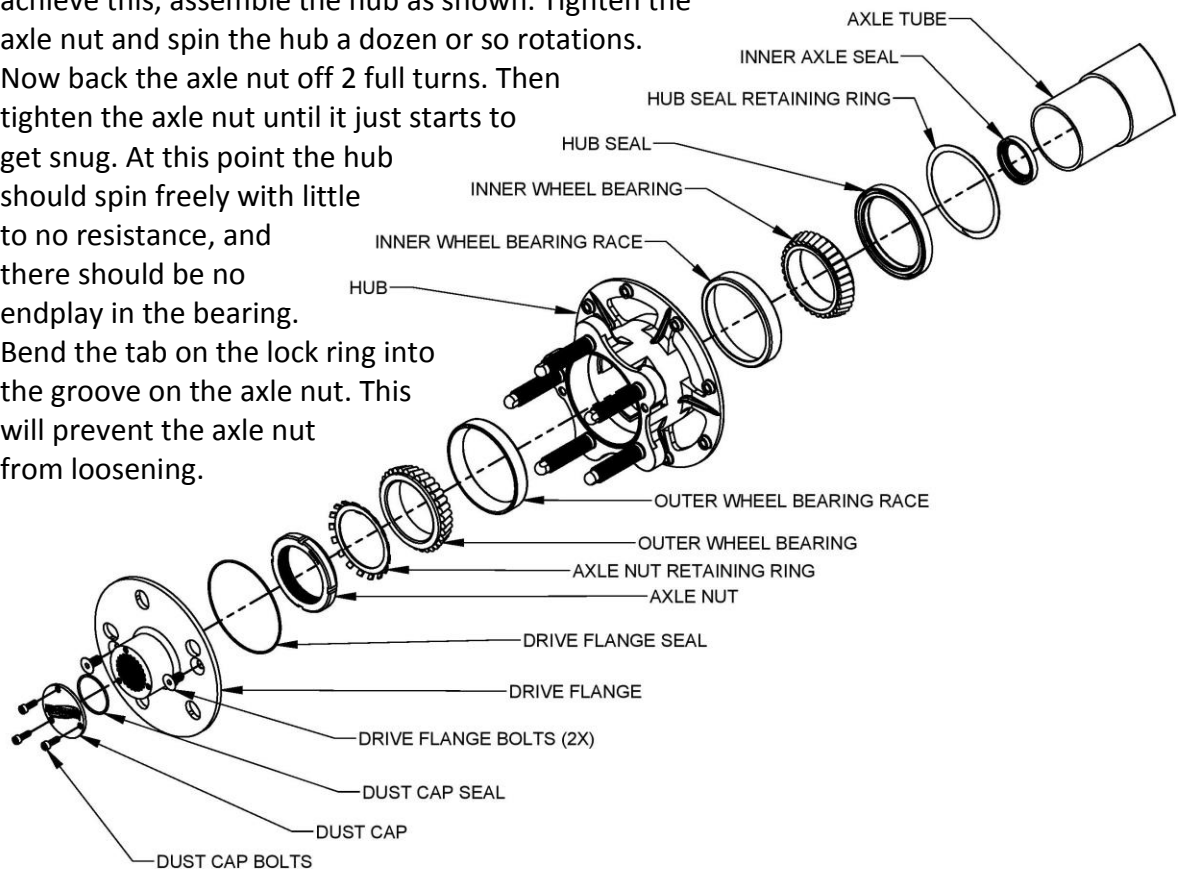

13. **Secure the truck arms** to the chassis brace using the cam bolts and cam spacers as shown in step 5. Torque the nuts to 120 ft-lbs.

14. **Raise the complete rear end into position.** Attach the rear end to the truck arms using the supplied u-bolts, washers, and nuts. Torque the nuts to 220 ft-lbs.

15. **Install the Watts link** center pivot as described in step 6 and torque the 3/4-16 x 3" GR-5 bolt to 125 ft-lbs.

16. **Install the link rods** back into their previous locations. Tighten all four 5/8-18 lock nuts to 85 ft-lbs.

17. **Install the sway bar** as shown. Press the sway bar bushings into the sway bar housing on the crossmember by lightly tapping them into place with a rubber mallet (be sure the bushings are going in straight). With the bushings in place, slide the sway bar into the housing. Slide one of the torsion arms onto the splined portion of the sway bar so it sits flush with the end of the bar. Install the 5/16-24 x 2" bolt and lock nut onto the arm and tighten to 20 ft-lbs. Install one of the male rod ends onto the outside of the arm using a 3/8-16 x 1 1/4" GR-5 bolt. Now thread the jam nut and female rod end onto the male rod end leaving roughly 1/4" of threads showing. Attach the female rod end to the rear end housing using 3/8-16 x 1 1/4" bolt and lock nut. Torque both bolts to 35 ft-lbs.

Assemble the opposite side in the same manner. The arms will need to be "clocked" about 45° relative to one another, with the passenger side at a downward slope and the driver side at an upward slope. **Note:** Once the vehicle is fully assembled and sitting on level ground, it is a good idea to disconnect one side of the sway bar links and adjust the length of the rod ends until there is no pre-load and the holes line up perfectly.

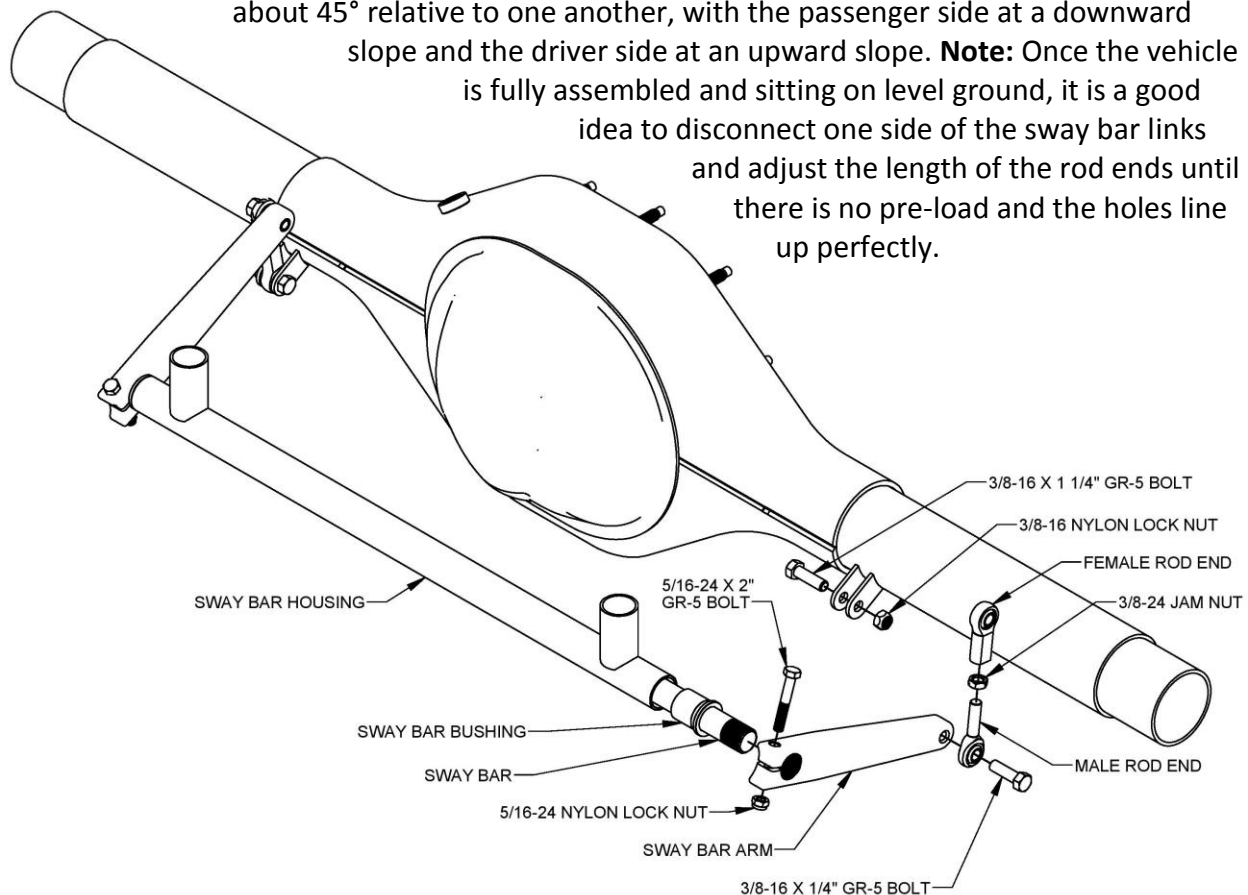

18. **Install the brakes** as per the instructions included with your brake kit. **Note:** For recommended part numbers please visit our website or contact one of our tech experts.

19. Install the coil-over shocks. The

Unser Edition G-Comp rear suspension features an adjustable lower shock mount. To install the shock, first use the two 7/16"-20 x 1 1/4" grade 5 bolts and nylon lock nuts to install the shock brackets to the shock mount on the truck arm. (Torque these to 42 ft-lbs). Then use a 1/2"-13 x 2 1/4" grade 5 bolt and nylon lock nut to secure the lower end of the shock to the truck arm as shown. The remaining 1/2"-13 x 3" grade 5 bolts and nylon lock nuts are used along with two 5/16" spacers to install the top of the shocks into the rear crossmember. Torque both shock bolts to 64 ft-lbs. **Note:** This kit is design to use 4" stroke shocks with a compressed length of 10"-11" and an extended length of 14"-15". Shock ends should be 1/2" bearings with a mounting width of 1". For recommended part numbers please visit our website or contact one of our tech experts.

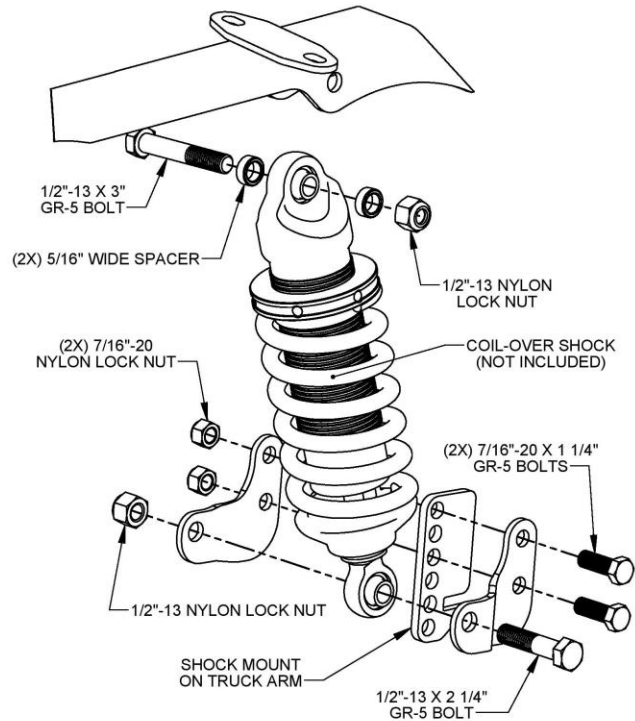

20. Re-install; drive shaft, fuel tank, fuel lines, brake lines, exhaust, etc... Bleed the brakes. Fill the rear end with fluid. Install wheels and tires.

21. Alignment:

- Lower the car onto the ground and check for desired ride height. Adjust ride height if necessary by raising the car and spinning the adjusting collar on the coil-over.
- Once the ride height has been set, lower the car onto the ground and make sure the rear end is centered in the car body. Adjust the watts link rods if necessary. For optimum handling and performance, both rods should be parallel with the ground and the center pivot should be at a 90° angle. This kit provides multiple mounting locations for the watts link to allow for different ride heights.
- Now that the ride height is set and the rear end is centered perfectly in the car, the rear end can be aligned by adjusting the cam bolts on the front of the truck arms. **NOTE:** This is difficult to do accurately and a professional alignment is recommended. This method will get you close enough to drive the car to an alignment shop.

IMPORTANT

DISCLAIMER

In an effort to offer our customers the low prices, quick service and great value, Speedway Motors reserves the right to change suppliers, specifications, colors, prices, materials. Each of the previous items is subject to change without notice. Speedway is not responsible for any typographical errors or misinterpretations. Quantities are limited on some items.

WARRANTY DISCLAIMER

The purchaser understands and recognizes that racing parts, specialized street rod equipment, and all parts and services sold by Speedway Motors, Inc. are exposed to many and varied conditions due to the manner in which they are installed and used. Speedway Motors, Inc. makes no warranties, either express or implied, including any warranty of merchantability or fitness for a particular purpose other than those contained in its current catalog with respect to the goods identified on the face of the invoice. There is no warranty expressed or implied as to whether the goods sold hereby will protect purchaser or ultimate user of such goods from injury or death. Speedway Motors assumes no liability after this period.

BRAKE INSTALLATION ALERT

The selection and installation of brake components should only be done by personnel experienced in the proper installation and operation of braking systems. The installer must use his/her own discretion to determine the suitability of all brake components and brake kits for every particular application. Speedway Motors, Inc. makes no warranties either expressed or implied including any warranty of merchantability or fitness for a particular purpose, other than those contained in its current catalog or website with respect to the goods identified on the face of the invoice. There is no warranty expressed or implied as to whether the goods sold hereby will protect the purchaser or ultimate user of such goods from injury or death.

DAMAGE CLAIMS

Always inspect your package upon delivery. Inspect all packages in the presence of the delivery driver. The driver must note any damage. Ask the driver the Carrier's procedures for handling damage claims. You must hold the original box, packing material and damaged merchandise for inspection or the carrier will not honor the claim. Notify Speedway Motors customer service department for instructions on returning damaged goods. Speedway is not responsible if no notification is given within 5 days of receipt.

SHORTAGES

Always check the contents of your delivery to insure all the parts that you ordered were received. Please read the invoice. Double check all packing materials, small items may be wrapped inside with these products. Shortages may occur from damage to the box, so save all packing materials. Inspect the box for holes that would allow parts to fall out. If you are missing any item(s) be sure to check your invoice for back orders or canceled items before calling the customer service department. If Speedway has to split a shipment into multiple boxes, packages may be delivered on different days. You need to contact the customer service department within 5 days of delivery to assure the prompt replacement. Speedway Motors assumes no liability after this period.

REFUSALS

All refused COD customers will be billed a 15% restocking charge plus freight to and from the destination! If you have questions please contact Speedway's customer service department.

WARRANTY CLAIMS

If an item has a manufacturer's warranty as being free from defects we will exchange only. If the item has been used and you are requesting warranty work, this may take up to 30 days as warranty work is done by the manufacturer NOT Speedway Motors. If you have any questions please contact customer service.

RETURNS

Speedway wants you to be satisfied with your purchase. If within 30 days after you receive your shipment you are not satisfied, you may return the item for refund or exchange. All exchanged or returned merchandise must be in original factory condition with no modifications or alterations. Returned merchandise must include all packaging materials, warranty cards, manuals, and accessories. If the items being returned need to be repackaged there will be a re-packing charge. Re-pack the item in a sturdy box and include a copy of your invoice and complete the form on the back of the invoice. You must ship orders back **PRE-PAID. WE DO NOT ACCEPT COD SHIPMENTS.** All exchanges need to have reshipping charges included. Items that are returned after 30 days are subject to 15% restocking charges. All fiberglass returned will have 15% restocking charge. No returns on electrical parts, video tapes, and books. Absolutely no returns on special order or close out merchandise.

FREE CATALOGS

Speedway Motors offers FREE catalogs for Race, Street, Sprint and Midget, Sport Compact and Pedal Car Restoration.

Some items are not legal for sale or use in California on pollution controlled motor vehicles. These items are legal in California for racing vehicles only which may never be used upon a highway.

**Speedway Motors Inc.,
P.O. Box 81906 Lincoln, NE 68501
800.979.0122 SpeedwayMotors.com**



© , Speedway Motors, Inc.