

AFCO Spindle Lock Nut Instructions

Part Number 10202 & 10200

1. Remove existing nuts and lock tab washers.
2. Make sure spindle thread is in good condition. Clean threads as necessary so that nut will spin on and off freely.
3. Because spindle snout manufacturers use varying width and depth keyways, the tang of both the thrust washer (1) and locking washer (3) may have to be filed slightly so it does not hang up on the sides or the bottom of the keyway.

Make sure washers will slide on and off freely.

4. Install thrust washer (1) against outer bearing.
5. Install nut (2) to desired bearing preload.
6. Install lock washer (3) if holes will not line up with holes in nut – flip washer over.
7. Install and tighten set screws.

Make sure lock washer tang (3) is engaged in keyway.

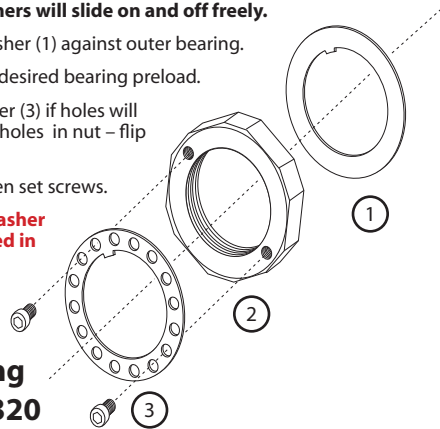

AFCO Racing
800-632-2320

AFCO Spindle Lock Nut Instructions

Part Number 10202 & 10200

1. Remove existing nuts and lock tab washers.
2. Make sure spindle thread is in good condition. Clean threads as necessary so that nut will spin on and off freely.
3. Because spindle snout manufacturers use varying width and depth keyways, the tang of both the thrust washer (1) and locking washer (3) may have to be filed slightly so it does not hang up on the sides or the bottom of the keyway.

Make sure washers will slide on and off freely.

4. Install thrust washer (1) against outer bearing.
5. Install nut (2) to desired bearing preload.
6. Install lock washer (3) if holes will not line up with holes in nut – flip washer over.
7. Install and tighten set screws.

Make sure lock washer tang (3) is engaged in keyway.

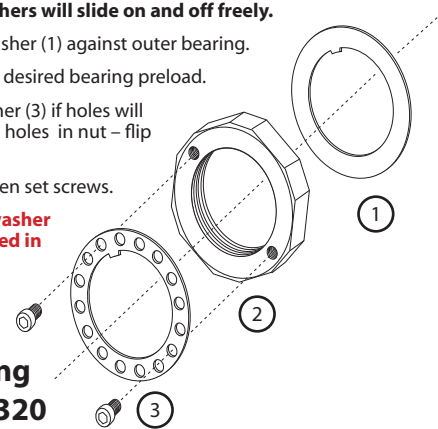

AFCO Racing
800-632-2320

AFCO Spindle Lock Nut Instructions

Part Number 10202 & 10200

1. Remove existing nuts and lock tab washers.
2. Make sure spindle thread is in good condition. Clean threads as necessary so that nut will spin on and off freely.
3. Because spindle snout manufacturers use varying width and depth keyways, the tang of both the thrust washer (1) and locking washer (3) may have to be filed slightly so it does not hang up on the sides or the bottom of the keyway.

Make sure washers will slide on and off freely.

4. Install thrust washer (1) against outer bearing.
5. Install nut (2) to desired bearing preload.
6. Install lock washer (3) if holes will not line up with holes in nut – flip washer over.
7. Install and tighten set screws.

Make sure lock washer tang (3) is engaged in keyway.

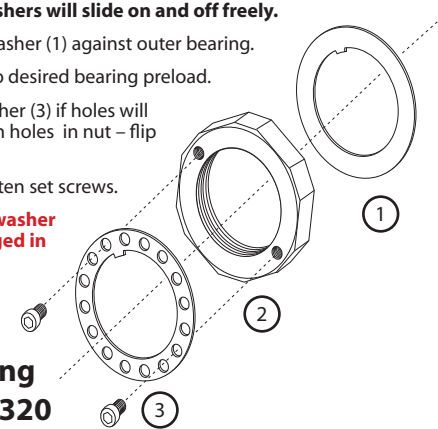

AFCO Racing
800-632-2320

AFCO Spindle Lock Nut Instructions

Part Number 10202 & 10200

1. Remove existing nuts and lock tab washers.
2. Make sure spindle thread is in good condition. Clean threads as necessary so that nut will spin on and off freely.
3. Because spindle snout manufacturers use varying width and depth keyways, the tang of both the thrust washer (1) and locking washer (3) may have to be filed slightly so it does not hang up on the sides or the bottom of the keyway.

Make sure washers will slide on and off freely.

4. Install thrust washer (1) against outer bearing.
5. Install nut (2) to desired bearing preload.
6. Install lock washer (3) if holes will not line up with holes in nut – flip washer over.
7. Install and tighten set screws.

Make sure lock washer tang (3) is engaged in keyway.

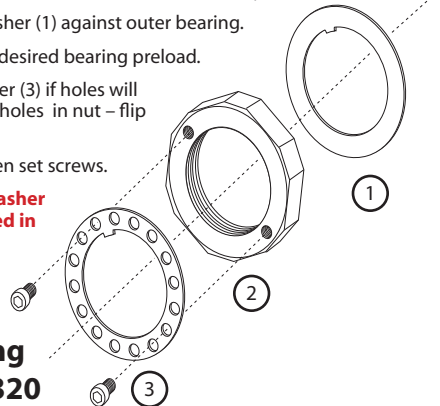

AFCO Racing
800-632-2320

AFCO Spindle Lock Nut Instructions

Part Number 10202 & 10200

1. Remove existing nuts and lock tab washers.
2. Make sure spindle thread is in good condition. Clean threads as necessary so that nut will spin on and off freely.
3. Because spindle snout manufacturers use varying width and depth keyways, the tang of both the thrust washer (1) and locking washer (3) may have to be filed slightly so it does not hang up on the sides or the bottom of the keyway.

Make sure washers will slide on and off freely.

4. Install thrust washer (1) against outer bearing.
5. Install nut (2) to desired bearing preload.
6. Install lock washer (3) if holes will not line up with holes in nut – flip washer over.
7. Install and tighten set screws.

Make sure lock washer tang (3) is engaged in keyway.

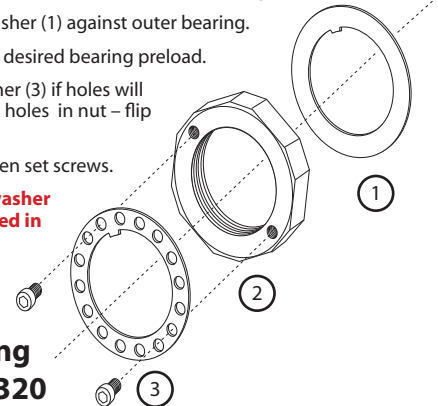

AFCO Racing
800-632-2320

AFCO Spindle Lock Nut Instructions

Part Number 10202 & 10200

1. Remove existing nuts and lock tab washers.
2. Make sure spindle thread is in good condition. Clean threads as necessary so that nut will spin on and off freely.
3. Because spindle snout manufacturers use varying width and depth keyways, the tang of both the thrust washer (1) and locking washer (3) may have to be filed slightly so it does not hang up on the sides or the bottom of the keyway.

Make sure washers will slide on and off freely.

4. Install thrust washer (1) against outer bearing.
5. Install nut (2) to desired bearing preload.
6. Install lock washer (3) if holes will not line up with holes in nut – flip washer over.
7. Install and tighten set screws.

Make sure lock washer tang (3) is engaged in keyway.

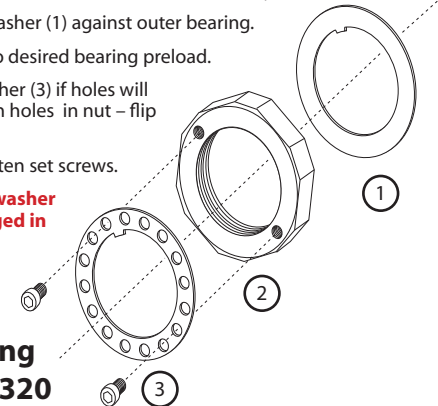

AFCO Racing
800-632-2320